

SUN VALLEY BRONZE





Fine Solid Bronze
Architectural Hardware

OUR STORY

Bob Commons, owner and founder of Sun Valley Bronze, has had a long career in fine home building as a skilled craftsman. During his years as a carpenter, Bob realized there was a deficiency in one aspect of the custom homes he was building. Local builders were exhausting great efforts on the details and finishes of finely crafted homes, but the hardware available had gone the way of mass production, lacking the handcrafted quality that was represented in other areas of the custom home construction process.

Recognizing this void in the industry motivated Bob to begin carving patterns and experimenting with casting in his garage in Hailey, Idaho. He acquired a used furnace from a local high school shop and began melting all manner of reclaimed objects. He realized early on that only the highest grade art bronze could yield the quality he was looking for. With over 40 years of experience in the trades, he is still passionate about bringing the highest quality craftsmanship to his work.

Sun Valley Bronze has grown from its humble beginnings in Bob's garage to a successful business that uses the latest in casting, machining and software technologies. Although the technology has advanced over time, the guiding philosophy of maintaining handcrafted quality lives on in the heart of this family owned and operated company. Every piece of Sun Valley Bronze hardware is made to order, created, and assembled by hand in our studios and foundry in the beautiful mountains of Idaho.





CONSIDERING THE FUTURE

How we are working to minimize our impact

At Sun Valley Bronze, we are committed to minimizing our impact on the environment.

From the office to the workshop, recycling has long been an important part of our philosophy. All of the bronze scrap created as a result of our machining and casting operations is reclaimed and reconstituted into art grade bronze, which we reuse in ingot form. The sand casting process we employ is water based and completely recycled from one casting to the next.

Sun Valley Bronze hardware is 100% locally manufactured. No aspect of our process is outsourced overseas. With a growing awareness of our carbon footprint, another important green consideration is how far our product must travel before it reaches the consumer.

Even the majority of our manufacturing equipment is made in the USA. Not only is this great for keeping local manufacturing alive, it means we exhaust fewer resources and emit less waste as we expand our business.

We look forward to improving our efforts as we grow. Sun Valley Bronze has always strived to provide a healthy work environment for our employees. We are equally committed to minimizing our impact on the environment for future generations as we continue to evolve as a company.



GENERAL INFORMATION

OUR STORY	1
CONSIDERING THE FUTURE	3
TABLE OF CONTENTS	4
PATINAS	6

KNOBS, LEVERS & RING PULLS 8

COLLECTIONS

ORIGINAL BEVEL EDGE COLLECTION	16
ARCH COLLECTION	18
CONTEMPORARY COLLECTION	20
RIDGE COLLECTION	22
HAMPTON COLLECTION	24
TRELLIS COLLECTION	25
DECO COLLECTION	26
FLEUR DE LIS COLLECTION	27
CORRUGATED COLLECTION WITH BAND	28
CORRUGATED COLLECTION	29
BANDBOX COLLECTION	30
OVAL COLLECTION & ASPEN LEAF ENTRY SET	31

THE ART OF BRONZE 32

DOOR HARDWARE

MULTI-POINT HARDWARE	36
SLIDER HARDWARE	38
DEADBOLTS	40
MORTISE BOLTS	42
SCREEN DOOR HARDWARE	43
POCKET DOOR HARDWARE	44

GATE HARDWARE 47

HINGES

DOOR HINGES	50
DECORATIVE STRAP HINGES	52
ACTIVE STRAP HINGES	53



DOOR ACCESSORIES

CREMONE BOLTS	55
SURFACE & CANE BOLTS	56
GRIP HANDLES	58
PUSH PLATES	60
DOOR KNOCKERS	61
DOOR BELLS	62
DOOR STOPS	65
CLAVOS & KICK PLATES	66
MAIL SLOTS & GRILL	67

WINDOW HARDWARE

KITCHEN & BATH

KITCHEN & BATH ACCESSORIES	70
TILES	73
SINKS & FAUCETS	74

ACCESSORIES

COAT HOOKS	76
CLOSET COLLECTION	77
GATE CLOSER & HOOKS & EYES	78
HOUSE NUMBERS	79
ELECTRICAL COVERS, HANDRAIL BRACKETS & GAS KEYS	80
BELLS & TACK ROOM ACCESSORIES	81

CABINET HARDWARE

CUSTOM HARDWARE

NEW COLLECTIONS

TECHNICAL ADVANCES

CUSTOMER SERVICE

The Sun Valley Bronze hardware collection offers unlimited combinations. Any knob, ring pull or lever can be combined with any of our wide range of escutcheon plates.

Our catalog is designed as a tool to assist in the custom hardware selection process. Once a design is chosen, a Sun Valley Bronze representative can work with you in further specifying functional and decorative products to coordinate with and enhance your project.

The oxidation process that Sun Valley Bronze uses to create patinas is an accelerated version of natural exposure to time, touch, and environment. Repeated handling of the hardware will lead to the graceful wear of the patina. Sun Valley Bronze believes patina wear is an inherent quality of the hardware. As with any hand-applied patina finish, color variations should be expected, lending character and distinction to elegant design.

RAW BRONZE

In addition to our standard patina selection, Sun Valley Bronze offers two raw finishes.

- S** Silicon bronze. No patina applied to the flat, tumbled bronze. Color is a light brown with a matte finish.
- W** White bronze. No patina applied to the flat, tumbled bronze. Color is a nickel-silver with a matte finish.



S



W



CS-701 IN W2 FINISH

SILICON BRONZE

Silicon bronze contains the elements copper, silicon, and zinc resulting in a golden-copper hue.

Color range: Polished Natural / Reddish-Brown / Dark Brown

- S1** Satin silicon bronze. No patina applied. Color is light honey brown. This finish will naturally oxidize with age to a light reddish-brown with some green in high humidity installations.
- S2** Medium reddish-brown patina. Color will darken over time.
- S3** Dark brown patina. Often referred to as an oil-rubbed bronze finish (similar to US10B).



S1



S2



S3

WHITE BRONZE

White bronze contains the elements copper, manganese, nickel, and zinc resulting in a silver hue.

Color range: Polished Nickel / Pewter Grey / Black

- W1** Satin white bronze. No patina applied. Color is bright nickel-silver.
- W2** Medium pewter grey patina (similar to US15A).
- W3** Dark grey / black patina.



W1



W2



W3

CARING FOR PATINAS

Bronze is naturally weather resistant. Very little care is needed to maintain it. Sun Valley Bronze recommends cleaning bronze hardware with mild soap and water. Do not use abrasive or chemical-based cleaners. Apply several coats of high quality clear paste wax to protect the finish.

WARRANTY

Sun Valley Bronze warrants a lifetime guarantee for its bronze hardware and bronze accessories to be free of defects in materials and workmanship. Patina finishes are not covered by this warranty. Sun Valley Bronze shall not be held liable for any indirect, special or consequential damages, including accident, misuse, abuse or improper installation. All Sun Valley Bronze hardware must be installed, removed and/or reinstalled by a professional hardware installer or all warranties are void. Please refer to our specification manual for full warranty information.



K-201 2 1/8"
Mushroom Knob
Shown in W2 Finish



K-202 1 7/8"
Hitch Knob
Shown in S2 Finish



K-203 1 3/4" x 2 5/8"
Spud Knob
Shown in S1 Finish



K-205 1 7/8" x 3 1/8"
Baker Knob
Shown in W1 Finish



K-206 1 3/8" x 2 3/8"
Small Egg Knob
Shown in S2 Finish



K-207 1 5/8" x 2 3/4"
Large Egg Knob
Shown in W1 Finish



K-208 2 1/4"
Bob Knob
Shown in W2 Finish



K-209 3"
Portabello Knob
Shown in W3 Finish

CS-F950IML WITH K-201 IN W1 FINISH





CS-402 WITH K-201 IN S3 FINISH



K-214 2 1/2"
Ridge Knob
Shown in W1 Finish



K-215 1 5/8" x 2 9/16"
Oval Ridge Knob
Shown in S2 Finish



K-217 2 1/4"
Flat Knob
Shown in S1 Finish



K-220 1 5/8" x 2 9/16"
Oval Knob
Shown in W2 Finish



K-221 2"
Mini Mushroom Knob
Shown in W1 Finish



K-222 2 3/4"
Big Bob Knob
Shown in S3 Finish



K-225 2 1/4"
Square Knob
Shown in W3 Finish



K-226 1 7/8" x 2 3/4"
Octagon Knob
Shown in W1 Finish



K-228 5/8" x 4"
T-Handle Knob
Shown in S1 Finish



L-101 5 3/4"
Longhorn Lever
Shown in S1 Finish



L-102 4 3/4"
Squirrel Tail Lever
Shown in W2 Finish



L-103 4 1/2"
Chub Lever
Shown in S3 Finish



L-104 4 1/4"
Small Hook Lever
Shown in W1 Finish



L-105 5 1/4"
Beaver Tail Lever
Shown in S2 Finish



L-106 4 1/4"
Square Lever
Shown in W3 Finish



L-107 5"
Large Hook Lever
Shown in S1 Finish



CS-410ML WITH L-109 IN S3 FINISH



L-108 5 1/2"
Chubba Lever
Shown in S2 Finish



L-109 4 1/4"
Ring Tail Lever
Shown in S3 Finish



L-110 4 1/4"
Baldy Lever
Shown in W1 Finish



L-111 4 7/8"
Flat Lever
Shown in W2 Finish



L-112 4 3/4"
Tube Lever
Shown in S3 Finish



L-118 5 1/2"
Eddy Lever
Shown in W3 Finish



L-113 4 1/2"
Alturas Lever
Shown in S1 Finish



L-119 5 1/2"
Muldoon Lever
Shown in W1 Finish



L-114 5 1/2"
Wave Lever
Shown in S2 Finish



L-120 5 1/4"
Croy Lever
Shown in S2 Finish



L-115 5 3/4"
Large Square Lever
Shown in S3 Finish



L-121 5"
Medium Square Lever
Shown in S3 Finish



L-116 4"
Quigley Lever
Shown in W1 Finish



L-122 5 3/16"
Metro Lever
Shown in W1 Finish



L-117 4"
Twist Lever
Shown in W2 Finish



L-123 4 3/4"
New Twist Lever
Shown in S3 Finish

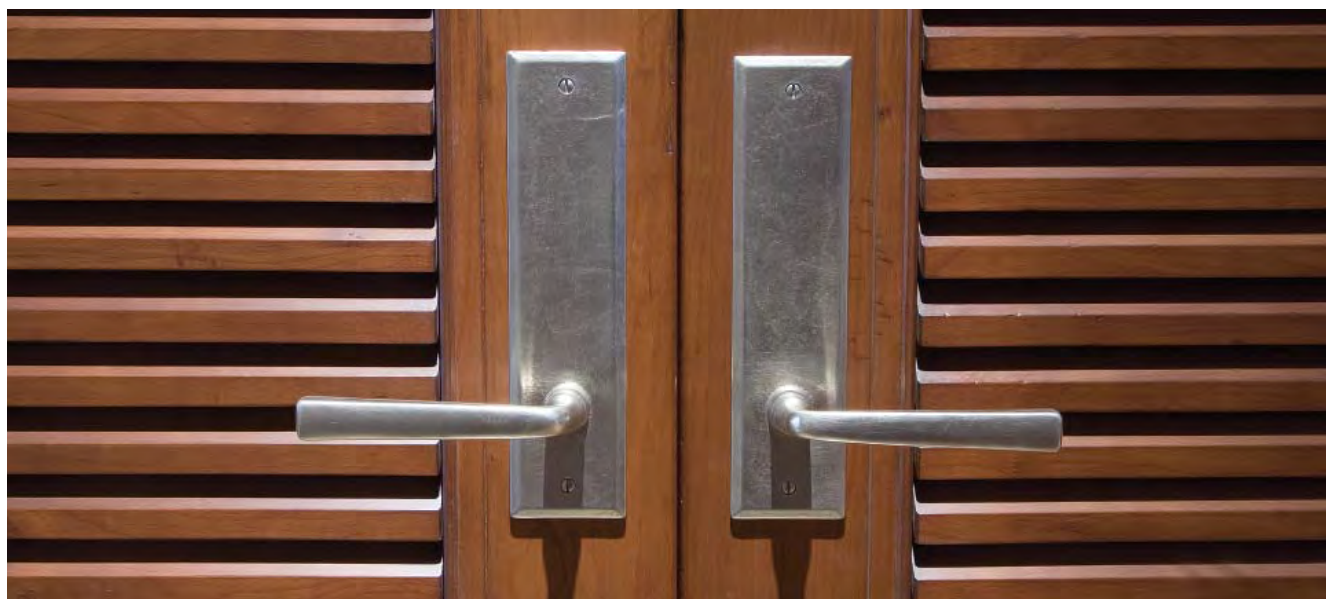

CS-409 WITH L-115 IN W1 FINISH



L-124 5"
Carey Lever
Shown in S3 Finish



L-130 4 3/4"
Ruby Lever
Shown in W2 Finish



L-125 4 1/2"
Camas Lever
Shown in W2 Finish



L-131 4 3/4"
Tap Lever
Shown in W3 Finish



L-126 5 1/8"
Silver Creek Lever
Shown in W1 Finish



L-132 4 1/4"
Little Metro Lever
Shown in W1 Finish

When choosing your custom hardware, keep in mind
that any knob, lever, or ring pull can be combined
with any style or size escutcheon.



L-127 4 3/4"
Hailey Lever
Shown in S3 Finish



L-134 5"
Mighty Twisted Lever
Shown in W2 Finish



L-128 4 3/4"
Stanley Lever
Shown in S2 Finish



L-135 4 7/8"
Large Quigley Lever
Shown in S1 Finish



L-129 5"
Della Lever
Shown in S1 Finish



L-136 5 1/4"
Snake River Lever
Shown in S2 Finish



L-137 5"
Extended Twisted Lever
Shown in W3 Finish



L-141 5 1/2"
Cactus Lever
Shown in S3 Finish



L-138 5"
Lost River Lever
Shown in S2 Finish



L-142 5 1/8"
Deco Lever
Shown in W1 Finish



L-139 5 1/4"
Aspen Lever
Shown in S1 Finish



L-144 4 1/2"
Zuma Lever
Shown in W2 Finish



L-140 5"
Chubber Lever
Shown in W2 Finish



L-145 5 1/2"
Extra Large Quigley Lever
Shown in S3 Finish

CS-410PLD WITH L-136 IN W2 FINISH

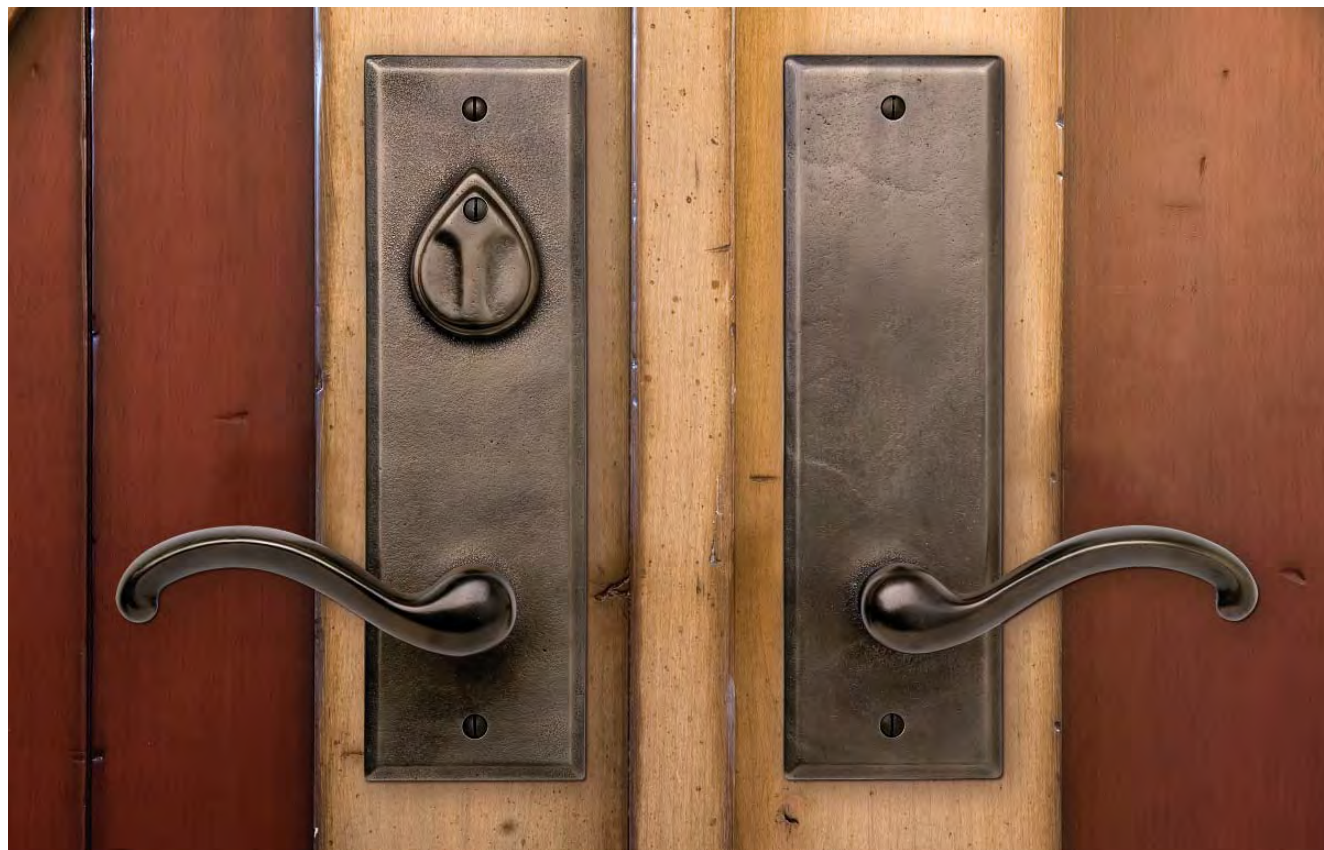



L-146 5 1/4"
Triumph Lever
Shown in S1 Finish



L-147 4 3/4"
Bent Creek Lever
Shown in W2 Finish



L-148 5"
Large Ridge Lever
Shown in W3 Finish



L-149 4 5/8"
Ridge Lever
Shown in S3 Finish



L-152 5 7/8"
Bamboo Lever
Shown in S2 Finish



L-154 5"
Galena Lever
Shown in W3 Finish



L-155 4 1/2"
Whitecloud Lever
Shown in W1 Finish



L-200 5 1/4"
Tapered Wood Handle Lever
Shown in W1 Finish with Brazilian Cherry Handle in Dark Finish



L-201 4 7/8"
Tube Wood Handle Lever
Shown in S2 Finish with Brazilian Cherry Handle in Medium Finish



L-202 4 1/2"
Camas Wood Inlay Lever
Shown in S1 Finish with Reclaimed Apitong Inlay in Dark Finish



L-203 4 7/8"
Flat Wood Inlay Lever
Shown in W1 Finish with Reclaimed Apitong Inlay in Dark Finish

CS-1410ML WITH L-121 IN S3 FINISH





K-210 2 3/4"
Ring Pull
Shown in S1 Finish



K-212 3 5/8" x 4 1/4"
Ring Pull
Shown in S3 Finish



K-213 2 1/2" x 3 5/8"
Ring Pull
Shown in S2 Finish



K-211 3 5/8"
Ring Pull
Shown in S3 Finish



K-216 2 3/8" x 2 3/4"
Ring Pull
Shown in W3 Finish

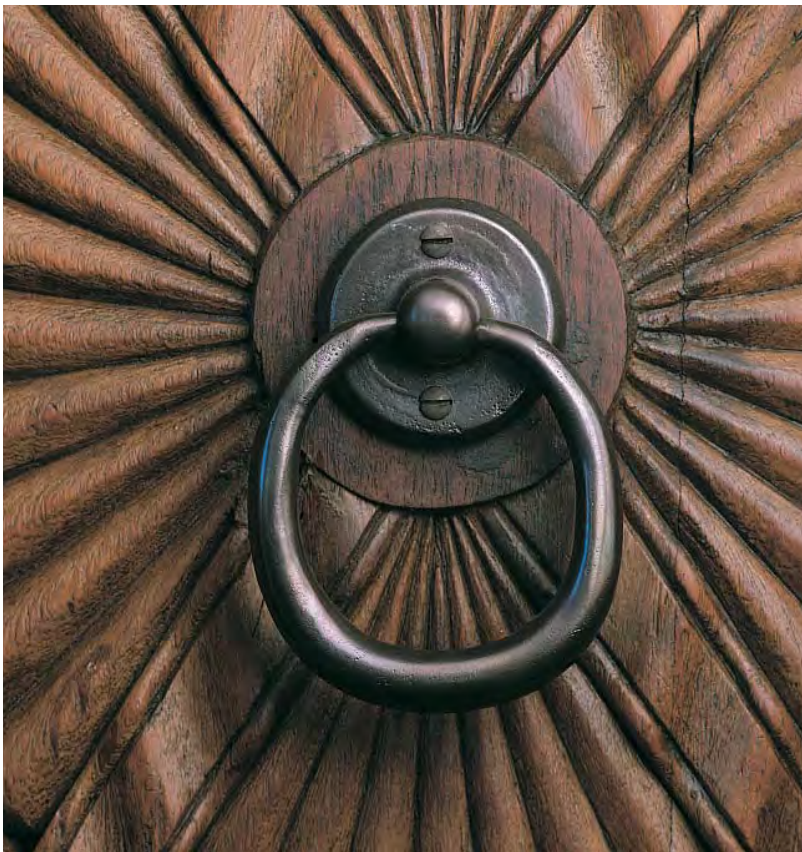

K-211 RING PULL IN S3 FINISH



K-218 2 5/8" x 3 5/8"
Ring Pull
Shown in S1 Finish



CS-701 3" x 18"
Handle x Knob Mortise Lock Entry Set
Shown with K-207 Large Egg Knob
in W2 Finish



CS-704HH 2 1/2" x 17"
Handle x Handle
Mortise Lock Entry Set
Shown in S2 Finish



CS-802HH 3 1/2" x 21"
Handle x Handle
Mortise Lock Entry Set
Shown in S3 Finish

CS-704 IN W1 FINISH



CS-RP225 2 1/4"
Passage Set
Shown with L-102 Squirrel Tail Lever
in W1 Finish



CS-402 2 1/2"
Passage Set
Shown with K-210 Ring Pull
in W3 Finish



CS-RP402 2 1/2"
Passage Set
Shown with K-206 Small Egg Knob
in W2 Finish



CS-402DI 2 1/2"
Passage Set
Shown with L-116 Quigley Lever
in S1 Finish



CS-404 2 1/2" x 4 1/2"
Passage Set
Shown with L-106 Square Lever
in S3 Finish



CS-405PLMB 1 3/4" x 6"
Passage Latch/Mortise Bolt Privacy Set
Shown with K-201 Mushroom Knob
in S3 Finish



CS-407PLD 2" x 8 3/4"
Passage Latch/Deadbolt Entry Set
Shown with L-105 Beaver Tail Lever
in S1 Finish



CS-408ML 2 1/2" x 8 3/4"
Lever x Lever Mortise Lock Entry Set
Shown with L-127 Hailey Lever
in W3 Finish



CS-409IML 2 1/2" x 10"
Interior Mortise Lock Privacy Set
Shown with L-103 Chub Lever
in S2 Finish



CS-410PLD 3" x 10"
Passage Latch/Deadbolt Entry Set
Shown with L-136 Snake River Lever
in S3 Finish



CS-602ML-PF 3 1/2" x 13"
Mortise Lock Patio Set
Shown with K-212 Ring Pull
in S2 Finish

CS-408ML WITH L-106 IN W2 FINISH



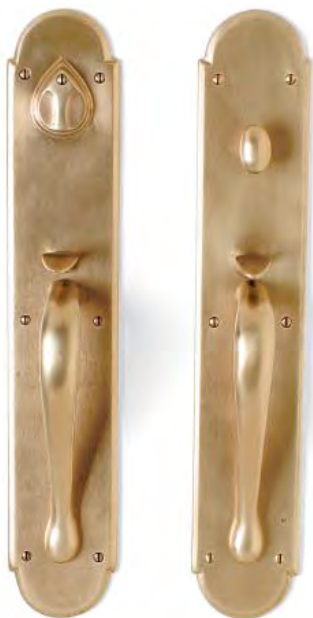

CS-A702HH 3 1/2" x 19 1/2"
Handle x Handle Mortise Lock Entry Set
Shown in S1 Finish



CS-A802 3 1/2" x 21"
Handle x Lever Mortise Lock Entry Set
Shown with L-107 Large Hook Lever
in S3 Finish



CS-A701 IN S2 FINISH



CS-A402 2 1/2" x 4"
Passage Set
Shown with L-120 Croy Lever
in S2 Finish



CS-A404 2 1/2" x 5 3/4"
Passage Set
Shown with K-203 Spud Knob
in W1 Finish



CS-A406 2 1/2" x 7 1/2"
Passage Set
Shown with L-114 Wave Lever
in W2 Finish



CS-A407PLD 2 1/2" x 9 1/4"
Passage Latch/Deadbolt Entry Set
Shown with L-144 Zuma Lever
in W2 Finish



CS-FA408IML-PR 2 1/2" x 9 1/4"
Interior Mortise Lock Privacy Set
Shown with K-201 Mushroom Knob
in S2 Finish



CS-A409PLD 2 1/2" x 11"
Passage Latch/Deadbolt Entry Set
Shown with K-208 Bob Knob
in W1 Finish



CS-A410ML-DC 3" x 11 1/2"
Double Cylinder Mortise Lock Entry Set
Shown with L-101 Longhorn Lever
in S3 Finish



CS-FA601 3" x 14 1/2"
Passage Set
Shown with K-211 Ring Pull
in W3 Finish

CS-FA409 WITH L-134 IN S2 FINISH





CS-901 2 1/2" x 16"
Handle x Lever Mortise Lock Entry Set
Shown with L-106 Square Lever
in S3 Finish



CS-904HH-NKC 2" x 15"
Handle x Handle Mortise Lock Entry Set
Shown in S2 Finish



CS-910 2" x 18"
Handle x Knob Mortise Lock Entry Set
Shown with K-207 Large Egg Knob
in W1 Finish



CS-950ML-NKC 2" x 8 3/4"
Mortise Lock Entry Set
Shown with L-109 Ring Tail Lever
in W2 Finish



CS-F979PLMB 1 1/2" x 6"
Passage Latch/Mortise Bolt Privacy Set
Shown with K-202 Hitch Knob
in S3 Finish



CS-980IML-PR 1 1/2" x 10 1/2"
Interior Mortise Lock Privacy Set
Shown with K-206 Small Egg Knob
in S1 Finish

CS-900 IN W1 FINISH



CS-925DI 2 1/4"
Passage Set
Shown with L-113 Alturas Lever
in W2 Finish



CS-RP925 2 1/4"
Passage Set
Shown with L-110 Baldy Lever
in S1 Finish



CS-926 2 1/2"
Passage Set
Shown with K-201 Mushroom Knob
in W3 Finish



CS-926DI 2 1/2"
Passage Set
Shown with K-203 Spud Knob
in W1 Finish



CS-950PLMB WITH L-119 IN S1 FINISH



CS-F950IML WITH K-201 IN W1 FINISH



CS-RP926 2 1/2"
Passage Set
Shown with K-202 Hitch Knob
in S2 Finish



CS-RP927 3"
Passage Set
Shown with L-111 Flat Lever
in S3 Finish



CMP-US-828 WITH L-126 IN S3 FINISH



CS-721HH 3" x 18"
Handle x Handle Mortise Lock Entry Set
Shown in W2 Finish

All Sun Valley Bronze Collections are available in a wide range of escutcheon sizes. Please refer to the Specification Manual for complete information.



CS-422ML 3" x 10"
Mortise Lock Entry Set
Shown with L-119 Muldoon Lever
in W1 Finish



CS-421PLD 2 1/2" x 8 3/4"
Passage Latch/Deadbolt Entry Set
Shown with K-215 Oval Ridge Knob
in S2 Finish



CS-324 2 1/2" x 4 1/2"
Passage Set
Shown with L-149 Large Ridge Lever
in S2 Finish



CS-325OH 2 1/2" x 6"
Passage Set
Shown with K-201 Mushroom Knob
in S1 Finish



CS-326 3" x 6"
Passage Set
Shown with L-127 Halley Lever
in W3 Finish

CS-721 WITH KC-200 KEY COVER IN S2 FINISH





CS-741 IN S3 FINISH



CS-346IML-PR 3 1/4" x 7 1/2"
Interior Mortise Lock Privacy Set
Shown with K-226 Octagon Knob
in S2 Finish



CS-441ML 3 1/4" x 11 1/2"
Mortise Lock Entry Set
Shown with L-136 Snake River Lever
in W2 Finish



CS-741 3 1/4" x 19 1/2"
Handle x Lever Mortise Lock Entry Set
Shown with L-140 Chubber Lever
in W3 Finish



CS-356 3 1/2" x 6 1/2"
Passage Set
Shown with K-217 Flat Knob
in S3 Finish



CS-451ML 3 1/2" x 10 1/2"
Mortise Lock Entry Set
Shown with L-122 Metro Lever
in S2 Finish



CS-751-HH 3 1/2" x 18 1/2"
Handle x Handle Mortise Lock Entry Set
Shown in W2 Finish



CS-751 IN W3 FINISH



CS-761 IN W2 FINISH



CS-366 3" x 8"
Passage Set
Shown with L-132 Little Metro Lever
in W3 Finish



CS-461ML 3" x 12"
Mortise Lock Entry Set
Shown with L-142 Deco Lever
in W2 Finish



CS-761HH 3" x 20"
Handle x Handle Mortise Lock Entry Set
Shown in W1 Finish



CS-1225HH 3" x 29"
Handle x Handle Mortise Lock Entry Set
Shown in S2 Finish



CS-F1250IML 3" x 21 1/2"
Interior Mortise Lock Passage Set
Shown with K-210 Ring Pull
in S1 Finish



CS-1245ML 2 1/2" x 15 1/2"
Mortise Lock Entry Set
Shown with L-108 Chubba Lever
in S3 Finish



CS-1250PLD-DC 3" x 21 1/2"
Double Cylinder Passage Latch/Deadbolt Entry set
Shown with K-209 Portabello Knob
in S2 Finish

CS-1225 IN W3 FINISH





CS-731 IN S3 FINISH



CS-731HH 3 1/2" x 19"
Handle x Handle Mortise Lock Entry Set
Shown in W3 Finish



CS-336 3 1/2" x 7"
Passage Set
Shown with L-130 Ruby Lever
in S2 Finish



CS-431PLD 3 1/2" x 10"
Passage Latch/Deadbolt Entry Set
Shown with L-126 Silver Creek Lever
in W1 Finish



CS-1418HH 2 1/2" x 18 1/2"
Handle x Handle Mortise Lock Entry Set
Shown in S1 Finish



CS-1406OH WITH L-121 IN S3 FINISH



CS-1410ML 2 1/2" x 10"
Mortise Lock Entry Set
Shown with L-154 Galena Lever
in S3 Finish

CMP-1432 WITH L-121 IN S3 FINISH



CS-1406 2 1/2" x 6 1/2"
Passage Set
Shown with L-106 Square Lever
in W2 Finish



CS-1518 IN S3 FINISH



CS-1518HH 2 1/2" x 18"
Handle x Handle Mortise Lock Entry Set
Shown in S2 Finish



CS-1524HH 2 1/2" x 16"
Handle x Handle Mortise Lock Entry Set
Shown in W1 Finish



CS-1510ML 2 1/2" x 10"
Mortise Lock Entry Set
Shown with L-146 Triumph Lever
in W3 Finish



CS-1506PLMB 2 1/2" x 6"
Passage Latch/Mortise Bolt Privacy Set
Shown with K-216 Ring Pull
in W2 Finish



CS-OP400 2 1/2" x 4 1/4"
Passage Set
Shown with K-201 Mushroom Knob
in S1 Finish



CS-OP500 2 3/4" x 5 1/4"
Passage Set
Shown with L-117 Twist Lever
in S2 Finish



CS-OP600 3" x 7 1/4"
Passage Set
Shown with K-205 Baker Knob
in W1 Finish



CS-713 2 1/2" x 17 1/4"
Handle x Lever Mortise Lock Entry Set
Shown with L-102 Squirrel Tail Lever
in W1 Finish



ASPEN LEAF ENTRY SET



CS-OP700ML 3" x 8 3/4"
Mortise Lock Entry Set
Shown with L-102 Squirrel Tail Lever
in S3 Finish



RAW MATERIAL

Sun Valley Bronze uses only the finest art-grade bronze for consistent, high quality castings. New ingots are transformed into architectural hardware. Scrap bronze from sand castings is recycled into subsequent castings, and even the floor sweepings are saved and sent to recycling centers.

PATTERN MAKING

Patterns originate as an idea on paper. The design then begins to take shape traditionally in hand-carved wood or resin models, or by implementing sophisticated 3D modeling software.





CASTING

A row of flasks with ingot weights stands ready for casting. The furnace heats up to a pouring temperature of 2250° fahrenheit.

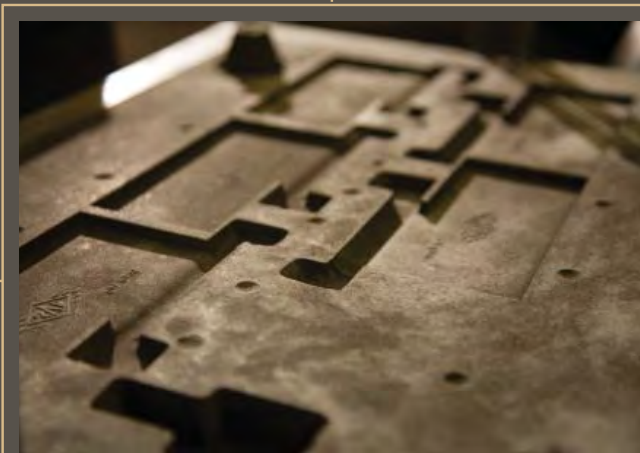

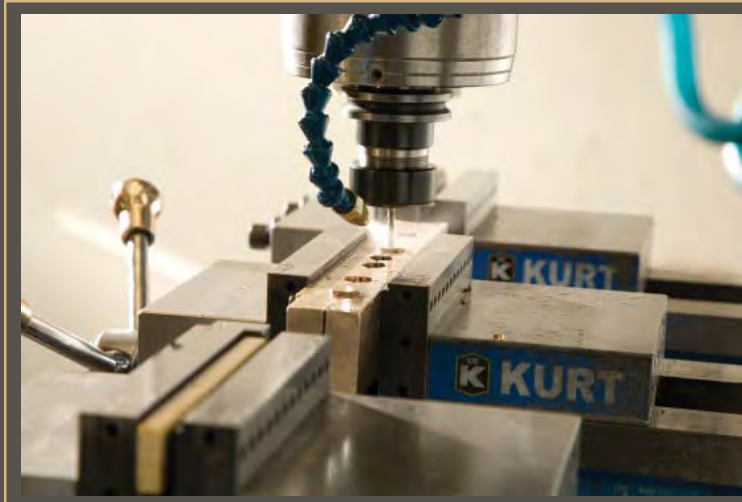

PRECISION MACHINING

Precision machining ensures that every piece of Sun Valley Bronze hardware functions perfectly and meets our exacting specifications.

ASSEMBLY

Sun Valley Bronze hardware assembly includes stainless steel components and teflon coated springs for flawless function, and to ensure longevity in humid or coastal climates.





BEAUTIFUL PATINAS

Hand applied non-toxic patinas take the place of time and nature to oxidize copper and other alloys, giving the bronze a deep, aged look and feel.

FINISHED HARDWARE

Sun Valley Bronze showrooms display a variety of styles and patina choices. Whatever your project, residential or commercial, it is easy to mix and match designs and finishes.





CMP-811 WITH L-106 IN W2 FINISH



CMP-811 1 1/2" x 10 1/2"
Profile Cylinder Multi-Point Entry Set
Shown with L-104 Small Hook Lever
in W1 Finish



CMP-811KC 1 1/2" x 10 1/2"
Profile Cylinder Multi-Point Entry Set
Shown with L-120 Croy Lever
in S3 Finish



CMP-A811PF 1 1/2" x 10 1/2"
Profile Cylinder Multi-Point Patio Function Set
Shown with L-117 Twist Lever
in S1 Finish



CMP-US-980 1 1/2" x 10 1/2"
US Cylinder Multi-Point Entry Set
Shown with L-112 Tube Lever
in W3 Finish



CMP-US-A812FD 2 1/2" x 10 1/2"
US Cylinder Multi-Point Dummy Set
Shown with L-101 Longhorn Lever
in S2 Finish



CMP-US-OP812 2 5/8" x 10 1/8"
US Cylinder Multi-Point Entry Set
Shown with L-103 Chub Lever
in W1 Finish



CMP-US-828 2" x 11 1/2"
US Cylinder Multi-Point Entry Set
Shown with L-106 Square Lever
in W2 Finish



CMP-1242 1 3/4" x 15 1/2"
Profile Cylinder Multi-Point Entry Set
Shown with L-114 Wave Lever
in S3 Finish



CMP-US-4632 2" x 13 1/2"
US Cylinder Multi-Point Entry Set
Shown with L-142 Deco Lever
in S1 Finish



CMP-A812 WITH L-134 IN S2 FINISH

MULTI-POINT HARDWARE

We manufacture hardware to retro-fit any Profile Cylinder or US Cylinder multi-point locking system. This allows you to carry a consistent theme throughout your entire project. US and European profile cylinders are available for all escutcheon styles.



CMP-US-817SL 1 7/8" x 13 1/2"
US Cylinder Sliding Door Entry Set
Shown in S1 Finish



CMP-US-986SL-PF 1 7/8" x 13 1/2"
US Cylinder Sliding Door Patio Function Set
Shown in W2 Finish

CMP-980SL WITH L-121 IN W2 FINISH



CMP-A811SL 1 1/2" x 10 1/2"
Profile Cylinder Sliding Door Entry Set
Shown with L-106 Square Lever
in S2 Finish



CMP-982SL 2" x 10 1/2"
Profile Cylinder Sliding Door Entry Set
Shown with L-111 Flat Lever
in W1 Finish

LIFT & SLIDE



CMP-819LS
 1 1/2" x 6 3/4" (int) / 2" x 6 3/4" (ext)
 Lift & Slide Retro-Fit Set
 Shown with LS-107 Lever
 in S2 Finish



CMP-A819LS
 1 1/2" x 6 3/4" (int) / 2" x 6 3/4" (ext)
 Lift & Slide Retro-Fit Set
 Shown with LS-115 Lever
 in S3 Finish



CMP-989LS
 1 1/2" x 6 3/4" (int) / 2" x 6 3/4" (ext)
 Lift & Slide Retro-Fit Set
 Shown with LS-111 Lever
 in W3 Finish

CMP-989LS WITH LS-119 IN W1 FINISH



LOCKING SLIDING DOOR FLUSH PULL SET



CS-FP404ML 2 3/4" X 6 3/4"
 Sliding Door Exterior Flush Pull Set
 with Mortise Lock
 Shown in S2 Finish



CS-502/503DB 2 1/4"
Auxiliary Deadbolt Set
Shown in S3 Finish



CS-506/503DB 1 3/4" x 2 1/4" (Ext) / 2 1/4" (Int)
Auxiliary Deadbolt Set
Shown in S1 Finish



CS-504/507DB 2 1/4"
Auxiliary Deadbolt Set
Shown in W1 Finish



CS-506/507DB 1 3/4" x 2 1/4" (Ext) / 2 1/4" (Int)
Auxiliary Deadbolt Set
Shown in S3 Finish



CS-505/508DB 2 1/2"
Auxiliary Deadbolt Set
Shown in W3 Finish



CS-509/510DB 2 1/2" x 3"
Auxiliary Deadbolt Set
Shown in S2 Finish



CS-A509/A510DB 2 1/2" x 4"
Auxiliary Deadbolt Set
Shown in S3 Finish



CS-402 WITH L-109 AND CS-506/503DB IN S3 FINISH



CS-511/512DB 2 1/2" x 3 1/2"
Auxiliary Deadbolt Set
Shown in W3 Finish



CS-9502/9503DB 2 1/4"
Auxiliary Deadbolt Set
Shown in W2 Finish

All deadbolts can be specified as single cylinder,
double cylinder, or patio function.

CS-402 WITH L-106 AND CS-506/503DB IN W2 FINISH



CS-9504/9507DB 2 1/4"
Auxiliary Deadbolt Set
Shown in S3 Finish



CS-9509/9510DB 2 1/2" x 3"
Auxiliary Deadbolt Set
Shown in W1 Finish





CS-RP925 WITH L-112 AND CS-9490/9491MB IN S1 FINISH



CS-158/RC-4 1 5/8"
Auxiliary Mortise Bolt Privacy Set
Shown in W3 Finish



CS-440/441MB 2 1/4"
Auxiliary Mortise Bolt Privacy Set
Shown in S1 Finish



CS-442/443MB 2 1/4"
Auxiliary Mortise Bolt Privacy Set
Shown in S2 Finish



CS-444/445MB 1 3/4" x 3"
Auxiliary Mortise Bolt Privacy Set
Shown in S3 Finish

All mortise bolt trim can be ordered
with or without a release cover.



CS-9158/RC-9 1 5/8"
Auxiliary Mortise Bolt Privacy Set
Shown in S1 Finish



CS-9490/9491MB 2 1/4"
Auxiliary Mortise Bolt Privacy Set
Shown in W1 Finish



CS-9496/9497MB 1 3/4"
Auxiliary Mortise Bolt Privacy Set
Shown in W2 Finish



CS-OP150SD 1 1/2" x 3 1/2"
Screen Door Passage Set
Shown with L-92 Lil' Squirrel Lever
in W3 Finish



CS-150SD 1 1/4" x 3 3/4"
Screen Door Passage Set
Shown with L-16 Mini Quigley Lever
in S1 Finish



CS-A150SD 1 1/4" x 3 3/4"
Screen Door Passage Set
Shown with K-305 Mini Egg Knob
in S3 Finish

Sun Valley Bronze offers many lever options for
screen door hardware. Please refer to the
Specification Manual for the complete collection.



CS-9100SD 1 1/4" x 3 3/4"
Screen Door Passage Set
Shown with L-28 Mini Stanley Lever
in S3 Finish



CS-A150SD 1 1/4" x 3 3/4"
Screen Door Passage Set
Shown with L-26 Mini Silver Creek Lever
in W2 Finish

CS-100SD WITH L-93 IN S3 FINISH





CS-FP203IML-PR IN W2 FINISH



CS-FP203IML-PR 2" x 4 3/8"
Pocket Door Privacy Set
Shown in W2 Finish



FP-A400 2 7/8" x 6 7/8"
Flush Pull
Shown in S3 Finish



FP-200 2" x 4 3/8"
Flush Pull
Shown in W1 Finish



FP-OP200 2" x 4 3/8"
Flush Pull
Shown in S3 Finish



FP-312 2 1/2" x 12 5/8"
Flush Pull
Shown in S2 Finish



CS-FP401IML-PR 2 7/8" x 5 3/4"
Pocket Door Privacy Set
Shown in S1 Finish



CS-FP450ML 2 3/4" x 10"
Locking Pocket Door Set
Shown in W3 Finish



EDG-100 5/8" x 4 3/16"
Edge Pull
Shown in Closed Position
in S3 Finish



EDG-200 1 1/4" x 8"
Edge Pull
Shown in Open Position
in S3 Finish

CS-FP401IML-PR IN W1 FINISH





THE SUN VALLEY BRONZE GATE LATCH COLLECTION



CS-GL100 5" x 3 3/8"
Gate Latch Passage Set
Shown with L-109 Ring Tail Lever
in W2 Finish



CS-GL200PR 5" x 3 3/8"
Gate Latch Privacy Set
Shown with L-112 Tube Lever
in W1 Finish



CS-GL300 6 5/8" x 3 3/8"
Gate Latch Passage Set
Shown with L-105 Beaver Tail Lever
in S3 Finish



CS-GL400/P-115 4" x 3 3/8"
Gate Latch Passage Set
Shown with L-136 Snake River Lever
in S2 Finish



CS-BAGL3000/P-2995 9 1/2" x 6"
Gate Latch Passage Set
Shown with L-134 Mighty Twisted Lever
in S2 Finish

Our unique Gate Latch is available in a variety of configurations
such as Thumb Latch x Gate Latch Deadbolt Entry.
Gate Latch Entry Sets are available with any of our
standard grip handle entry escutcheon designs.



CS-704/GL-200/CS-509/510DB 5" x 3 3/8"
Grip Handle x Gate Latch Deadbolt Entry Set
Shown with L-121 Medium Square Lever
in W1 Finish



CS-GLA600-PLD 3 1/2" x 10"
Gate Latch Deadbolt Entry Set
Shown with L-137 Extended Twist Lever
in S1 Finish
(Strike not Shown)

INTERIOR OF DOOR



EXTERIOR OF DOOR



CS-704 WITH GL-200 AND CS-509/510DB IN W1 FINISH

DOOR HINGES



BH-3030 3" x 3"
Door Hinge
Shown with Button Finial
in S2 Finish



BH-5050 5" x 5"
Door Hinge
Shown with Ball Finial
in W1 Finish



BH-4040 4" x 4"
Door Hinge
Shown with Flat Finial
in S3 Finish



BH-4545 4 1/2" x 4 1/2"
Door Hinge
Shown with Dome Finial
in S1 Finish



BH-6060 6" x 6"
Door Hinge
Shown with Steeple Finial
in W3 Finish



BH-4545 WITH BHF-FREN FINIAL IN W3 FINISH

FINIALS



BHF-FLAT
Flat



BHF-BUTN
Button



BHF-DOME
Dome



BHF-BALL
Ball



BHF-RDG
Ridge



BHF-STPL
Steeple



BHF-ACRN
Acorn



BHF-FDL
Fleur de Lis



BHF-FREN
French



BHF-URN
Urn

CABINET HINGES



CBH-25200 2 1/2" x 2"
Cabinet Hinge
Shown with Ball Finial
in W2 Finish

Cabinet Hinge also available in these sizes:

CBH-25134 1/2" x 1 3/4"

CBH-25150 2 1/2" x 1 1/2"

BH-4040 WITH BHF-BALL FINIAL IN W1 FINISH



SPECIALTY HINGES



PH-100
Pivot Hinge
Shown in S3 Finish



BH-4040BFP
Bi-Fold Door Hinge with Pull
Shown with Ball Finial in S3 Finish

PATENTED ADJUSTABLE LIFT-OFF HINGE

This remarkable hinge incorporates innovative design, precision machining, and a stainless steel ball bearing, to create a low-friction, smooth operating hinge that is easily adjusted.

A pair of matched hinge leaves are fitted around an adjustment mechanism and tension pin that allow vertical adjustment of either hinge leaf relative to the second hinge leaf at any time. Partial threading of the mechanism and tension pin prevents over-adjustment, thus protecting the structural integrity of the hinge. The stainless steel ball bearing, fitted between the hinge leaves, reduces friction and extends the useful life of the hinge. The hinge is easy to lift-off by simply lifting upward. Long term performance is assured through meticulous design details.





SH-B-18 18"
Decorative Dummy Strap Hinge
Shown in S1 Finish



SH-C 8" x 14 1/4"
Decorative Corner Bracket
Shown in S2 Finish



SH-FDL-18 18"
Decorative Dummy Strap Hinge
Shown in W3 Finish



SH-FDL2-33 33"
Decorative Dummy Strap Hinge
Shown in S3 Finish



SH-B-12-ACT-CK 12"
Active Cabinet Door Strap Hinge
Shown with Button Finial
in S1 Finish



SH-B-15-ACT/BHF-URN 15"
Active Strap Hinge
Shown with Urn Finial
in S2 Finish



SH-B-18-ACT/BHF-FREN 18"
Active Strap Hinge
Shown with French Finial
in S3 Finish





CB-68 6' 8"
Cremone Bolt
Shown with L-105 Beaver Tail Lever
in W3 Finish



CS-CB-409-68 6' 8"
Locking Cremone Bolt Entry Set
Shown with L-142 Deco Lever
in W1 Finish



CB-1000-INT-PF 6' 8"
Dummy Cremone Multi-Point Retro-Fit Set
Shown with L-136 Snake River Lever
in S2 Finish

Sun Valley Bronze cremone bolts are available
in passage, dummy, patio, and entry functions.
Any escutcheon design can be used on the exterior side
of the door. Cremone bolts are available in any length.



OSB-12 12"
Oval Surface Bolt
Shown in W1 Finish



OSB-18 18"
Oval Surface Bolt
Shown in S1 Finish



MSB-6 6"
Mini Surface Bolt
Shown in S1 Finish



SSB-12 12"
Square Surface Bolt
Shown in S3 Finish



SSB-30 30"
Square Surface Bolt
Shown in S3 Finish



BB-18 18"
Cane Bolt
Shown in S2 Finish



OSB-12 IN S3 FINISH



GL-100 WITH MSB-6 IN S3 FINISH



OC-OSB-12 12"
Lever Operated Surface Bolt
Shown in S2 Finish

Surface bolts and cane bolts
are available in custom sizes.



SSB-1000
Slide Bolt
Shown in W2 Finish



GH-799 8 1/2"
Grip Handle
Shown in S1 Finish



GH-700 9 1/4"
Grip Handle
Shown in W2 Finish



GH-800 11 3/4"
Grip Handle
Shown in S2 Finish



GH-850 14 1/2"
Grip Handle
Shown in W3 Finish



DH-6 6 5/8"
D Handle
Shown in W1 Finish



DH-8 8 7/8"
D Handle
Shown in S1 Finish



DH-9 9"
D Handle
Shown in W3 Finish

GH-450 IN S2 FINISH



GH-450 13 3/8"
Grip Handle
Shown in W2 Finish



DH-18 18"
D Handle
Shown in W3 Finish



GH-525 25 1/4"
Grip Handle
Shown in S1 Finish



GH-500 12 3/4"
Grip Handle
Shown in S3 Finish





GH-900 6"
Contemporary Grip Handle
Shown in W2 Finish



GH-983 8"
Contemporary Grip Handle
Shown in W1 Finish



GH-961 8 1/8"
Deco Grip Handle
Shown in W1 Finish



GH-500 IN S3 FINISH



GH-TWG18 17 1/4"
Twig Grip Handle
Shown in S2 Finish

All grip handles are available with a back-to-back mounting option and can also be used as refrigerator pulls.



GH-1312R 12"
Bamboo Grip Handle
Shown in S2 Finish



GH-1317 17 5/8"
Bamboo Grip Handle
Shown in W1 Finish



GH-1317R 17 5/8"
Bamboo Grip Handle
Shown in W2 Finish



GH-1325 25"
Bamboo Grip Handle
Shown in S1 Finish



GH-1326R 25 3/4"
Bamboo Grip Handle
Shown in S3 Finish



GH-850/PP-852
3 1/2" x 22 3/4"
Grip Handle/Push Plate
Shown in W3 Finish



PP-A602
3 1/2" x 15 1/4"
Arch Push Plate
Shown in W2 Finish



PP-OP700
3" x 8 3/4"
Oval Push Plate
Shown in S3 Finish



PP-952
2 1/2" x 10"
Push Plate
Shown in S2 Finish



PP-1320
2 1/2" x 18"
Bamboo Push Plate
Shown in S3 Finish



GH-500/PP-701
3" x 18"
Grip Handle/Push Plate
Shown in S3 Finish

Push plates are available in any escutcheon size from any of our collections.

DH-8 WITH PP-410 PUSH PLATE IN S3 FINISH





DK-6 IN S3 FINISH



DK-3 3"
Door Knocker
Shown in W2 Finish



DK-4 4"
Door Knocker
Shown in S2 Finish



DK-STAR 6"
Star Door Knocker
Shown in S3 Finish



DK-6 6"
Door Knocker
Shown in W1 Finish



DK-96 6"
Square Door Knocker
Shown in W3 Finish



DK-8 8"
Door Knocker
Shown in S3 Finish



DRB-1 2 1/4"
Round Bevel Door Bell
Shown in W1 Finish



DRB-2 2 1/4"
Square Bevel Door Bell
Shown in S1 Finish



DRB-3 1 3/4" x 3"
Oval Door Bell
Shown in S2 Finish



DRB-4 1 3/8" x 3"
Rectangular Bevel Door Bell
Shown in W3 Finish



DRB-5 1 3/8" x 2 5/8"
Arch Door Bell
Shown in S3 Finish



DRB-9-1 2 1/4"
Round Contemporary Door Bell
Shown in W2 Finish



DRB-9-3 1 3/8" x 3"
Rectangular Contemporary Door Bell
Shown in S1 Finish



CUSTOM P-404 DOOR BELL IN S3 FINISH



DRB-721 1 3/8" x 3"
Ridge Door Bell
Shown in W3 Finish



DRB-741 1 7/8" x 3 1/4"
Hampton Door Bell
Shown in S2 Finish



DRB-751 1 3/4" x 3 1/4"
Trellis Door Bell
Shown in S3 Finish



DRB-761 1 5/8" x 3 1/2"
Deco Door Bell
Shown in S2 Finish



DRB-1400 1 3/8" x 3"
Corrugated Door Bell
Shown in W1 Finish



DRB-1500 1 3/8" x 3"
Bandbox Door Bell
Shown in S1 Finish



CS-731 WITH DRB-1400 IN S3 FINISH





DS-3 3 1/4"
Base Mount Door Stop
Shown in S3 Finish



DS-5 3 1/2"
Base Mount Door Stop
Shown in S2 Finish



DS-1 1 5/8"
Floor Mount Door Stop
Shown in W1 Finish



DS-2HE IN W2 FINISH



DS-2HE 3 3/4"
Floor Mount Door Stop with Hook & Eye
Shown in S3 Finish



DS-2 2 3/4"
Floor Mount Door Stop
Shown in W2 Finish



DS-5HE 3 1/2"
Base Mount Door Stop with Hook & Eye
Shown in W1 Finish



KP-348 34" x 8"
Kick Plate
Shown in S2 Finish



KP-9348 34" x 8"
Kick Plate
Shown in W2 Finish

KICK PLATES

Available in custom sizes.

CLAVOS



CL-R 1 1/4"
Round Decorative Clavos
Shown in S2 Finish



CL-S 1 1/4"
Square Decorative Clavos
Shown in S1 Finish



CS-1410ML WITH L-121 AND KP-9348 IN S3 FINISH



SPEAK EASY GRILL

SEG-1416 14" X 16"
Speak Easy Grill
Shown in S2 Finish

MAIL SLOTS

Mail Slots are available in 13" and 16" with or without interior trim.



CS-MLST-13 13"
Mail Slot
Shown in W3 Finish

CS-MLST-16 16"
(Not shown)



CWC-100 AND CML-100 IN S3 FINISH



CML-100 4 3/4" x 5 7/8" (open)
Mirage Type Window Latch
Shown in W3 Finish



CWC-100 5 3/4" x 1 1/8"
Window Crank and Cover
Shown in W2 Finish



WSL-500 2 1/2" x 1 3/8"
Window Sash Lock
Shown in S2 Finish



CWL-300RH 2 1/2" x 4"
Window Sash Lock
Shown in S3 Finish



SP-400 5" c to c
Surface Mount Sash Pull
Shown in S1 Finish



CWL-100RH 2 1/4" x 3"
Window Latch with Strike
Shown in W1 Finish



CWL-302LH 1 3/4" x 3"
Window Sash Lock
Shown in S1 Finish



MPW-300 WITH L-119 IN S3 FINISH



MPW-100 1 3/16" x 3"
Multi-Point Window Set
Shown with L-96 Squarelet Lever
in S1 Finish



MPW-A100 1 3/16" x 3"
Multi-Point Window Set
Shown with L-92 Lil' Squirrel Lever
in S2 Finish



MPW-OP100 1 3/16" x 3"
Multi-Point Window Set
Shown with L-93 Chubster Lever
in S3 Finish



MPW-200 1 3/8" x 4 1/2"
Multi-Point Window Set
Shown with K-305 Knob
in W3 Finish



MPW-300 1 3/8" x 4 1/2"
Multi-Point Window Set
Shown with L-106 Square Lever
in S3 Finish

MPW-A100 WITH L-23 IN S2 FINISH



TOWEL RINGS



TR-5 5"
Towel Ring
Shown with P-402DI Escutcheon
in S2 Finish



TR-7 7"
Towel Ring
Shown with RP-925 Escutcheon
in W1 Finish



TR-1307 7 1/2"
Towel Ring
Shown with P-926 Escutcheon
in S3 Finish

TOILET PAPER HOLDERS



AW-100RH 6" x 4"
Toilet Paper Holder - Points Right
Shown with RP-403 Escutcheon
in W2 Finish



TR-9107 7"
Towel Ring
Shown with RP-925 Escutcheon
in W2 Finish



TR-9108 5 1/2" x 7 1/2"
Towel Ring
Shown with P-926 Escutcheon
in W3 Finish



AW-100LH 6" x 4"
Toilet Paper Holder - Points Left
Shown with P-926 Escutcheon
in S1 Finish



AW-9100RH 6" x 4"
Toilet Paper Holder - Points Right
Shown with P-926 Escutcheon
in W1 Finish
(AW-9100LH not Shown)

SOAP DISH

Free-standing round and oval
soap dishes are also available.



SD-3 5"
Wall Mount Soap Dish
Shown in W1 Finish



TB-9116 16"
Towel Bar
Shown with P-926 Escutcheon
in S1 Finish



STB-24 24"
Solid Towel Bar
Shown with RP-403 Escutcheon
in S1 Finish



TB-24 24"
Towel Bar
Shown with P-402 Escutcheon
in W1 Finish



TB-32TBC 32"
Towel Bar with Center Post
Shown with P-925 Escutcheon
in S3 Finish

Towel Bars are available
in custom lengths.

All bath accessories can be ordered
with any standard bath escutcheon.

TOWEL RACK



RACK-24 24" x 9"
Towel Rack
Shown with P-402 Escutcheon
in S3 Finish



DH-6 (BACK-TO-BACK) WITH TOWEL BAR SHOWN ON GLASS SHOWER DOOR



POT RACK PARTS



PR-1 8" x 1 3/4"
Chain Link
Shown in S2 Finish



PR-3 2 1/2" x 3 1/4"
Adjustable Pot Hook
Shown in W3 Finish



PR-2 1 3/4" x 3 1/2"
S Hook
Shown in W2 Finish



PR-4 3"
Ceiling Bracket
Shown in S1 Finish



PT-100 13"
Free Standing Paper Towel Holder
Shown in W1 Finish

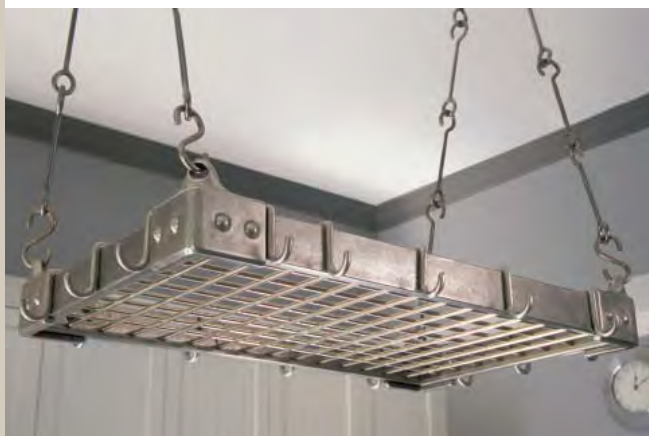
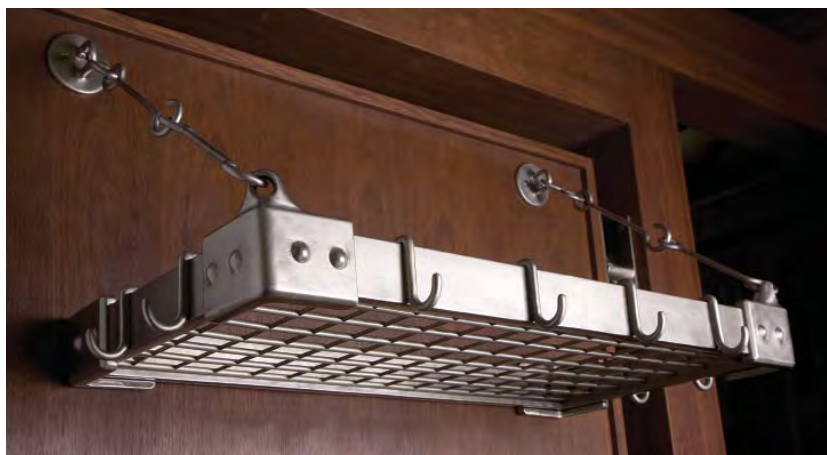

CPR-2032 31" x 19 1/2"
Pot Rack with Bronze Grate
Shown in W1 Finish

Our pot racks are available in custom sizes and configurations, including wall mount, ceiling mount and corner mount.



PT-109RH 13"
Paper Towel Holder - Points Right
Shown with OP-400 Escutcheon
in S2 Finish
(PT-109LH not Shown)

BRONZE TILES



BT-9-4 4" x 4"
Contemporary Bronze Tile
Shown in S1 Finish



BT-9-4 4" x 4"
Contemporary Bronze Tile
Shown in S2 Finish



BT-9-4 4" x 4"
Contemporary Bronze Tile
Shown in W1 Finish



BT-9-4 4" x 4"
Contemporary Bronze Tile
Shown in S3 Finish

Sun Valley Bronze offers a wide range of tile sizes. Custom shapes and designs are also available.



BT-2 2" x 2"
Bevel Edge Bronze Tile
Shown in S1 Finish



BT-2 2" x 2"
Bevel Edge Bronze Tile
Shown in W2 Finish



BT-2 2" x 2"
Bevel Edge Bronze Tile
Shown in W3 Finish



BT-2 2" x 2"
Bevel Edge Bronze Tile
Shown in W1 Finish

SOLID BRONZE BATH SINKS AND FAUCETS



OSR-1117/LF-01-01-20 19 1/2" x 13 3/4" x 8 3/4" Depth
Self Rimming Bronze Sink with Deck Mount Faucet
Shown in S1 Finish



VS-16/WLF-02-01-20 16" Round x 6 1/4" Depth
Bronze Vessel Sink with Wall Mount Faucet
Shown in S2 Finish with SD-1 Round Soap Dish

SINK-3222-FRM 31 1/2" x 21 3/4" x 10" Depth
Bronze Farmhouse Kitchen Sink
Shown in S1 Finish



Our hand-cast, solid bronze kitchen and bathroom sinks are truly works of art.

Also available are bar sinks, undermount sinks, and the double basin kitchen sink. Please refer to the Specification Manual for our full line.





CH-3 IN S3 FINISH



CH-1 3 1/8" x 3 1/2"
Two Prong Coat Hook
Shown in W1 Finish



CH-2 4 3/8" x 7"
Three Prong Coat Hook
Shown in W2 Finish



CH-3 2 1/2" x 3 1/2"
Single Prong Coat Hook
Shown in S1 Finish

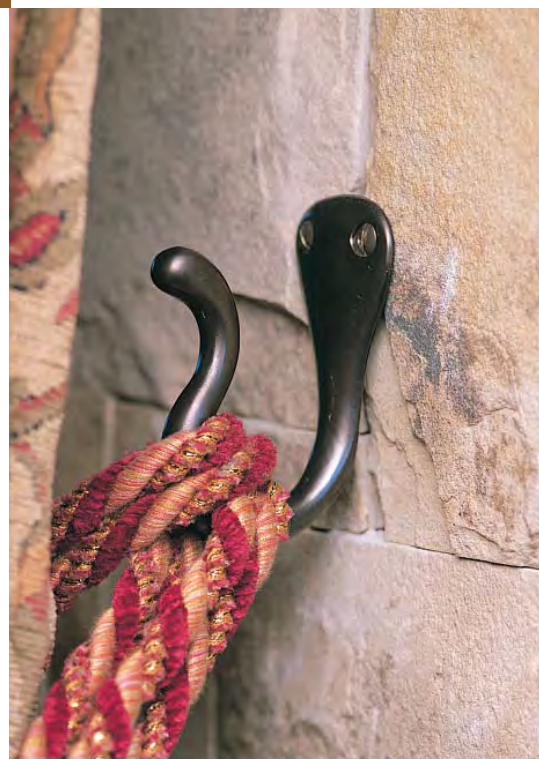

CH-4 5 1/4" x 4 3/4"
Four Prong Coat Hook
Shown in W3 Finish



CLST-3WM 3"
Closet Rod Wall Mount Rod End
Shown in S2 Finish



CLST-F2 1 5/8"
Closet Rod Finial with Hook
Shown in S2 Finish



CLST-4E 1 3/8" x 3 3/4"
Closet Elbow
Shown in W3 Finish



CLST-15BK 14" x 14"
Closet Bracket
Shown in S3 Finish

Closet Brackets also available in these sizes:
CLST-13BK 13" x 14" (refer to photo below)
CLST-17BK 17" x 14"

CLST-13BK BRACKET WITH FLAT CAP FINIAL IN S3 FINISH



The Closet Collection is a custom hardware component system designed to accommodate your finest garments.

The closet system is configured to turn inside and outside corners and is available with a choice of finials.

GATE ACCESSORIES



GC-100
Cannon Ball Gate Closer
Shown in S3 Finish



HE-100 8" x 2 1/4"
Hook & Eye
Shown in S1 Finish



HE-200 8" x 2 1/4"
Hook & Eye
Shown in S2 Finish



HASP-10 10"
Hasp Latch with 3 Guides
Shown in W3 Finish

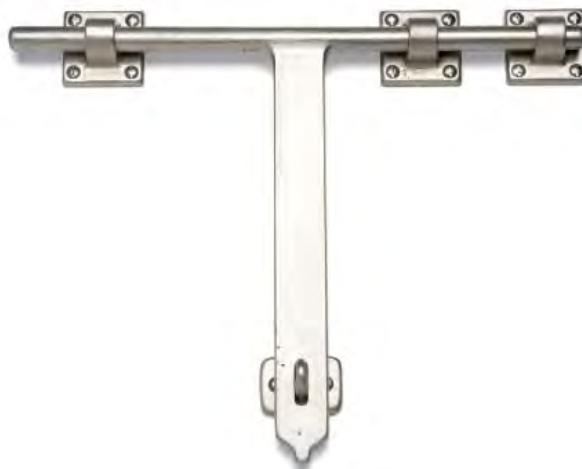

SLBT-14 14"
T-Shaped Slide Bolt with 3 Guides
Shown in W1 Finish



HN-1 4 1/2"
House Number 1
Shown in S1 Finish



HN-2 4 1/2"
House Number 2
Shown in W3 Finish



HN-3 4 1/2"
House Number 3
Shown in S3 Finish



HN-4 4 1/2"
House Number 4
Shown in W2 Finish



HN-5 4 1/2"
House Number 5
Shown in W1 Finish

HOUSE NUMBERS

Letters are available in the HN Series.



HNJ-6 7 1/4"
House Number 6
Shown in S3 Finish



HNJ-7 7 1/4"
House Number 7
Shown in S1 Finish



HNJ-8 7 1/4"
House Number 8
Shown in W2 Finish



HNJ-9 7 1/4"
House Number 9
Shown in S3 Finish



HNJ-0 7 1/4"
House Number 0
Shown in W2 Finish

SWITCH PLATES AND OUTLET COVERS



EC-101 2 3/4" x 4 1/2"
Switch Plate
Shown in S1 Finish



EC-9301 2 3/4" x 4 1/2"
Decora Switch Plate
Shown in W1 Finish



EC-202 4 3/4" x 4 1/2"
Outlet Cover
Shown in S2 Finish



EC-303 6 3/4" x 4 1/2"
Decora Switch Plate
Shown in W3 Finish



EC-600 4 3/4" x 4 1/2"
Combination Plate
Shown in S3 Finish

Electrical Plates and
Covers are available in all
standard configurations.

HAND RAIL BRACKET



HB-1 3" x 2 3/4"
Hand Rail Bracket
Shown in W2 Finish

Hand Rail Brackets also available in these sizes:

HB-2 3" x 5"

HB-3 3" x 3 5/8"

GAS KEY



GK-2/GK-ESC 2"
Gas Key with Escutcheon
Shown in W1 Finish

Gas Keys also available in these sizes:

GK-1 1"

GK-4 4"

GK-6 6"

EC-102 IN W1 FINISH





SOLID BRONZE BELL

The Bronze Bell is available in two sizes.
Wall mount or ceiling mount brackets
can be specified.

FPB-8/C-1 8"
Solid Bronze Bell
Shown with Wall Mounted Bracket
in S2 Finish

FPB-6 6"
Solid Bronze Bell
(Not shown)

TACK ROOM ACCESSORIES



BDL-924 1 1/2" x 2"
Single Prong Girth Hook
Shown in S3 Finish



BDL-901 6"
Round Bridle Hook
Shown in W3 Finish



CT-100 1 1/4" x 2 3/4"
Cross Tie
Shown in W2 Finish



BDL-923 4" x 3"
Double Prong Girth Hook
Shown in S1 Finish



ANV-3 3 1/4"
Rope Cleat
Shown in S2 Finish

CABINET KNOBS



CK-302 1" x 1 1/2"
Oval Cabinet Knob
Shown in W1 Finish



CK-303 1 1/4" x 1 1/2"
Oval Cabinet Knob
Shown in S3 Finish



CK-306 1" x 1 1/2"
Oval Ridge Cabinet Knob
Shown in W1 Finish



CK-400 3/4"
Round Cabinet Knob
Shown in W3 Finish



CK-401 1"
Round Cabinet Knob
Shown in S1 Finish



CK-402 1 1/8"
Round Cabinet Knob
Shown in W1 Finish



CK-405 1 1/2"
Round Cabinet Knob
Shown in W3 Finish



CK-406 1 3/8"
Round Ridge Cabinet Knob
Shown in S3 Finish



CK-407 1 1/2"
Round Multi-Ridge Cabinet Knob
Shown in W2 Finish

CK-302 IN W1 FINISH



CK-408 1 1/4"
Round Ridge Cabinet Knob
Shown in S2 Finish

CABINET KNOB ESCUTCHEONS



CKE-RP1 1"
Round Cabinet Knob Escutcheon
Shown in W1 Finish



CKE-RP158 1 5/8"
Round Cabinet Knob Escutcheon
Shown in W3 Finish



CKE-RP175 1 3/4"
Round Cabinet Knob Escutcheon
Shown in S3 Finish



CKE-RP200 2"
Round Cabinet Knob Escutcheon
Shown in S1 Finish



CKE-1 1"
Square Cabinet Knob Escutcheon
Shown in S2 Finish



CKE-158 1 5/8"
Square Cabinet Knob Escutcheon
Shown in W1 Finish



CKE-175 1 3/4"
Square Cabinet Knob Escutcheon
Shown in W3 Finish



CKE-200 2"
Square Cabinet Knob Escutcheon
Shown in W2 Finish



CKE-FDL 6 1/4 x 1 1/4"
Fleur de Lis Cabinet Knob Escutcheon
Shown in W2 Finish



CKE-OP175 1 3/4" X 1"
Oval Cabinet Knob Escutcheon
Shown in W3 Finish



CKE-9-158 1 5/8"
Square Cabinet Knob Escutcheon
Shown in S1 Finish

CK-407 WITH CKE-FDL IN S3 FINISH



CONTEMPORARY CABINET KNOBS



CK-450 1"
Round Cabinet Knob
Shown in S1 Finish



CK-453 3/4"
Cabinet Knob
Shown in W1 Finish



CK-451 1 1/2"
Round Cabinet Knob
Shown in W2 Finish



CK-524 1 1/4"
Square Cabinet Knob
Shown in S3 Finish



CK-525 1 1/2"
Square Cabinet Knob
Shown in S1 Finish

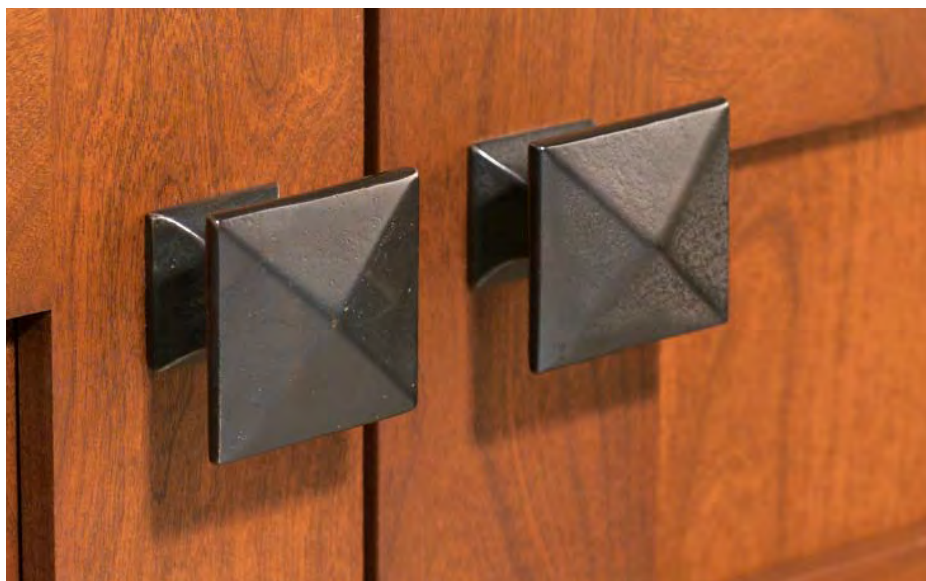

CK-524 IN W3 FINISH

BAMBOO KNOB & PULL



CK-1302 1 3/8" x 2 1/4"
Bamboo Cabinet Knob
Shown in S2 Finish



CK-1306 3 1/16" c to c
Bamboo Cabinet Pull
Shown in W3 Finish

CK-507 IN W2 FINISH



BIN PULLS



CK-507 4" x 1 1/2"
Bin Pull
Shown in W1 Finish



CK-508 5" x 2"
Bin Pull
Shown in S2 Finish



CK-606 5 3/4" x 2 1/2"
Bin Pull
Shown in S2 Finish

CK-507 WITH CK-401 IN W1 FINISH



EDGE MOUNT CABINET PULLS



CK-500R 2 5/8" x 3/16"
Edge Mount Cabinet Pull with Rolled Edge
Shown in S3 Finish



CK-500 2 5/8" x 5/8"
Edge Mount Cabinet Pull
Shown in W2 Finish



CK-501 4 1/8" x 5/8"
Edge Mount Cabinet Pull
Shown in W1 Finish

CABINET PULLS



SP-400 5" c to c
Surface Mount Sash Pull
Shown in S1 Finish



CK-915 4 11/16" c to c
Surface Mount Cabinet Pull
Shown in S2 Finish



CK-510 3 3/4" c to c
Round Foot Cabinet Pull
Shown in W2 Finish



CK-512 6 7/8" c to c
Round Foot Cabinet Pull
Shown in S1 Finish



CK-578 12" c to c
Large Round Foot
Cabinet Pull
Shown in W3 Finish



CK-512 IN W2 FINISH



CK-534 3 3/4" c to c
Square Handle Cabinet Pull
Shown in S1 Finish



CK-545 5" c to c
Large Square Handle Cabinet Pull
Shown in S2 Finish



CK-515 4 7/8" c to c
Square Foot Cabinet Pull
Shown in S2 Finish



CK-580 6 1/8" c to c
Large Square Foot Cabinet Pull
Shown in S1 Finish



CK-583 8 5/8" c to c
Large Square Foot Cabinet Pull
Shown in W1 Finish

L-SHAPED PULLS



CK-998RH 1 1/4" x 4 1/2" x 2 3/4"
L-Shaped Cabinet Pull
Shown in S1 Finish



CK-998LH 1 1/4" x 4 1/2" x 2 3/4"
L-Shaped Cabinet Pull
Shown in S3 Finish

CK-912 IN W1 FINISH



CONTEMPORARY CABINET PULLS



CK-910 3 7/8" c to c
Contemporary Cabinet Pull
Shown in W3 Finish



CK-911 4 7/8" c to c
Contemporary Cabinet Pull
Shown in W1 Finish



CK-9106 5" c to c
Contemporary Cabinet Pull
Shown in W2 Finish



CK-9112 11" c to c
Contemporary Cabinet Pull
Shown in S3 Finish



CK-910 IN W1 FINISH

CABINET LATCHES



CK-650 3 7/8" x 2 3/8"
Cabinet Latch
Shown in S3 Finish



CK-600RH 2" x 1 3/4"
Cabinet Latch
Shown in W1 Finish

FLAP & RING PULLS



CK-520 1" x 2"
Cabinet Flap Pull
Shown in S3 Finish



CK-101 1 3/8" x 1 3/4"
Cabinet Ring Pull
Shown in S3 Finish



CK-521 1 7/8" x 2 3/4"
Cabinet Ring Pull
Shown in W3 Finish

CK-600RH CABINET LATCH IN S2 FINISH





CUSTOM HARDWARE

From bronze clad gates to personalized plaques and unique entry systems, Sun Valley Bronze can create almost any custom hardware imaginable. Whether you have a sketch or a detailed drawing, our skilled pattern makers can help reproduce your design.

ORNATE



ORNATE ENTRY SET
SHOWN IN W3 FINISH

BASKET WEAVE SET



BASKET WEAVE ENTRY SET
SHOWN IN S3 FINISH



CUSTOM FLUSH MOUNT ENTRY SET WITH K-217 KNOB IN W2 FINISH

HAND-BLOWN GLASS KNOBS

FLY ROD ENTRY PULL IN S3 FINISH



RP-403 WITH K-503 JEWEL KNOB IN S2 FINISH



Glass knobs are made
exclusively for Sun Valley Bronze
by DeMoss Art Glass.
More options are available.

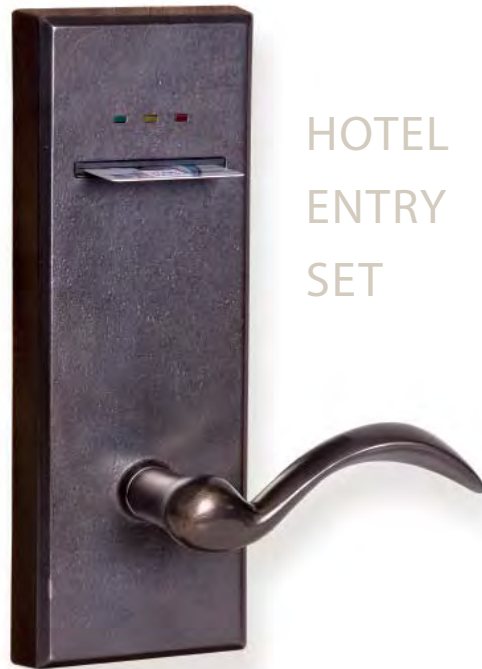

HOTEL
ENTRY
SET

The Hotel Collection is available with any
of our levers and in any of our finishes.

CUSTOM BRONZE LOGOS



CUSTOM BRONZE PLAQUE



CUSTOM LOGO

BRONZE GATE CLADDING WITH DK-8 IN S3 FINISH



SVB BOTTLE OPENER
SHOWN IN S2 FINISH

HAND PEENED COLLECTION



HAND PEENED PLATE AND KNOB
SHOWN IN S2 FINISH

TEXTURES COLLECTION



CS-1700HH 2 1/2" x 18"
Circles Collection Entry Set
Shown in W1 Finish



CS-1800HH 2 1/2" x 18"
Squares Collection Entry Set
Shown in S3 Finish



CS-1900HH 3 1/2" x 18"
Corduroy Collection Entry Set
Shown in W1 Finish



INLAY COLLECTION



CS-1610ML-PF 2 1/2" x 10"
Inlay Collection Entry Set
Shown with L-203 Flat Wood Handle Lever
in W1 Finish



GH-916 6"
Inlay Collection Grip Handle
Shown in W1 Finish



TECHNICAL ADVANCES

Innovation in design, both aesthetic and functional, is what keeps Sun Valley Bronze an inspired and constantly evolving company.

Precision machining and practical engineering ensure our products are of superior quality throughout. Sun Valley Bronze designs for longevity and lasting functionality, using only the finest grade bronze for castings and stainless steel for internal mechanisms.

Sun Valley Bronze internal spring assists and limiters are made of the highest quality stainless steel that will not corrode in humid or coastal climates. Teflon-coated for smooth operation, our stainless steel springs are an integral part of the technical advances, which ensure that Sun Valley Bronze hardware is built to last. Our revolutionary spring assist is so durable that it outlasted the cycle tester; the tester itself failed at 1.5 million cycles.

Careful attention to detail makes our hardware FIELD REVERSIBLE and FIELD SERVICEABLE, setting Sun Valley Bronze apart in the industry. Our entry sets are interchangeable from active to dummy function and feature reversible handing. All machining is performed on state-of-the-art equipment, capable of meeting tolerances to 1/10,000th of an inch, producing uncompromised quality and lifelong performance.



HARDWARE
AS BEAUTIFUL
ON THE INSIDE
AS IT IS ON
THE OUTSIDE

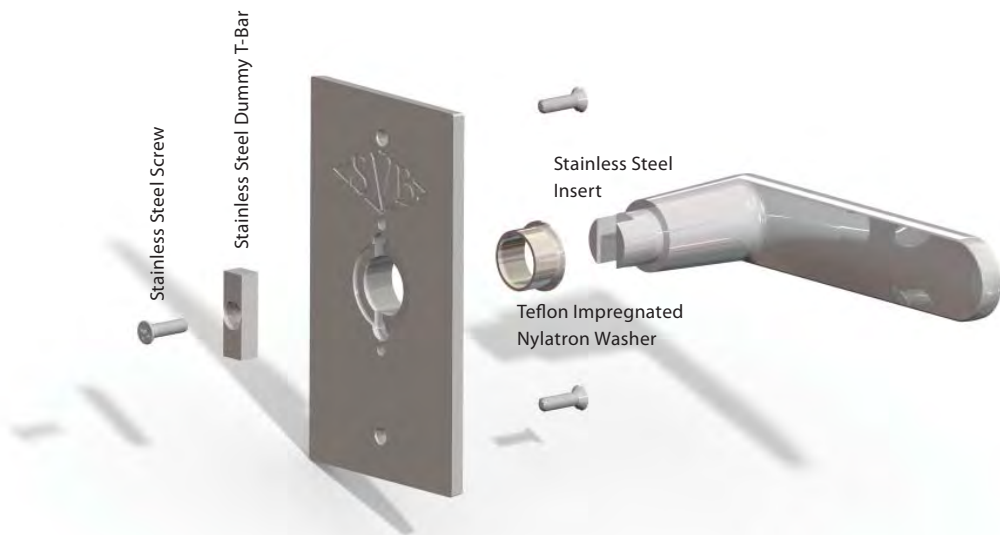

DUMMY SYSTEM

- Field reversible.
- Interchangeable from active to dummy function.
- All components are stainless steel to resist corrosion and wear.

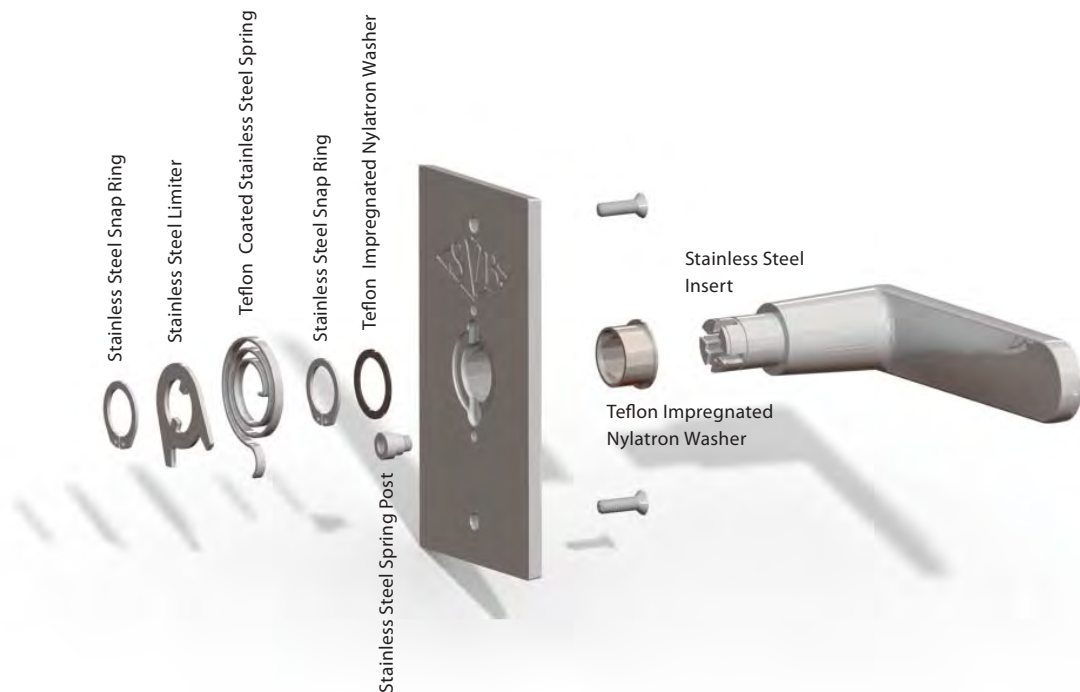

SPRING ASSIST

- Field reversible.
 - Interchangeable from active to dummy function.
 - All components are stainless steel to resist corrosion and wear.
 - Spring is teflon coated to resist squeaking.
 - Available with 2 spring strengths: regular and heavy duty.
 - Tested to over 1.5 million cycles before the cycle tester failed.
- The spring assist could have kept going.

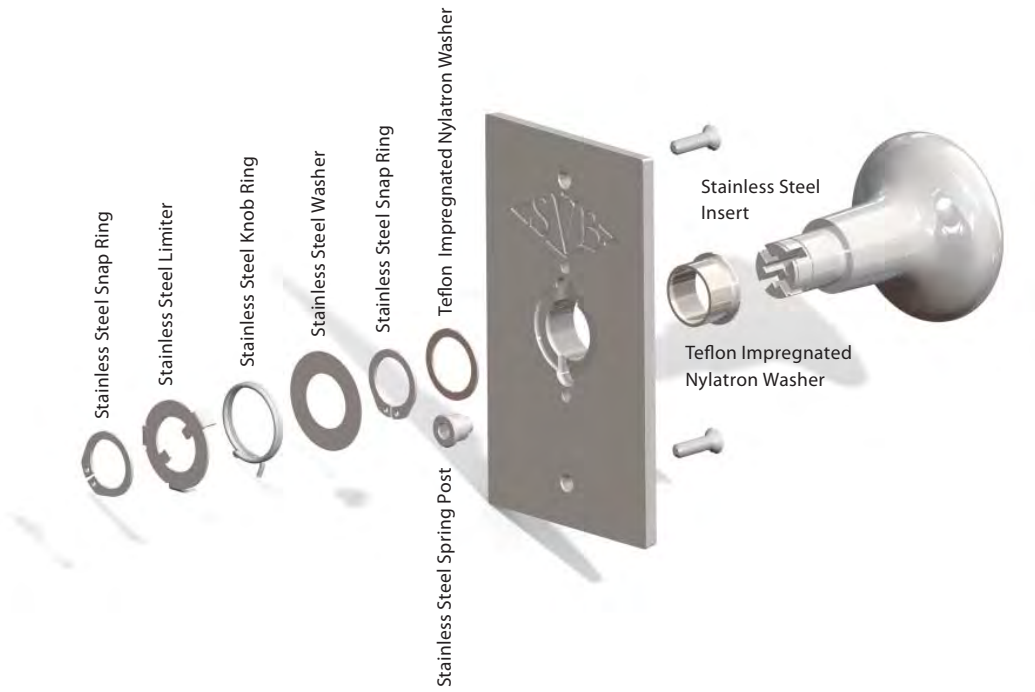

KNOB ASSEMBLY

- Field reversible.
- Interchangeable from active to dummy function.
- All components are stainless steel to resist corrosion and wear.
- Can be used with levers for multi-point lock applications.



HINGE ASSEMBLY

- Stainless steel ball bearing.
- Low friction, smooth operation.
- Adjustable.



MADE TO ORDER

All Sun Valley Bronze hardware is custom manufactured for each order.

EXPERT ASSISTANCE

Sun Valley Bronze showrooms provide assistance with planning, ordering, and specifying all hardware components to meet your special needs. They are trained in installation procedures and adept at on-site problem solving. Depending upon your project, or mechanical inclination, your representative will recommend skilled installers.

CUSTOMER SERVICE

While our showrooms provide local support and expertise for your project, the team at Sun Valley Bronze is always available to answer questions, replace lost parts, or walk you through an installation.

EXPERIENCE THE EVOLUTION

Sun Valley Bronze is constantly expanding our collection of hand-crafted solid bronze hardware with new and original design ideas. Please contact a representative near you to learn more about our latest projects.

SUN VALLEY BRONZE

Mail to: Post Office Box 3475, Hailey, Idaho 83333

Ship to: 706 South Main Street, Bellevue, Idaho 83313

Toll free: 866.788.3631

Fax: 208.788.1306

www.svbronze.com

Special thanks to Hawley Graphics, Balance Productions - Tim Brown, Kevin Syms Photography,
F. Charles Photography, Paul Schraub Photography, Fred Lindholm Photography, Sophia Wallace Photography
Printing by ColorGraphics



Recycled