

Package Contents

1. 1 x Worktop Socket & Power Cord w/ 10A Plug
2. 1 x Template
3. Fixture instructions



Important Safety Information

Please read these instructions carefully before attempting to install this product. It is advisable to keep these instructions in a safe place for further reference. **We recommend that you consult a qualified electrician.** These products must not be modified; if any modifications are made, it may invalidate the warranty and may render the product unsafe. **Do not wire the fixture directly to line power. This product is for indoor use only. Keep out of moisture.**

CAUTION: To reduce the risk of fire, electric shock, or injury to persons:

- a) Use only insulated staples or plastic ties to secure cords;
- b) Route and secure cords so that they will not be pinched or damaged when the unit is in place;

The National Electrical Code (NEC) does not permit cords to be concealed where damage to insulation may go unnoticed. To prevent fire danger, do not run cord behind walls, ceilings, or soffits where it may be inaccessible for examination. Cords should be visually examined periodically and immediately replaced when any damage is noted.

CAUTION: For indoor use only at temperature above 0°C.

Risk of Electric Shock: Do not plug into another relocatable power tap.

Safety Instructions

Minimum installation distance from edge of worktop is .98 inches (25mm).

Install on smooth, flat surfaces only. Do not install over jointed or uneven surfaces (e.g., tiles, melamine joints, etc.)

Users must not bend the handles beyond their natural vertical position, and both handles should be returned to their resting positions when pushing the unit down.

If the external cable of this product is damaged, contact the manufacturer / service agent for a replacement (subject to terms).

This is a Class 1 product. Must be grounded.

Care should be taken to prevent the possibility of water ingress into the unit during use. Please ensure unit is not located near a water supply and is fully grounded.

An external ground connection is provided next to the cable exit at the bottom of the unit. For added protection, it is advisable to connect an additional earth lead from this point to any well-grounded point near the unit. Ensure sufficient slack is available for this lead to allow the unit to operate correctly.

Installation

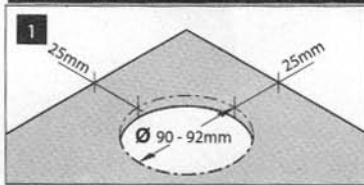

Cut out 90-92mm Diameter hole in work surface. Allow minimum 25mm clearance around the cut hole. When choosing location, select a surface between 10mm and 50mm thick.

ATTENTION: Ensure there is sufficient space under the installation surface for the unit when it retracts to the closed position.

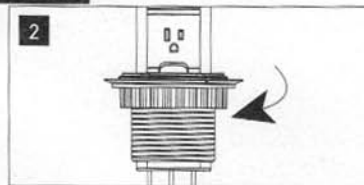

The locking ring with rubber washer is supplied in the packaging. If attached to the mounting collar, remove it by rotating it in a counter-clockwise direction prior to lowering the unit into its final location.

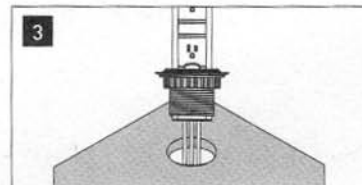

Insert socket into hole.

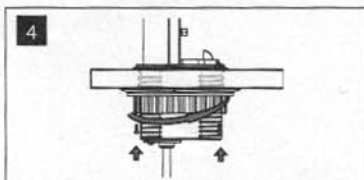

Place locking ring into collar. Identify and align arrows on the collar and locking ring to ensure the thread is engaged properly. Turn the locking ring clockwise to tighten. Make sure rubber washer is compressed tightly on underside of surface. Tighten the screw until ring firmly grips the surface.

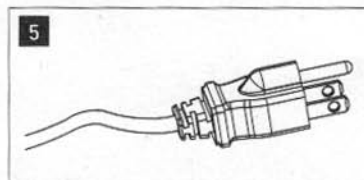

Connect cable to power supply, once work has been completed correctly. The product is now ready to use.