

1 Set sliding door fittings Unotec Home

2 Guide rail

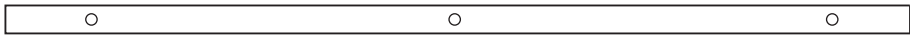

3 Door stoppers

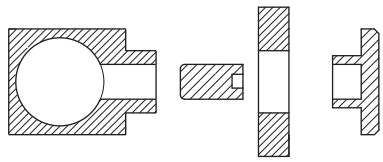

5 Wall fixtures

5/16"-18UNC

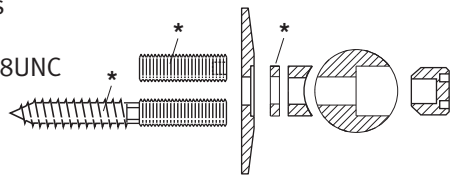

(without screws and dowels, at construction site)
* not included in scope of delivery.

6 Special tool

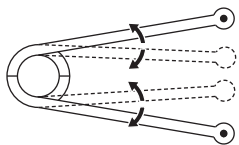

7 Bottom guide

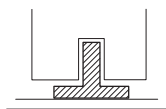

(without dowels and screws, at construction site)

Set Unotec Home Art. No.	Set / Each					
	2	3	4	5	6	7
USU35-1800EF	1	2	2	3	1	1
USU35-2100EF	1	2	2	4	1	1
USU35-2300EF	1	2	2	4	1	1
USU35-2540EF	1	2	2	4	1	1

Beyerle US L.L.C., ABP-Beyerle, it's subsidiaries and agents are not responsible or liable for damage or injury to any persons or property due to improper installation of it's products.
All liabilities reside solely with the installer.

ABP  **beyerle**

Beyerle US L.L.C.
1294 Logan Circle NW, Atlanta, GA 30318
Phone (404) 350-9738, Fax (404) 355-0166, www.beyerle-us.com

4 Trolley complete

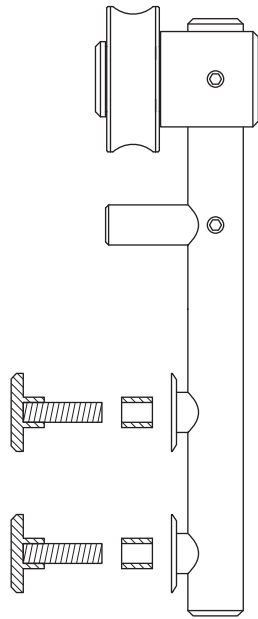

 Comply with all general safety regulations when installing the sliding door fittings!

Installation to be completed by qualified licensed contractor.

Be sure to tighten all screw connections one week after starting to use the sliding door fittings!

Never use scouring agents to clean the sliding door fittings; rather use commercially available stainless-steel cleaners!



Attention



Screw on



Screw on



Screw on



Loosen / Tighten



Install



At right angle



Drill



Dowels



Adjust Set



Level



Perpendicular



Measure Mark



Visual inspection



Special-tool



2 people required



Measure



Clarify questions



See instructions



Secure

Installation instructions

Sliding door fittings Unotec Home

for wooden doors (max. 1 3/4" thickness)

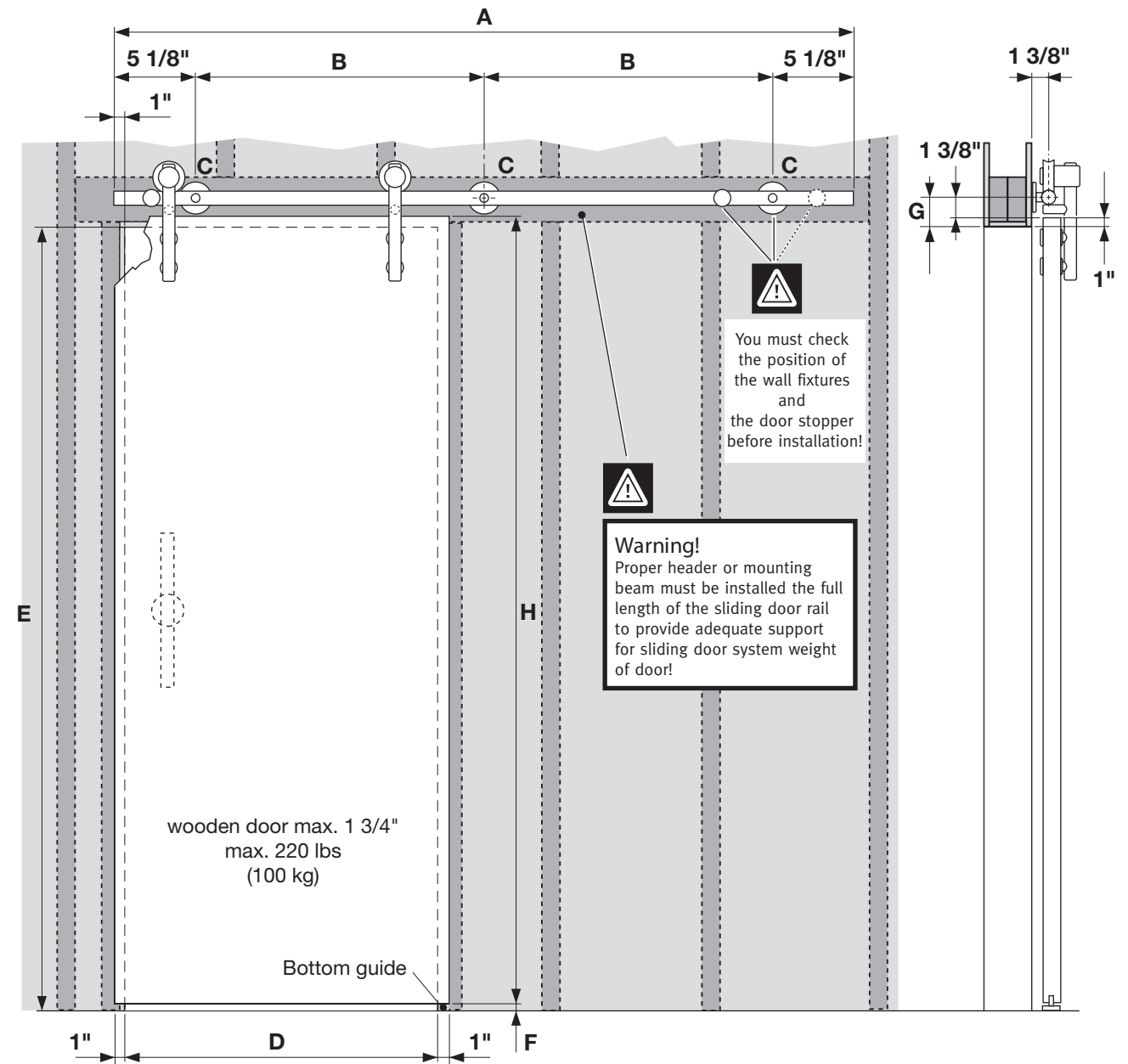

Complete-sets

Set Unotec Home Art. No.	A inch	B inch	C Each	D inch	E max. inch	F inch	G inch	H max. inch (H = E - F + 1")
USU35-1800EF	70 7/8"	30 5/16"	3	29 1/2" - 35 7/16"	98 7/16"	1/4" - 3/8"	2 3/8"	99 1/8"
USU35-2100EF	82 11/16"	24 1/8"	4	35 13/16" - 39 3/8"	98 7/16"	1/4" - 3/8"	2 3/8"	99 1/8"
USU35-2300EF	90 9/16"	26 3/4"	4	39 3/4" - 44 1/16"	98 7/16"	1/4" - 3/8"	2 3/8"	99 1/8"
USU35-2540EF	100"	29 15/16"	4	44 1/2" - 49 3/16"	98 7/16"	1/4" - 3/8"	2 3/8"	99 1/8"

Right to make technical changes reserved - Dimensions in inches - Version 02.2012
© by ABP-Beyerle GmbH

ABP  **beyerle**

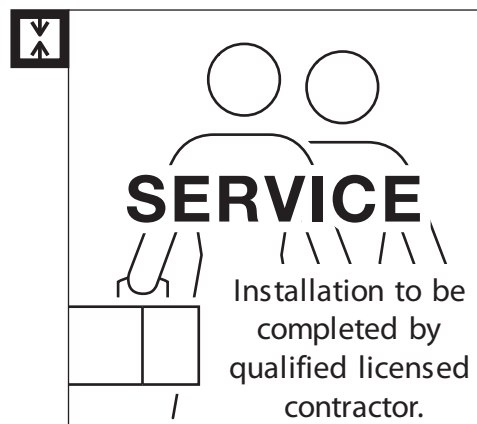

Fig. 1

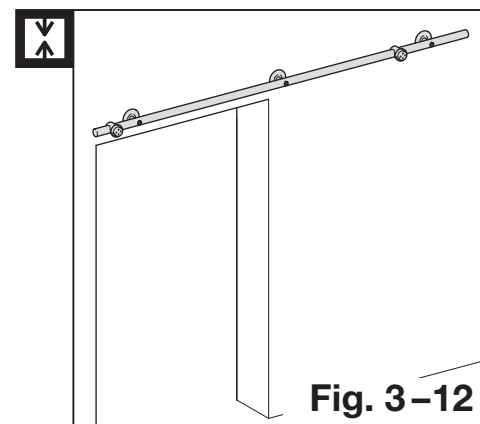

Fig. 2

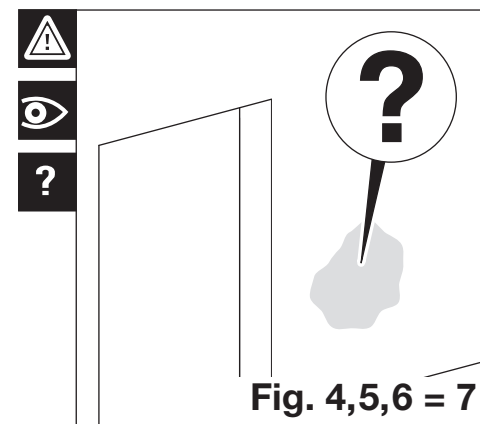

Fig. 3

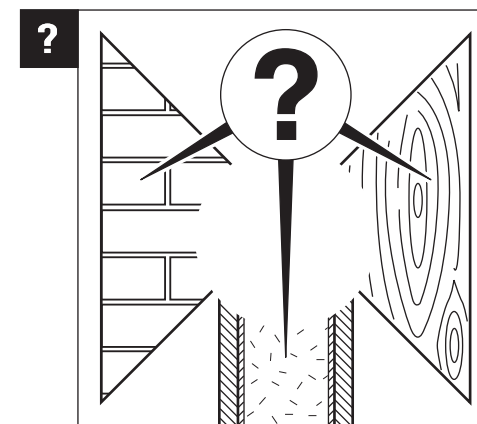

Fig. 4

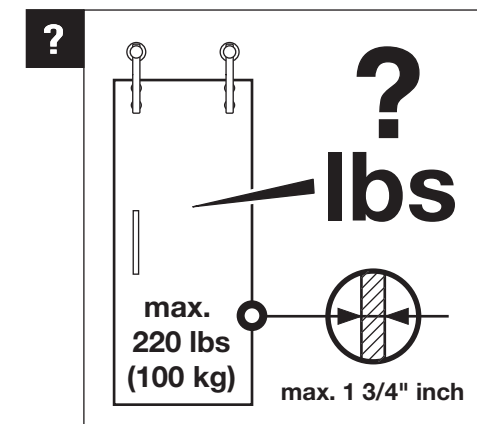

Fig. 5

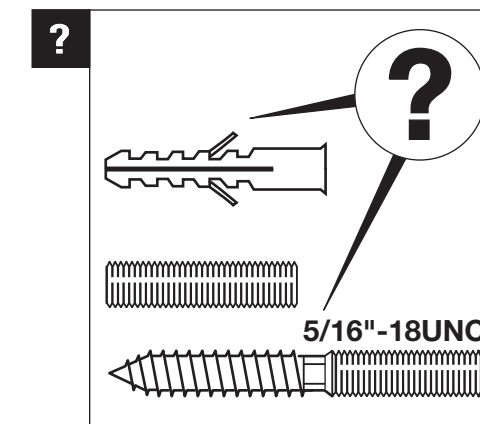

Fig. 6

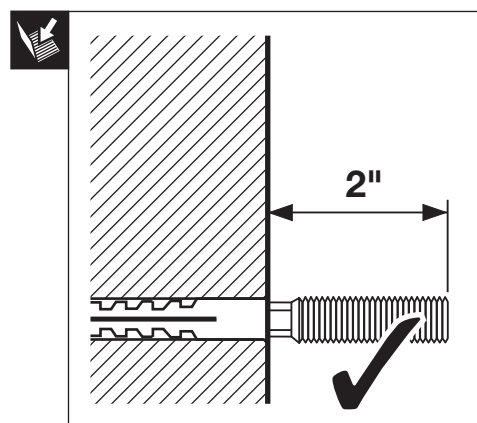

Fig. 7

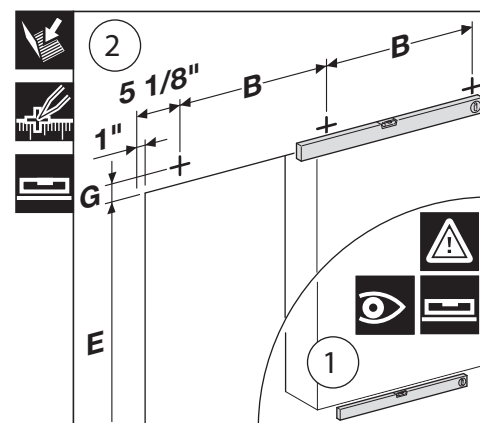

Fig. 8

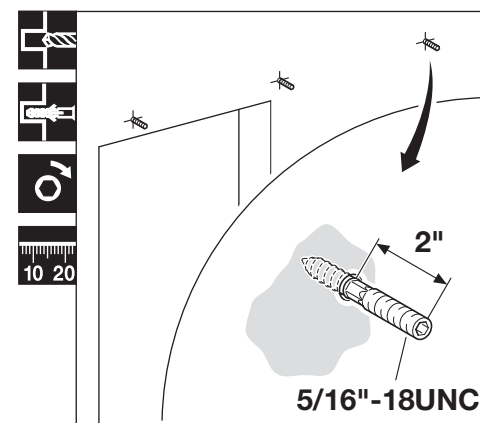

Fig. 9

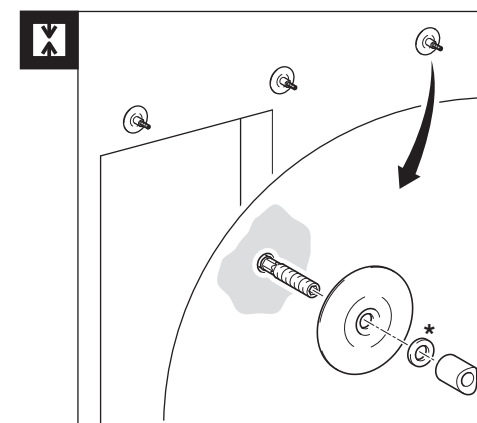

Fig. 10

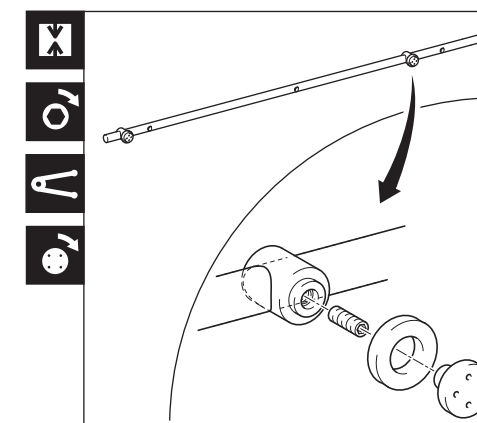

Fig. 11

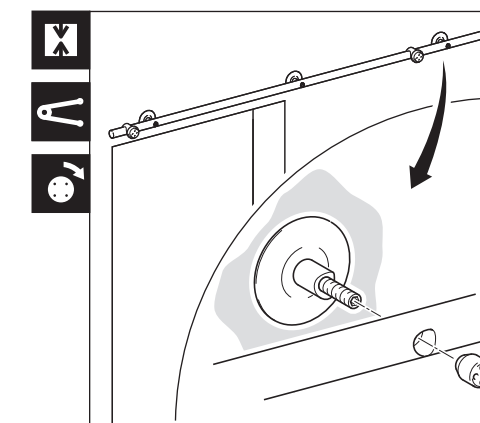

Fig. 12

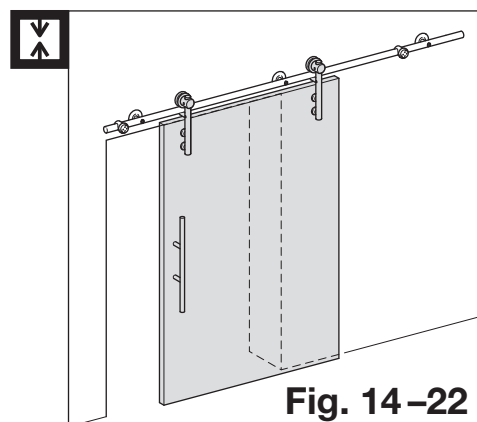

Fig. 13

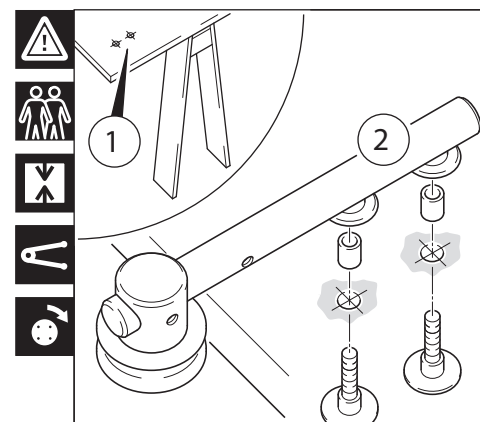

Fig. 14

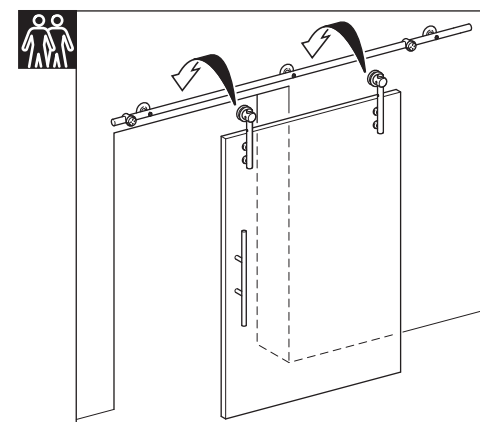

Fig. 15

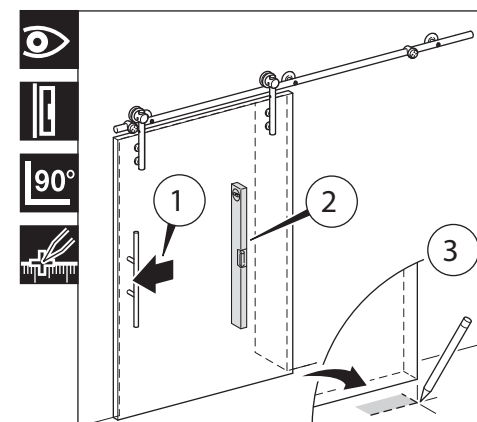

Fig. 16

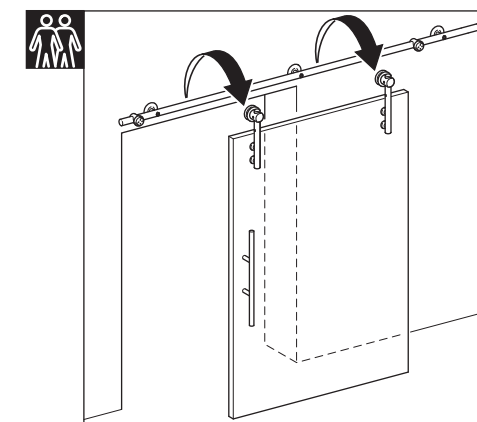

Fig. 17

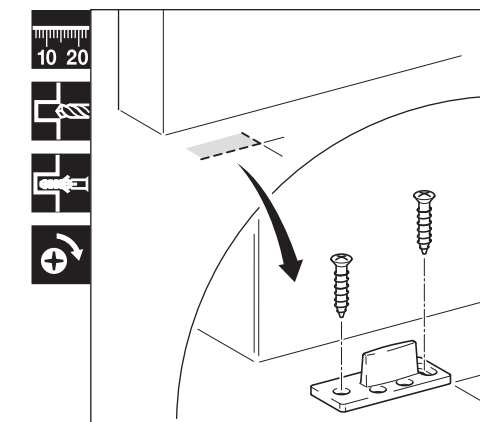

Fig. 18

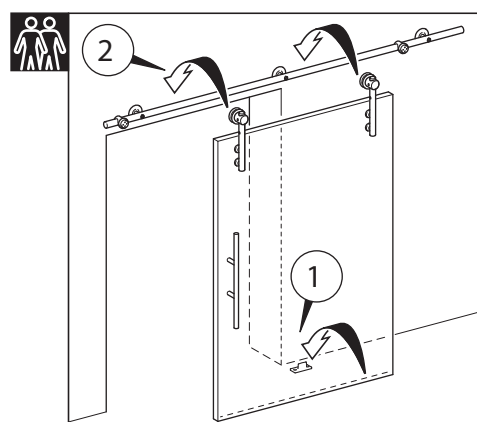

Fig. 19

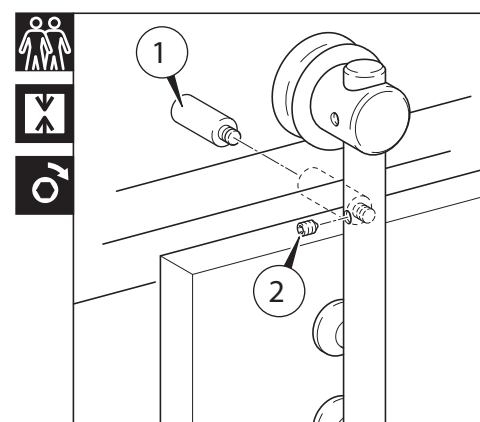

Fig. 20

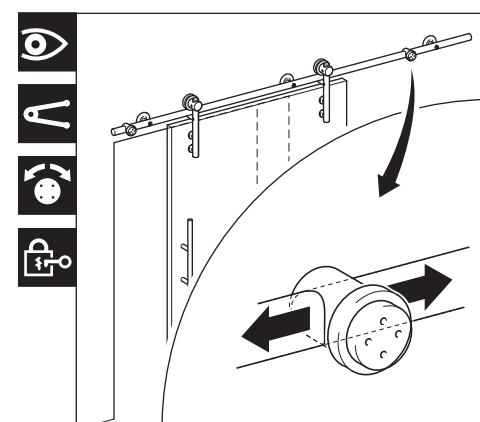

Fig. 21

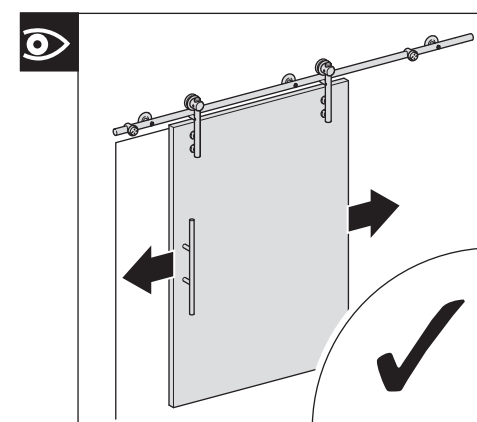
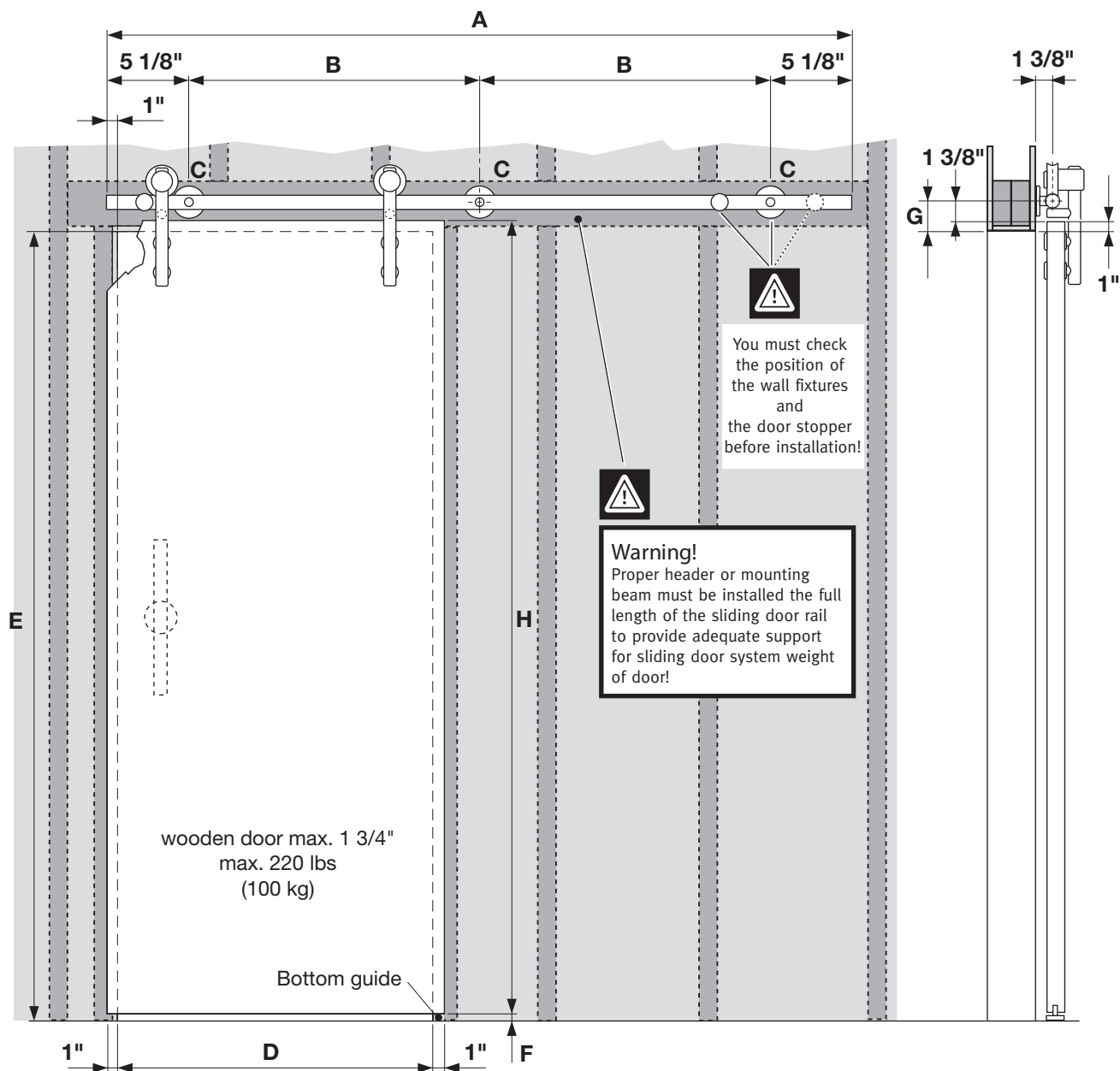

Fig. 22

Planning guide

Sliding door fittings Unotec Home for wooden doors (max. 1 3/4" thickness)



Complete-sets

Set Unotec Home Art. No.	A inch	B inch	C Each	D inch	E max. inch	F inch	G inch	H max. inch (H = E - F + 1")
USU35-1800EF	70 7/8"	30 5/16"	3	29 1/2" - 35 7/16"	98 7/16"	1/4" - 3/8"	2 3/8"	99 1/8"
USU35-2100EF	82 11/16"	24 1/8"	4	35 13/16" - 39 3/8"	98 7/16"	1/4" - 3/8"	2 3/8"	99 1/8"
USU35-2300EF	90 9/16"	26 3/4"	4	39 3/4" - 44 1/16"	98 7/16"	1/4" - 3/8"	2 3/8"	99 1/8"
USU35-2540EF	100"	29 15/16"	4	44 1/2" - 49 3/16"	98 7/16"	1/4" - 3/8"	2 3/8"	99 1/8"

Sliding door fittings Unotec Home

for wooden doors (max. 1 3/4" thickness) - 1 wooden door

Manufacturing dimensions (special model)													
inches		Each	inches						H	kg	Each		
A	B	C	D	D1	E	F	G	H	Load-bearing capacity of the guide rail	J	L	M	N
					max. 98 7/16"	1/4" - 3/8"		max. 99 1/8" (H = E - F + Y)					
							(2 3/8")				1	2	2

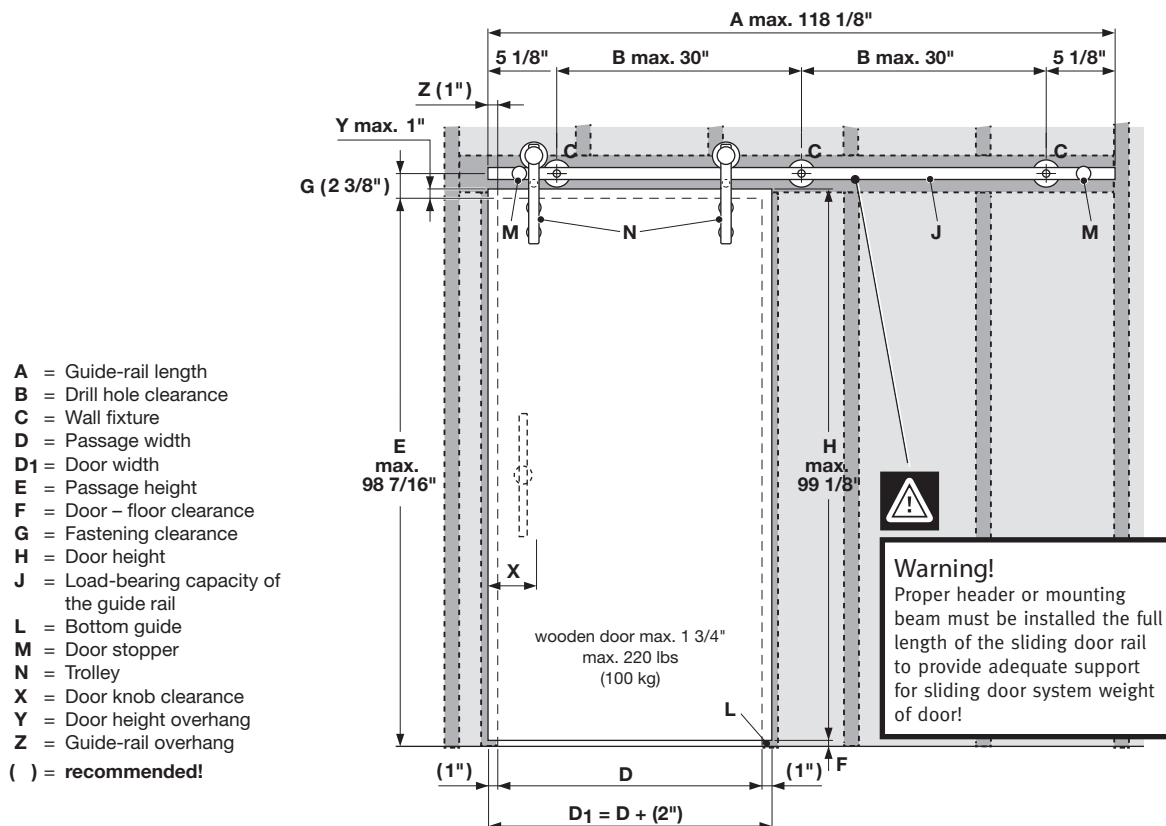

Calculation for guide-rail length A

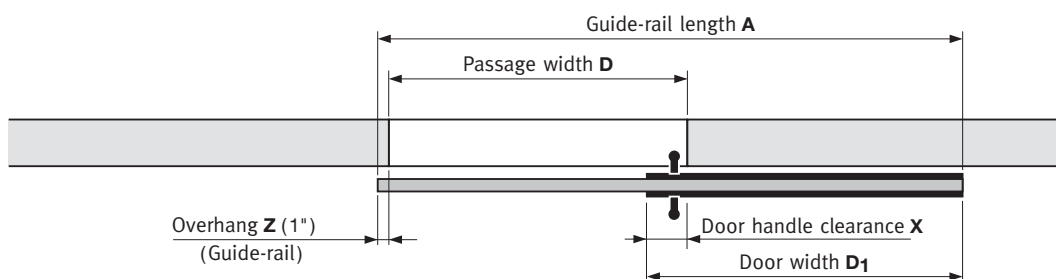

Make door handle clearance so that fingers do not get pinched when the door is manipulated! See page 5.

Sliding door fittings Unotec Home

for wooden doors (max. 1 3/4" thickness) - 2 wooden doors

Manufacturing dimensions (special model)																
inches			Each	inches							H	kg	Each			
A	B1	B2	C	D	D1	D2	E max. 98 7/16"	F 1/4" - 3/8"	G	max. 99 1/8" (H = E - F + Y)	Load-bearing capacity of the guide rail J	K	L	M	N	
									(2 3/8")			1	2	4	4	

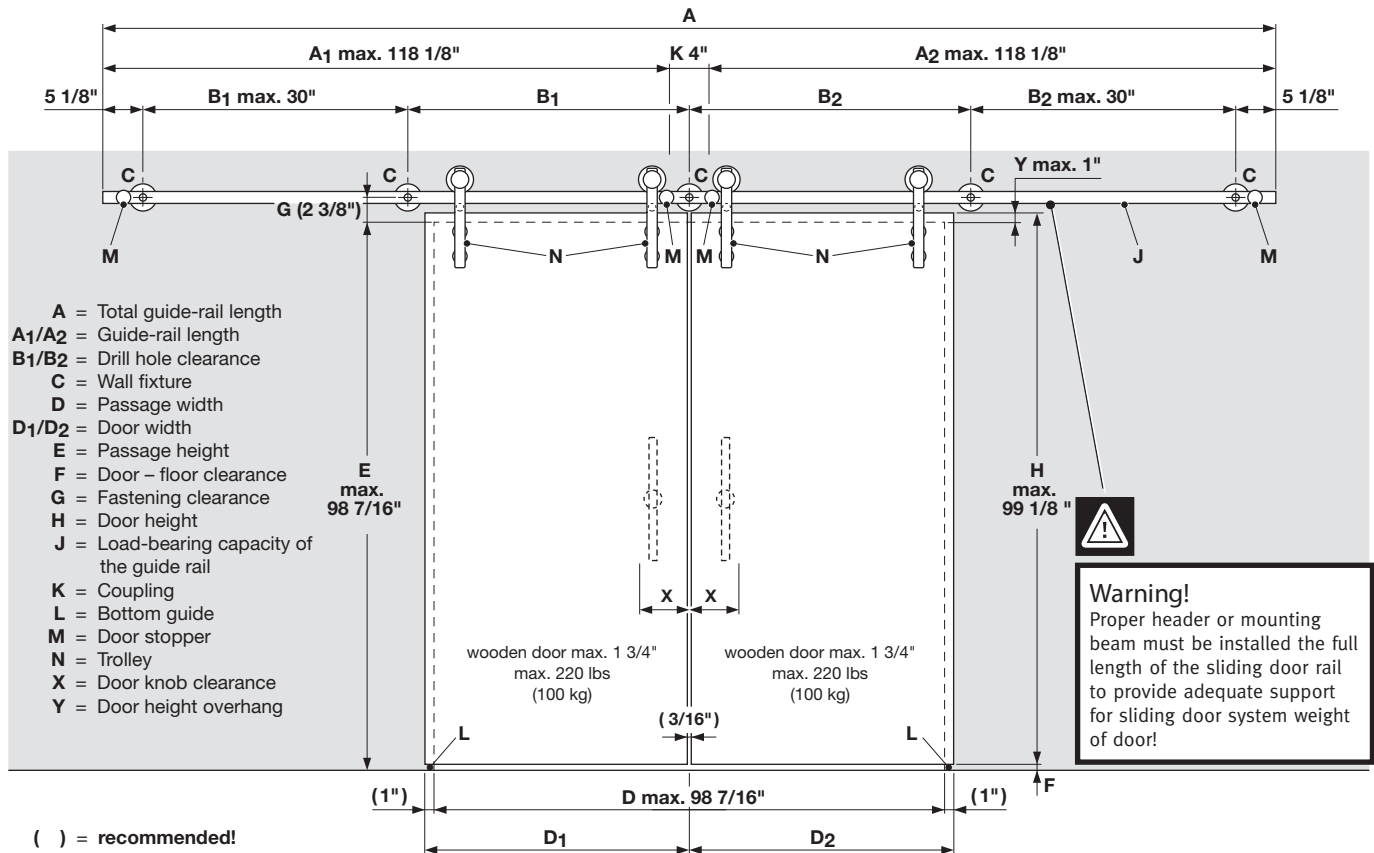

Calculation for total guide-rail length A

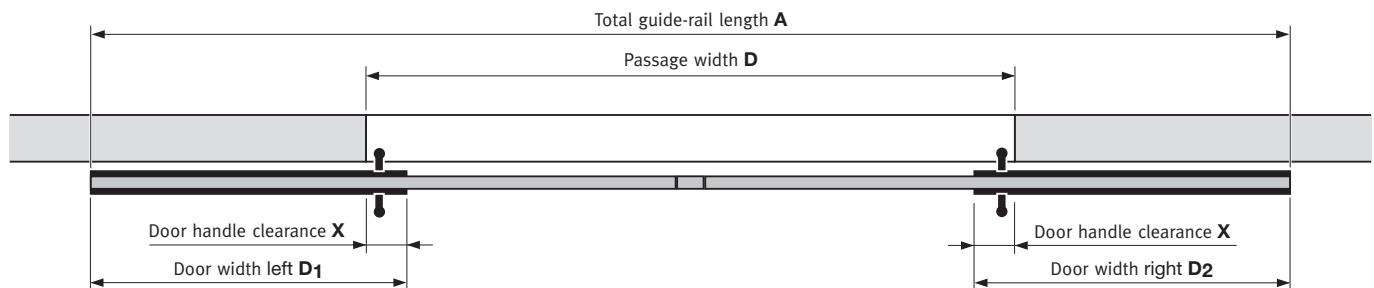

Door width D1 - Door handle clearance X + Passage width D + Door width D2 - Door handle clearance X = Total guide-rail length A



Make door handle clearance so that fingers do not get pinched when the door is manipulated! See page 5.

Sliding door fittings Unotec Home

for wooden doors (max. 1 3/4" thickness) - Wall fixture

Standard installation

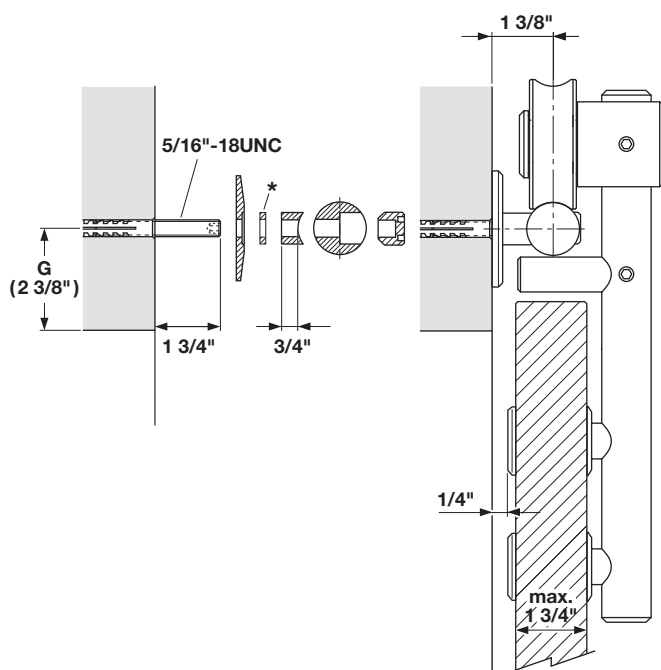

Installation with baseboards and trim

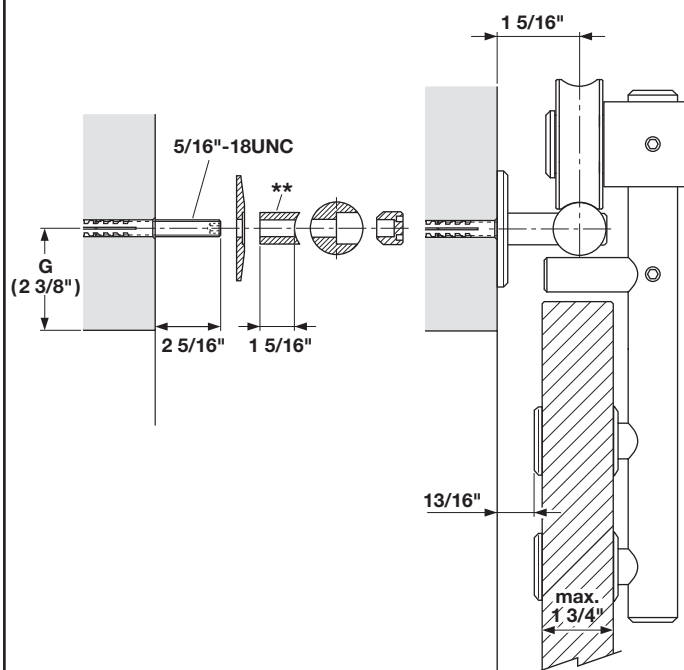

* Compensation disks 1/16", 3/16" and 3/8"
To compensate for wall unevenness,
order separately.
(Only 1 piece per wall fixture!)

	Art.-No.	inches
	USO216-2EF	1/16"
	USO216-5EF	3/16"
	USO216-10EF	3/8"

** Spacers order separately.

	Art.-No.	inches
	USO226-33EF	1 5/16"

Sliding door fittings Unotec Home

for wooden doors (max. 1 3/4" thickness)

Preparation of wooden door

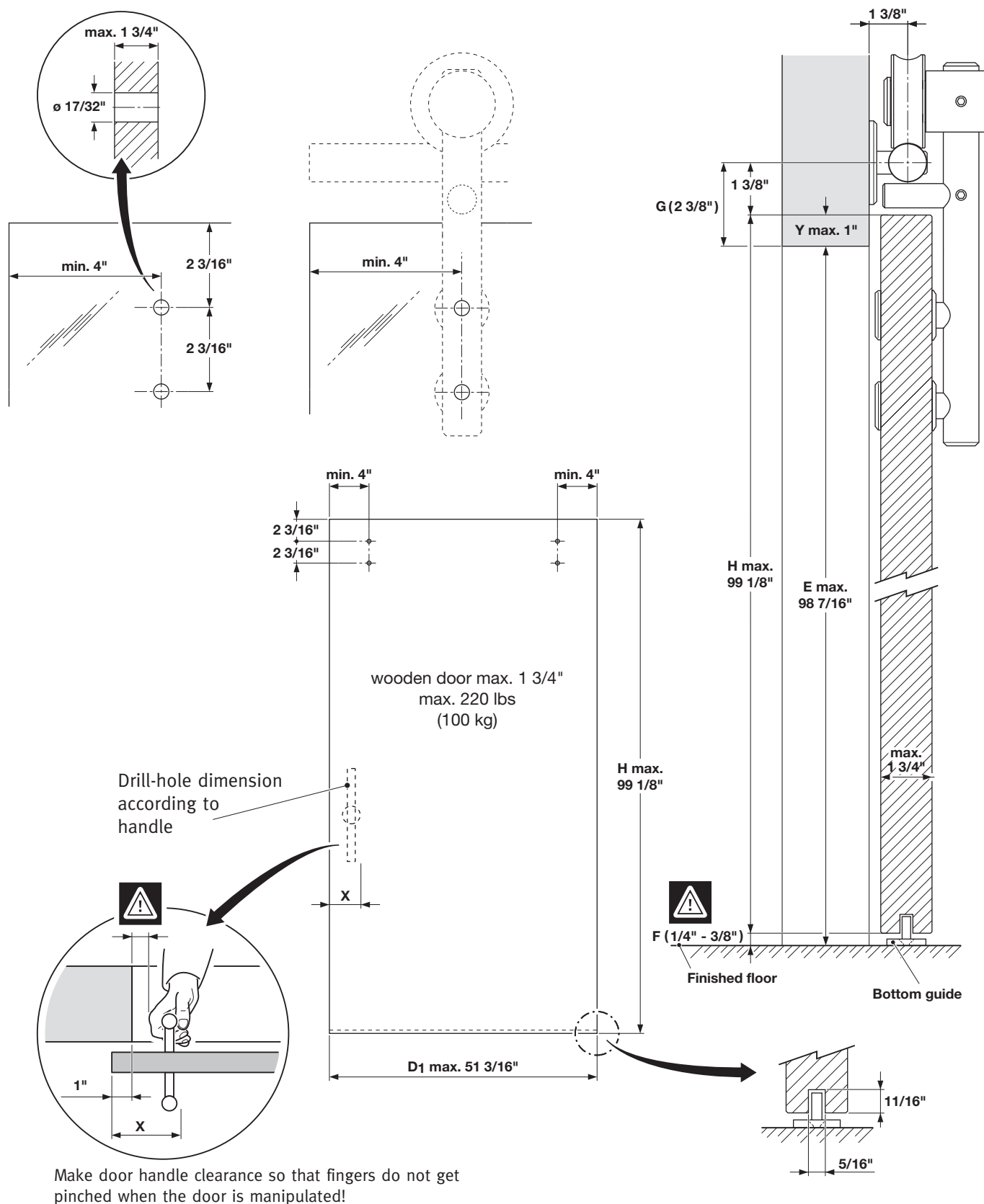

Sliding door fittings Unotec Home

for wooden doors (max. 1 3/4" thickness)

Required system parts

Please refer to the catalogue for article no's and models!

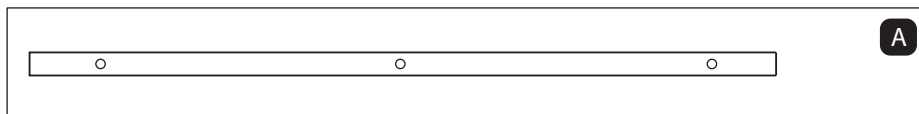

A

Guide rail Ø 1" inch

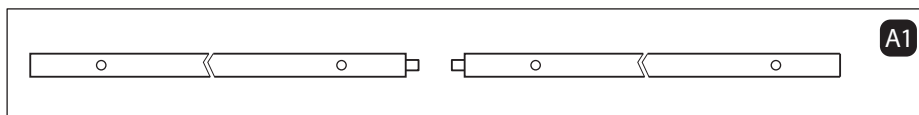

A1

Guide rail Ø 1" inch
for guide rail couplings

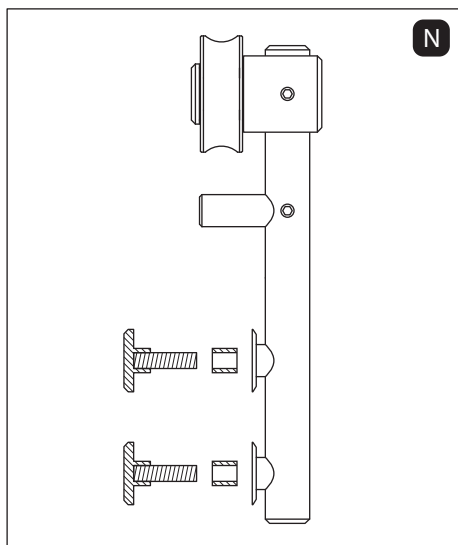

N

Trolley complete

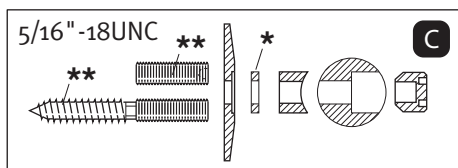

C

Wall fixtures complete

** Without screws and dowels, at construction site
* Compensation disks * 1/16", 3/16" and 3/8" order separately

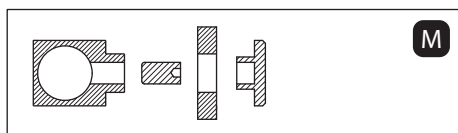

M

Door stoppers complete, stainless steel

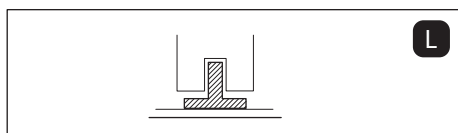

L

Bottom guide, plastic
(Without screws and dowels, at construction site)

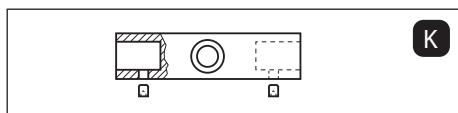

K

Guide rail coupling Ø 1" inch

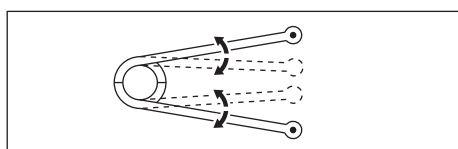

Special tool