

1Set sliding door fittings Tritec

2Guide rail

3Door stoppers

5Wall fixtures

6Special tool

7Bottom guide

4Trolley complete

5/16"-18UNC

(without screws and dowels, at construction site)

* not included in scope of delivery.

(without dowels and screws, at construction site)

Set Tritec Art. No.	Set / Each						
1	2	3	4	5	6	7	
USU65-1800EF	1	2	2	3	1	1	
USU65-2100EF	1	2	2	4	1	1	
USU65-2300EF	1	2	2	4	1	1	
USU65-2540EF	1	2	2	4	1	1	

Beyerle US L.L.C., ABP-Beyerle, it's subsidiaries and agents are not responsible or liable for damage or injury to any persons or property due to improper installation of it's products.
All liabilities reside solely with the installer.

Beyerle US L.L.C.
1294 Logan Circle NW, Atlanta, GA 30318
Phone (404) 350-9738, Fax (404) 355-0166, www.beyerle-us.com

! Comply with all general safety regulations when installing the sliding door fittings!

Installation to be completed by qualified licensed contractor.

Be sure to tighten all screw connections one week after starting to use the sliding door fittings!

Never use scouring agents to clean the sliding door fittings; rather use commercially available stainless-steel cleaners!

- !** Attention
- +** Screw on
- +** Screw on
- +** Screw on
- +** Loosen / Tighten
- !** Install
- 90°** At right angle
- +** Drill
- +** Dowels
- +** Adjust Set
- +** Level
- +** Perpendicular
- +** Measure Mark
- +** Visual inspection
- A** Special-tool
- +** 2 people required
- +** Measure
- ?** Clarify questions
- +** See instructions
- +** Secure

USU65_Mont_US

Installation instructions

Sliding door fittings Tritec

for wooden doors (max. 1 3/4" thickness)

Diagram illustrating the installation of sliding door fittings Tritec for wooden doors (max. 1 3/4" thickness). The diagram shows the door frame, guide rail, and various components (A, B, C, D, E, F, G, H) with dimensions in inches. Key dimensions include: A (total width), B (distance between rollers), C (roller diameter), D (door width), E (door height), F (bottom guide offset), G (door stopper offset), and H (door thickness). The diagram also shows the door stoppers, wall fixtures, and the bottom guide. A warning box states: "Warning! Proper header or mounting beam must be installed for the full length of the sliding door rail to provide adequate support for sliding door system weight of door!"

Complete-sets

Set Tritec Art. No.	A inch	B inch	C Each	D inch	E max. inch	F inch	G inch	H max. inch (H = E - F + 1")
USU65-1800EF	70 7/8"	30 5/16"	3	29 1/2" - 35 7/16"	98 7/16"	1/4" - 3/8"	2 3/8"	99 1/8"
USU65-2100EF	82 11/16"	24 1/8"	4	35 13/16" - 39 3/8"	98 7/16"	1/4" - 3/8"	2 3/8"	99 1/8"
USU65-2300EF	90 9/16"	26 3/4"	4	39 3/4" - 44 1/16"	98 7/16"	1/4" - 3/8"	2 3/8"	99 1/8"
USU65-2540EF	100"	29 15/16"	4	44 1/2" - 49 3/16"	98 7/16"	1/4" - 3/8"	2 3/8"	99 1/8"

Right to make technical changes reserved - Dimensions in inches - Version 02.2012
© by ABP-Beyerle GmbH

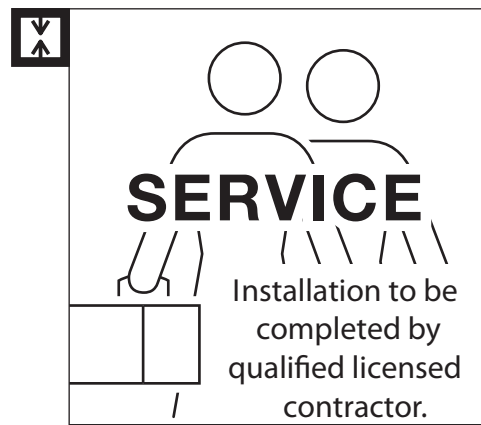

Fig. 1

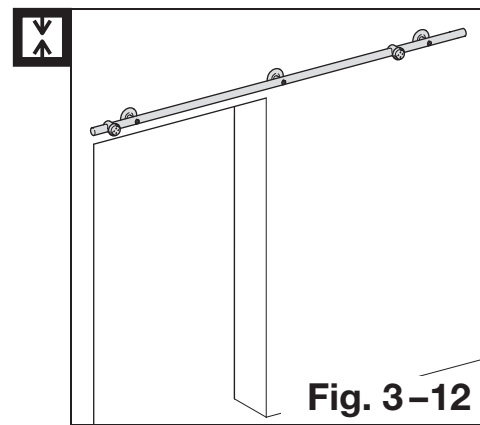

Fig. 2

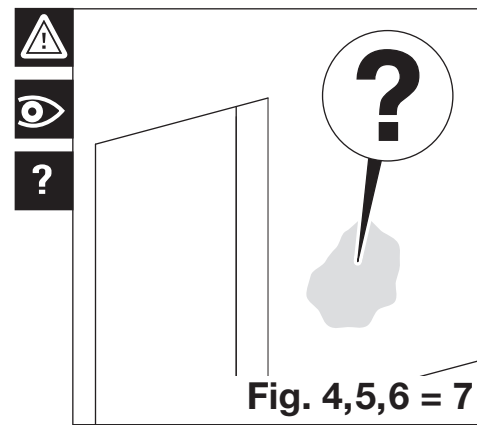

Fig. 3

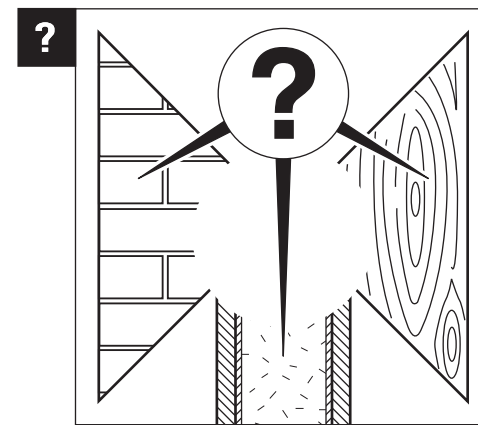

Fig. 4

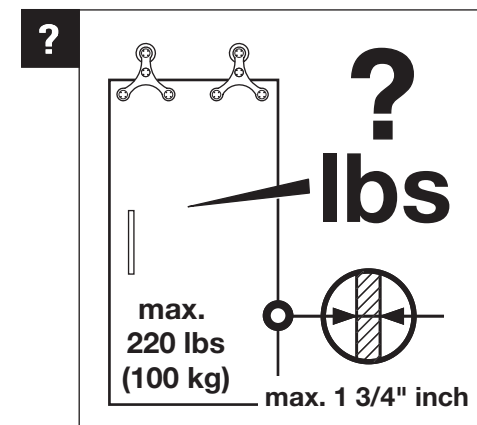

Fig. 5

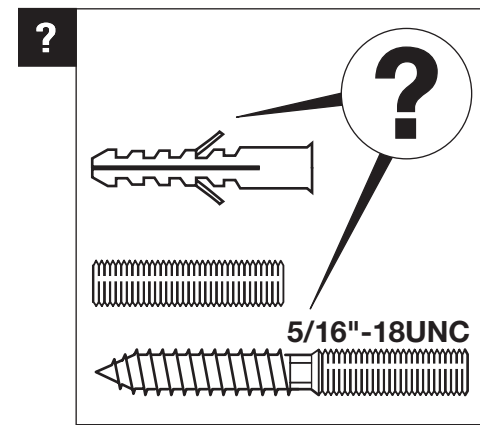

Fig. 6

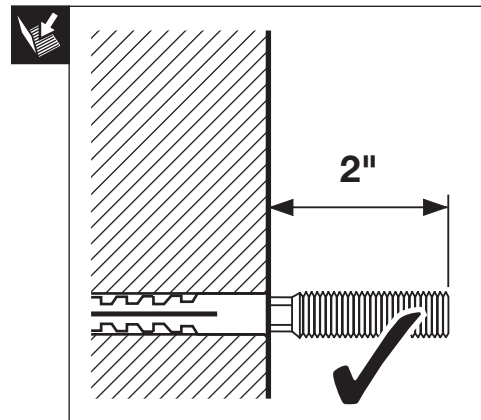

Fig. 7

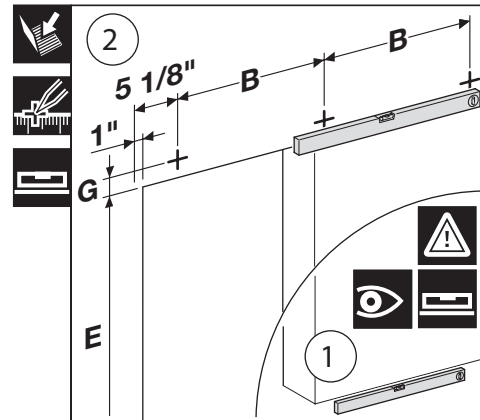

Fig. 8

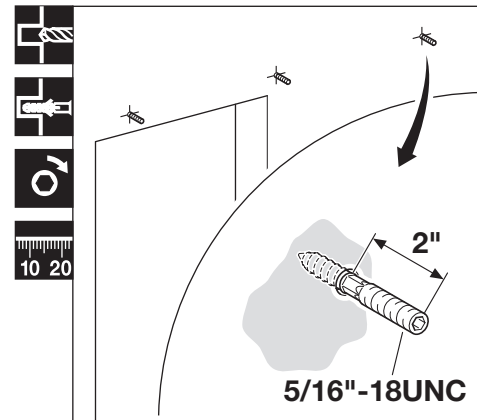

Fig. 9

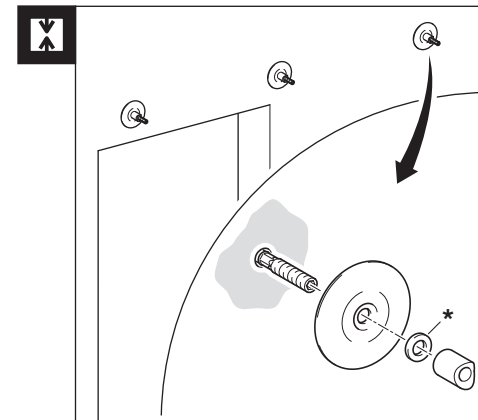

Fig. 10

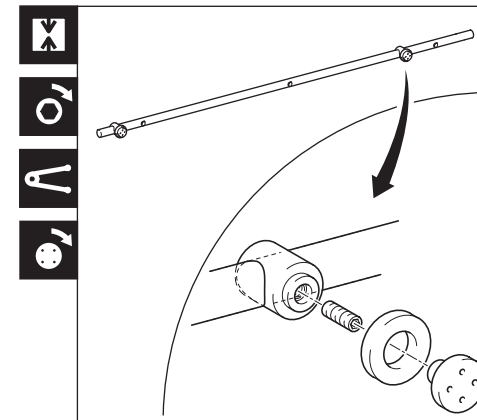

Fig. 11

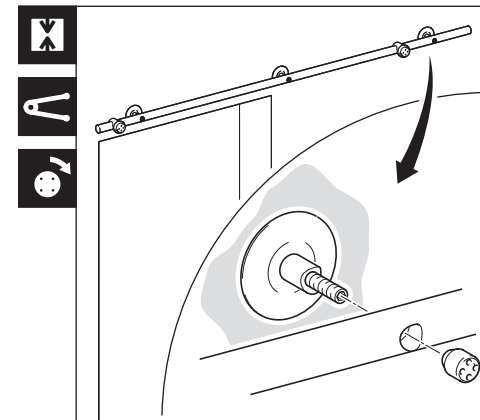

Fig. 12

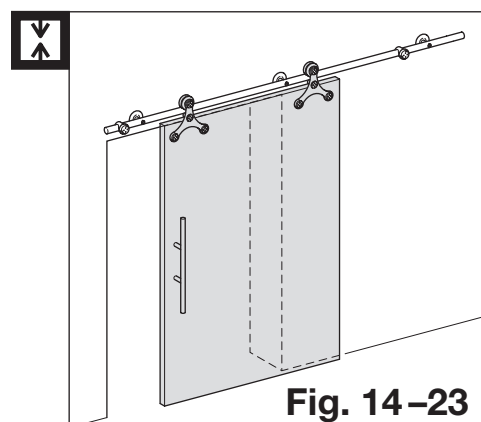

Fig. 13

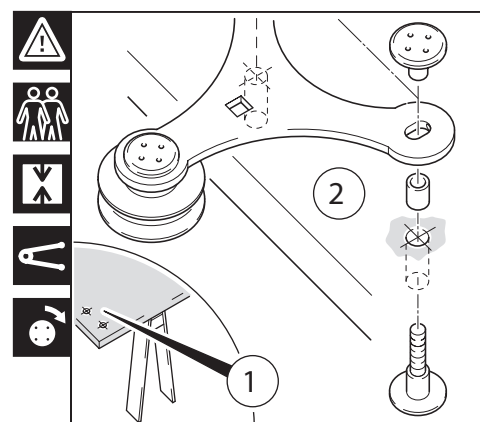

Fig. 14

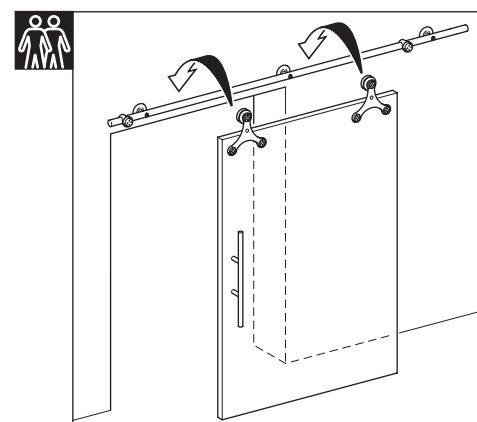

Fig. 15

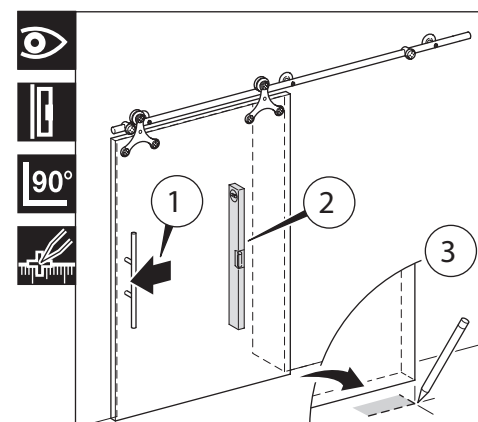

Fig. 16

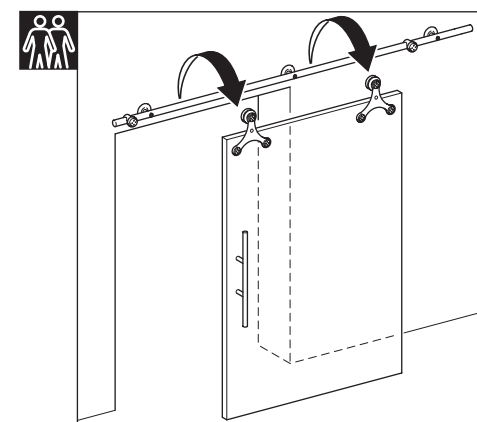

Fig. 17

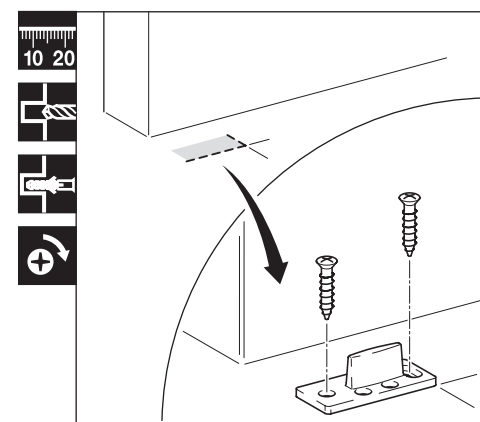

Fig. 18

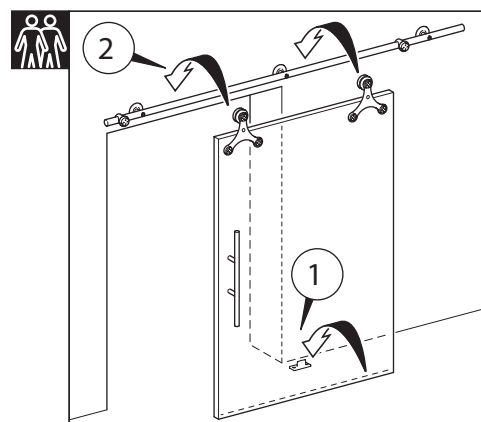

Fig. 19

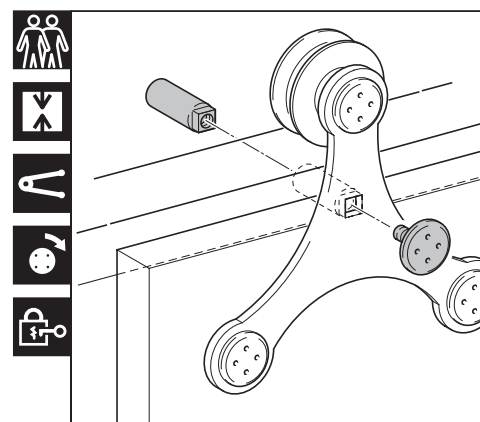

Fig. 20

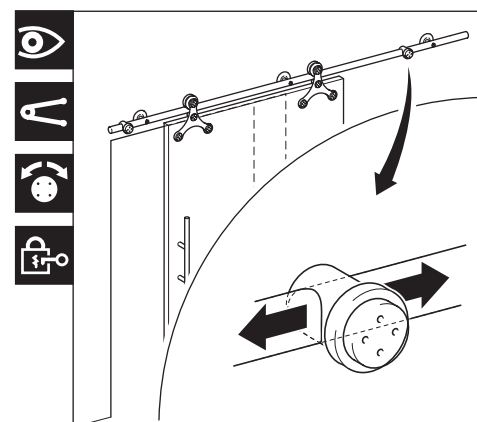

Fig. 21

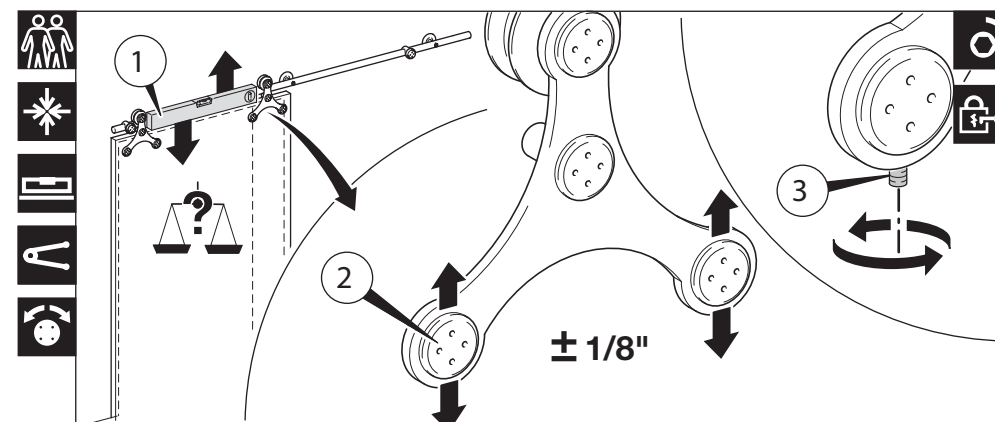

Fig. 22

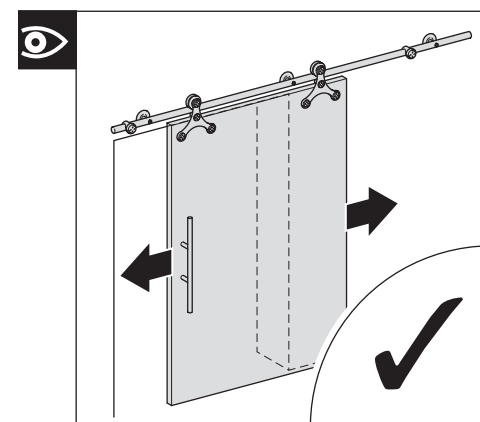
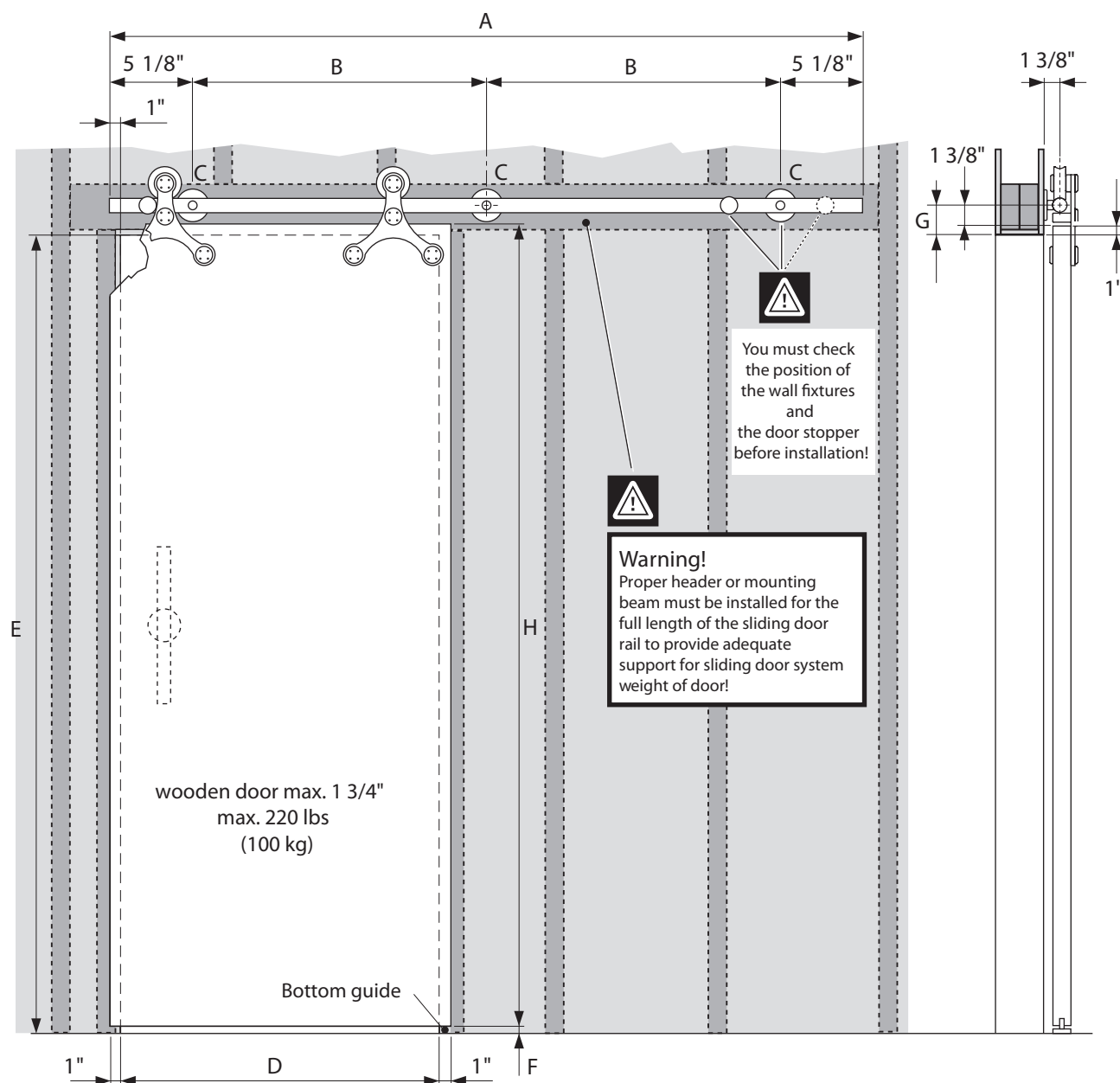

Fig. 23

Planning guide

Sliding door fittings Tritec

for wooden doors (max. 1 3/4" thickness)



Complete-sets

Set Tritec Art. No.	A inch	B inch	C Each	D inch	E max. inch	F inch	G inch	H max. inch (H = E - F + 1")
USU65-1800EF	70 7/8"	30 5/16"	3	29 1/2" - 35 7/16"	98 7/16"	1/4" - 3/8"	2 3/8"	99 1/8"
USU65-2100EF	82 11/16"	24 1/8"	4	35 13/16" - 39 3/8"	98 7/16"	1/4" - 3/8"	2 3/8"	99 1/8"
USU65-2300EF	90 9/16"	26 3/4"	4	39 3/4" - 44 1/16"	98 7/16"	1/4" - 3/8"	2 3/8"	99 1/8"
USU65-2540EF	100"	29 15/16"	4	44 1/2" - 49 3/16"	98 7/16"	1/4" - 3/8"	2 3/8"	99 1/8"

Sliding door fittings Tritec

for wooden doors (max. 1 3/4" thickness) - 1 wooden door

inches		Each	Manufacturing dimensions (special model)						kg	Each		
A	B	C	D	D1	E	F	G	H	Load-bearing capacity of the guide rail J	L	M	N
					max. 98 7/16"	1/4" - 3/8"	(2 3/8")	max. 99 1/8" (H = E - F + Y)		1	2	2

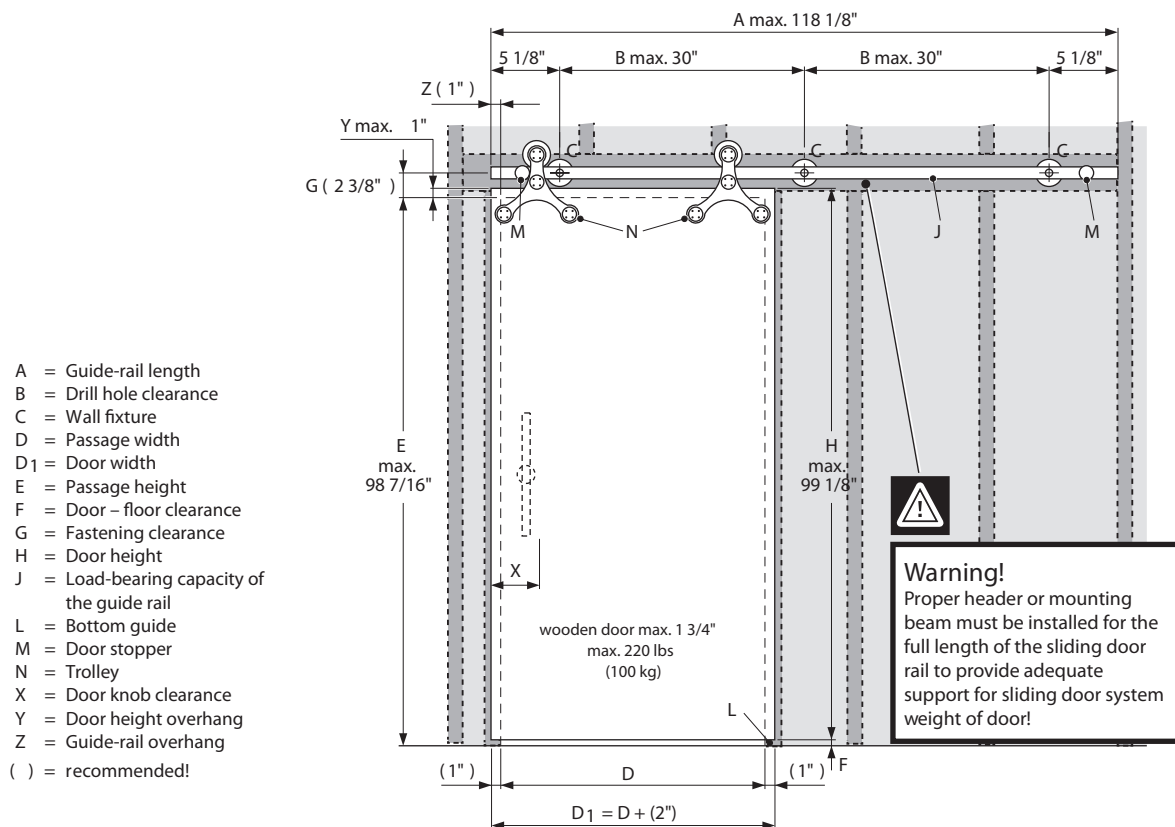

Calculation for guide-rail length A for 1 door

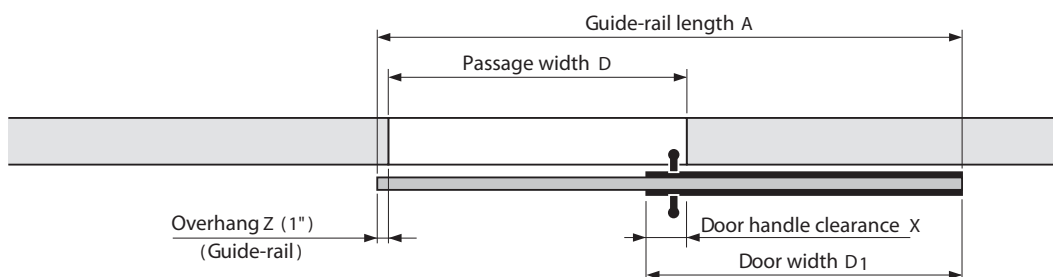

$$\text{Overhang Z} + \text{Passage width D} + \text{Door width D1} - \text{Door handle clearance X} = \text{Guide-rail length A}$$



Make door handle clearance so that fingers do not get pinched when the door is manipulated! See page 5.

Sliding door fittings Tritec

for wooden doors (max. 1 3/4" thickness) - 2 wooden doors

Manufacturing dimensions (special model)															
inches			Each	inches					H	kg	Each				
A	B1	B2	C	D	D1	D2	E max. 98 7/16"	F 1/4" - 3/8"	G	max. 99 1/8" (H = E - F + Y)	Load-bearing capacity of the guide rail J	K	L	M	N
									(2 3/8")			1	2	4	4

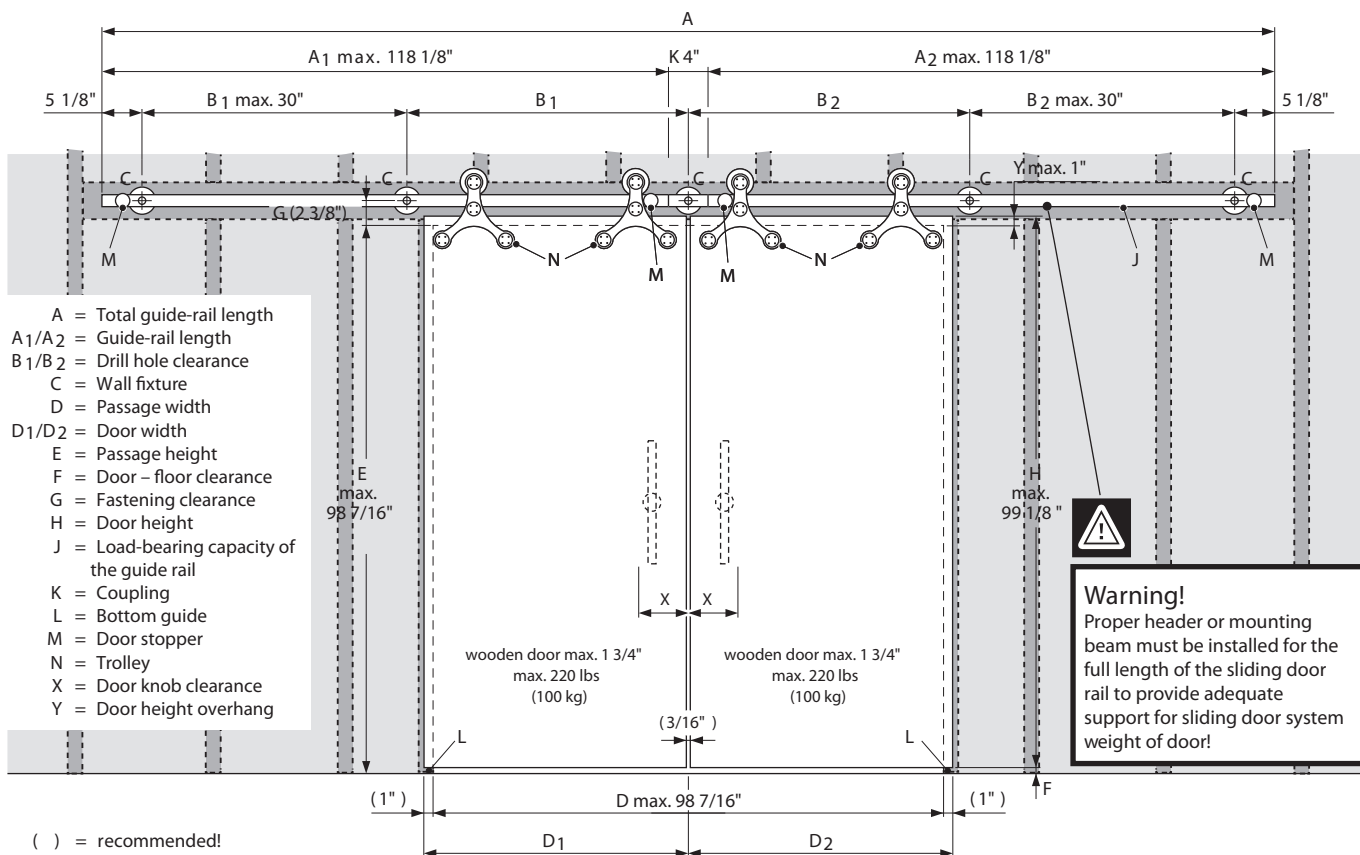

Calculation for total guide-rail length A for 2 doors

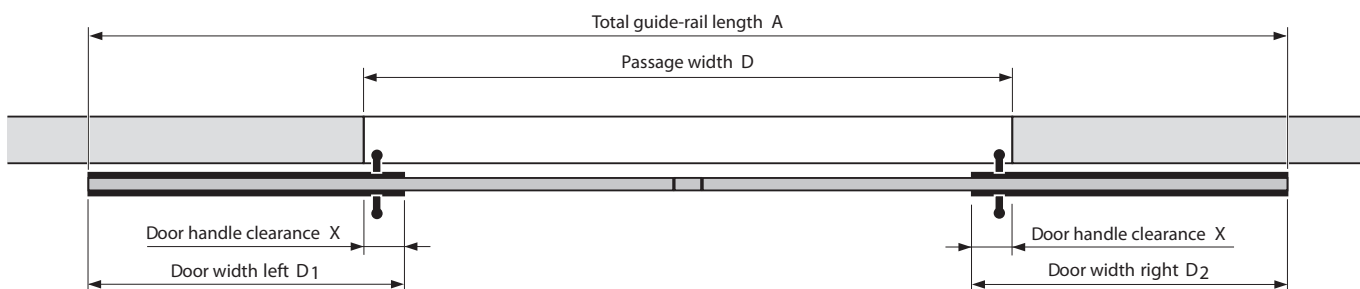

Door width D1 - Door handle clearance X + Passage width D + Door width D2 - Door handle clearance X = Total guide-rail length A



Make door handle clearance so that fingers do not get pinched when the door is manipulated! See page 5.

Sliding door fittings Tritec

for wooden doors (max. 1 3/4" thickness) – Wall fixture

Standard installation

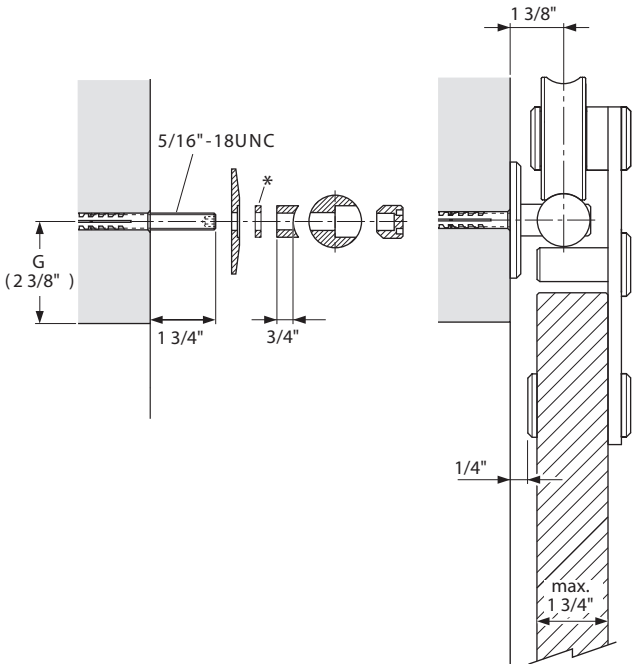

* Compensation disks 1/16", 3/16" and 3/8"
To compensate for wall unevenness,
order separately.
(Only 1 piece per wall fixture!)

	Art.-No.	inches
	USO216-2EF	1/16"
	USO216-5EF	3/16"
	USO216-10EF	3/8"

Installation with baseboards and trim

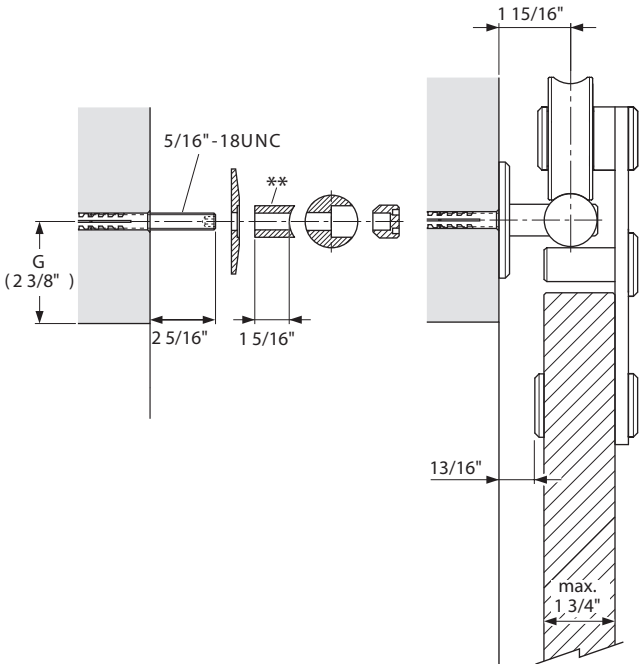

** Spacers order separately.

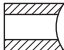
	Art.-No.	inches
	USO226-19EF	3/4"

Sliding door fittings Tritec

for wooden doors (max. 1 3/4" thickness)

Preparation of wooden door

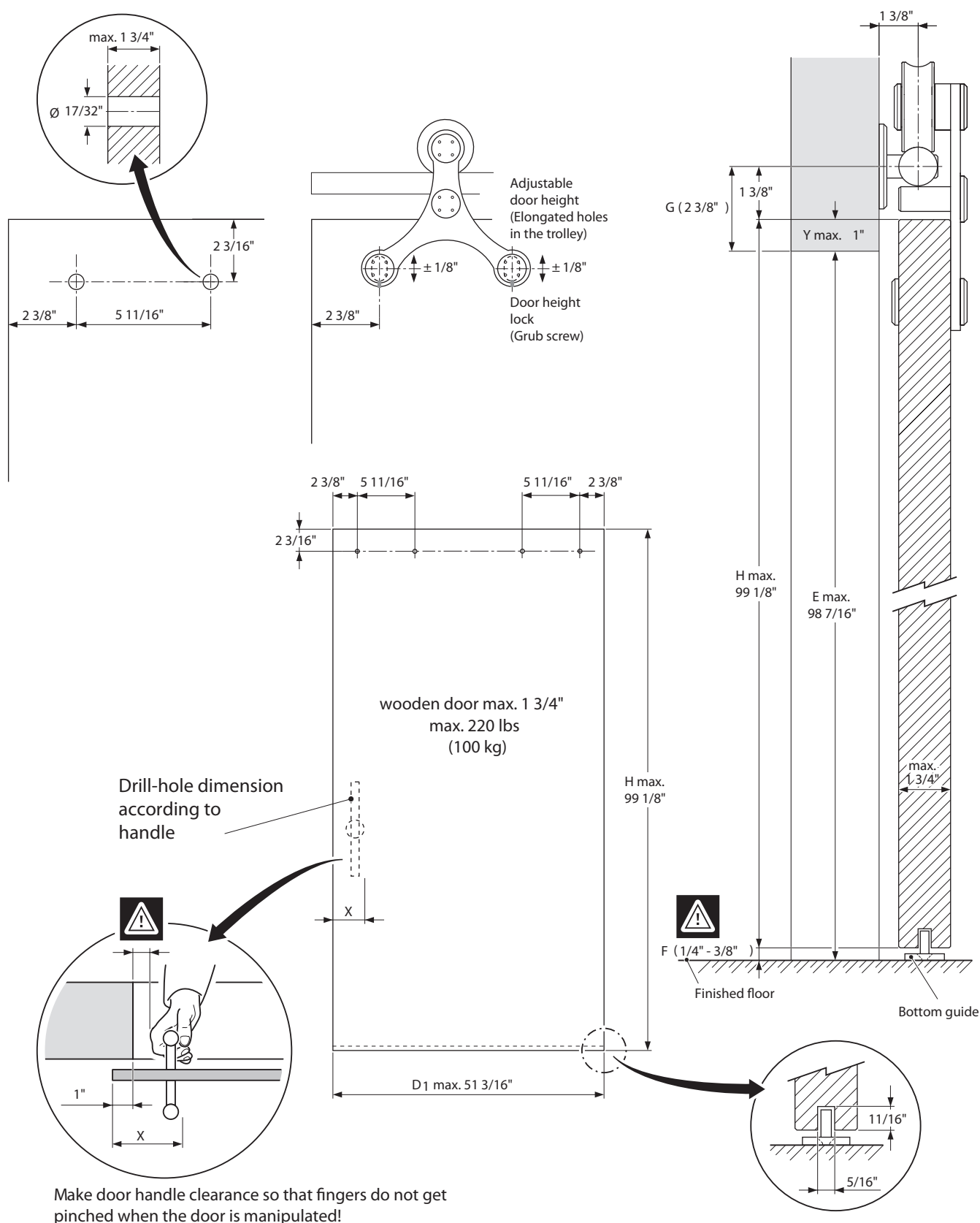

Sliding door fittings Tritec

for wooden doors (max. 1 3/4" thickness)

Required system parts

Please refer to the catalogue for article no's and models!

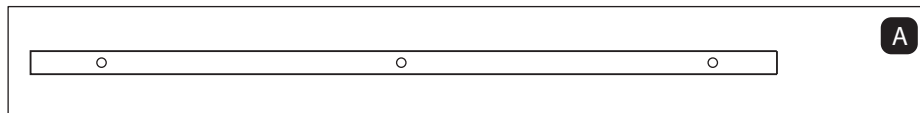

Guide rail Ø 1" inch

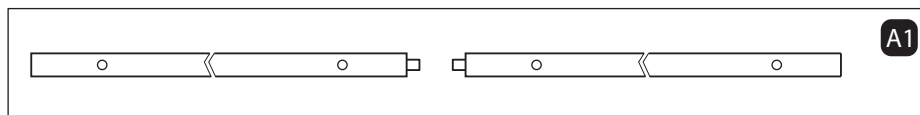

Guide rail Ø 1" inch
for guide rail couplings

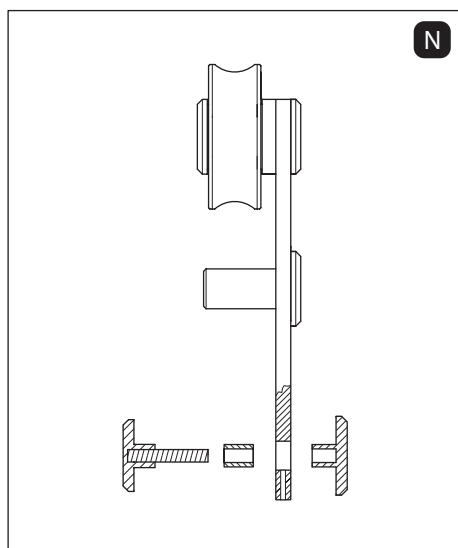

Trolley complete

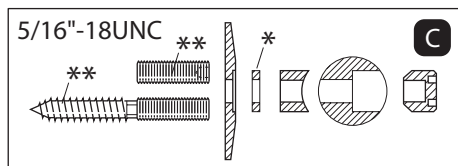

Wall fixtures complete

** Without screws and dowels, at construction site
* Compensation disks 1/16", 3/16" and 3/8" order separately

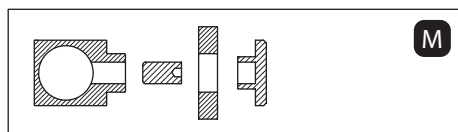

Door stoppers complete, stainless steel

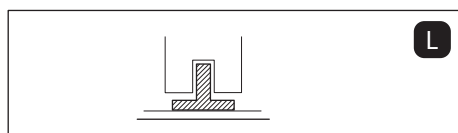

Bottom guide, plastic
(Without screws and dowels, at construction site)

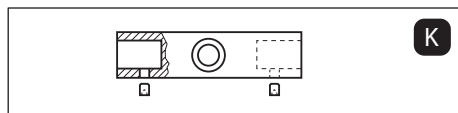

Guide rail coupling Ø 1" inch

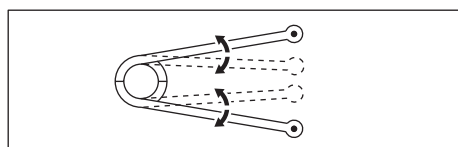

Special tool