

1 Set sliding door fittings Tritec

2 Guide rail

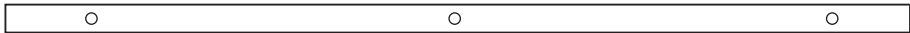

3 Door stoppers

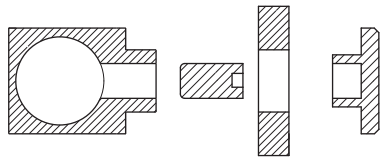

5 Wall fixtures

5/16"-18UNC

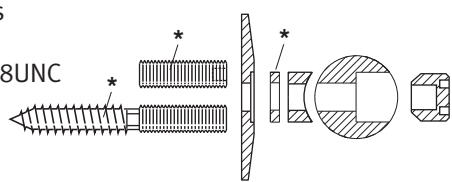

(without screws and dowels, at construction site)
* not included in scope of delivery.

6 Special tool

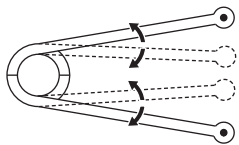

7 Bottom guide

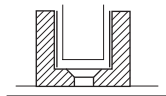

(without dowels and screws, at construction site)

4 Trolley complete

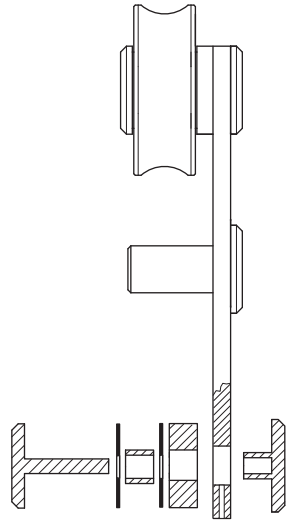

Comply with all general safety regulations when installing the sliding door fittings!

Installation to be completed by qualified licensed contractor.

Be sure to tighten all screw connections one week after starting to use the sliding door fittings!

Never use scouring agents to clean the sliding door fittings; rather use commercially available stainless-steel cleaners!



Attention



Screw on



Screw on



Screw on



Loosen / Tighten



Install



At right angle



Drill



Dowels



Adjust Set



Level



Perpendicular



Measure Mark



Visual inspection



Special-tool



2 people required



Measure



Clarify questions



See instructions



Secure

Installation instructions

Sliding door fittings Tritec

for glass doors (5/16" - 1/2" thickness)

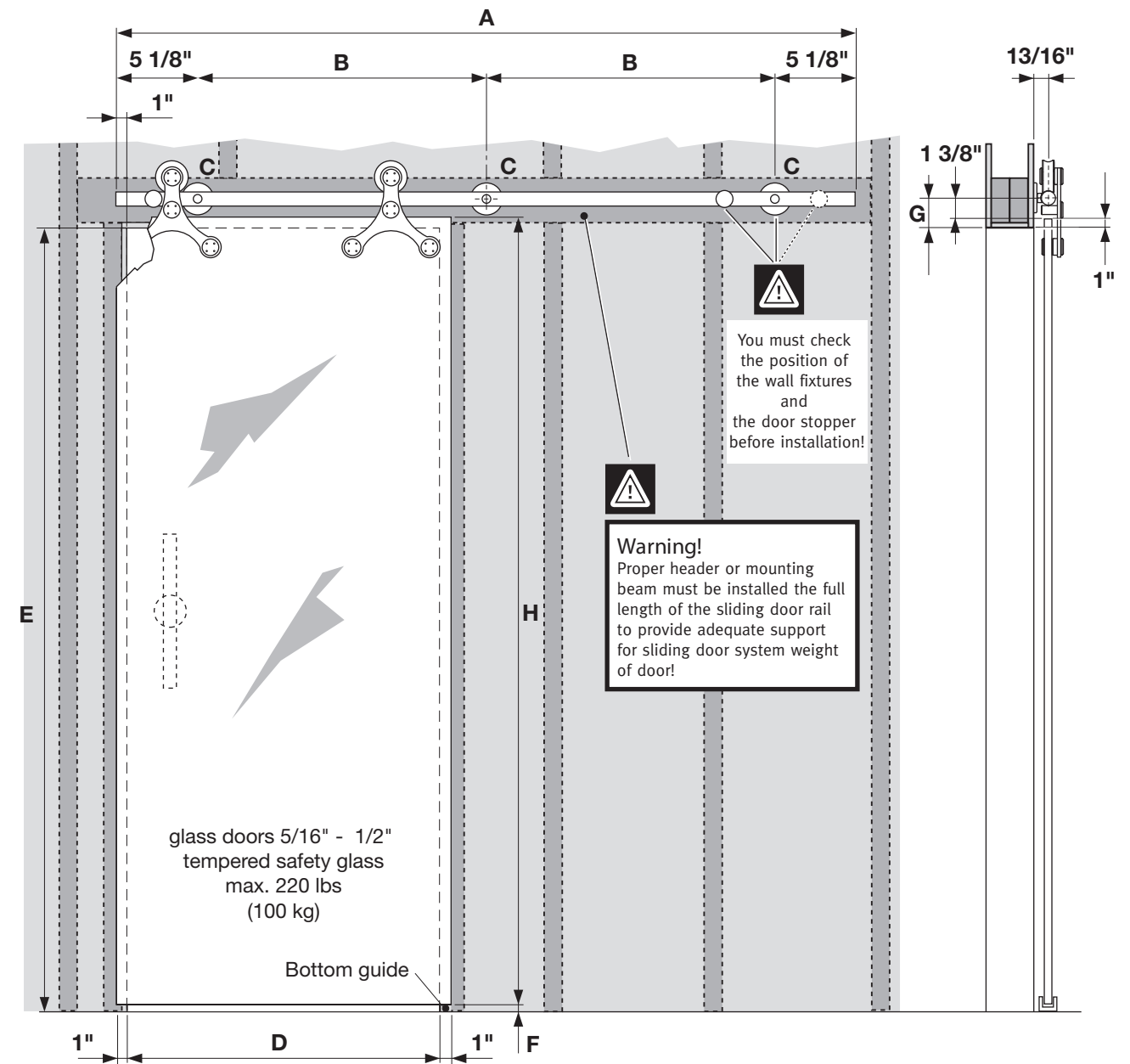

Complete-sets

Set Tritec Art. No.	A inch	B inch	C Each	D inch	E max. inch	F inch	G inch	H max. inch (H = E - F + 1")
USU64-1800EF	70 7/8"	30 5/16"	3	29 1/2" - 35 7/16"	98 7/16"	1/4" - 3/8"	2 3/8"	99 1/8"
USU64-2100EF	82 11/16"	24 1/8"	4	35 13/16" - 39 3/8"	98 7/16"	1/4" - 3/8"	2 3/8"	99 1/8"
USU64-2300EF	90 9/16"	26 3/4"	4	39 3/4" - 44 1/16"	98 7/16"	1/4" - 3/8"	2 3/8"	99 1/8"
USU64-2540EF	100"	29 15/16"	4	44 1/2" - 49 3/16"	98 7/16"	1/4" - 3/8"	2 3/8"	99 1/8"

Right to make technical changes reserved - Dimensions in inches - Version 02.2012
© by ABP-Beyerle GmbH

ABP  beyerle

ABP  beyerle

Beyerle US L.L.C.
1294 Logan Circle NW, Atlanta, GA 30318
Phone (404) 350-9738, Fax (404) 355-0166, www.beyerle-us.com

USU64_Mont_US

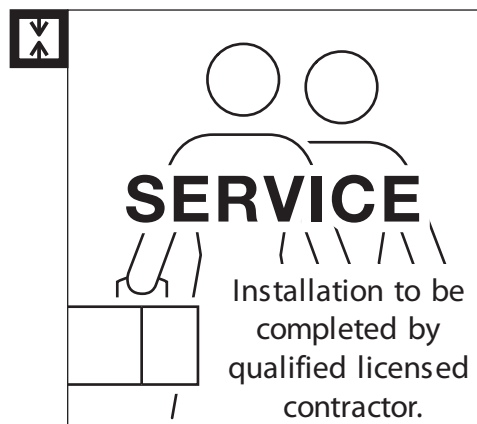

Fig. 1

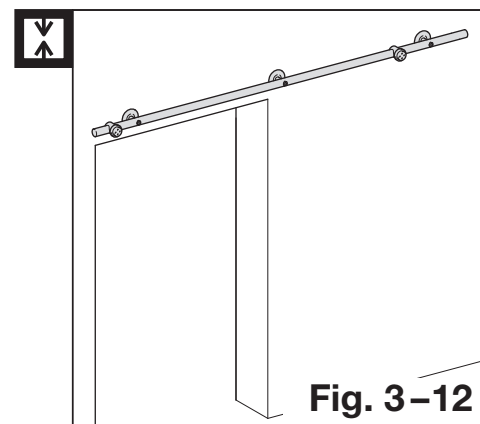

Fig. 2

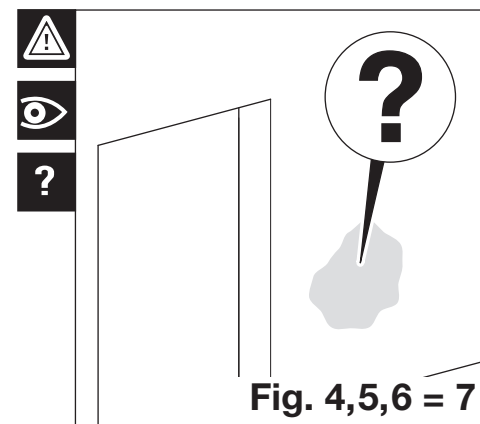

Fig. 3

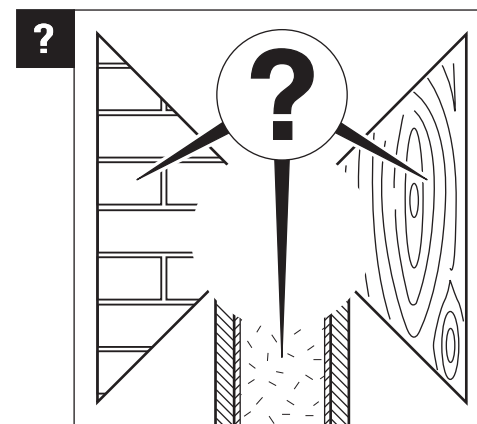

Fig. 4

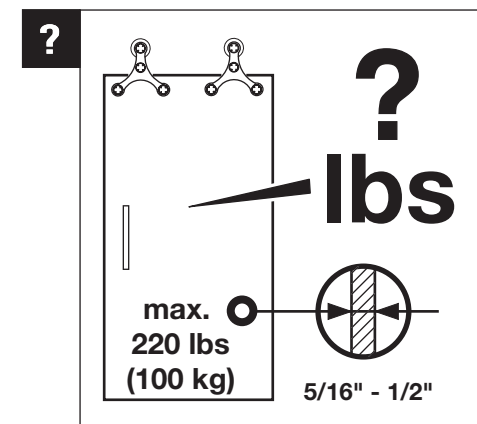

Fig. 5

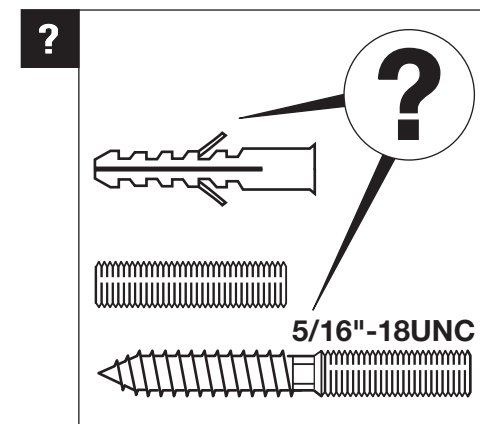

Fig. 6

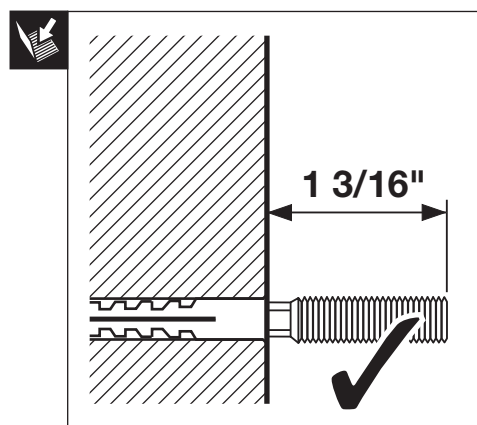

Fig. 7

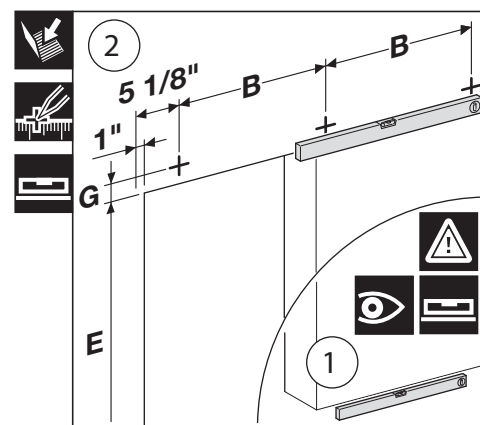

Fig. 8

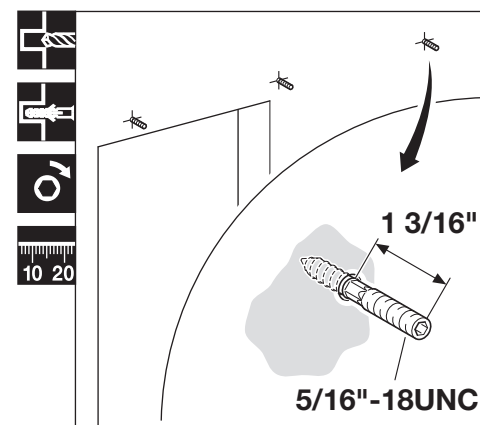

Fig. 9

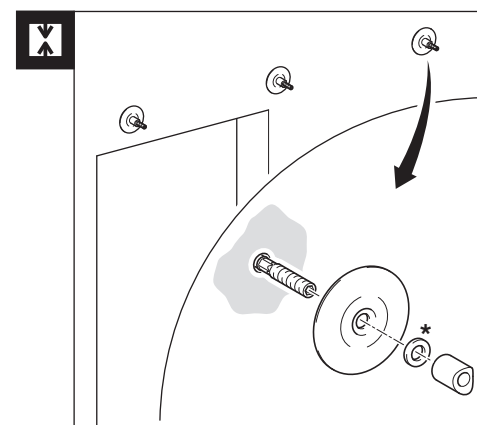

Fig. 10

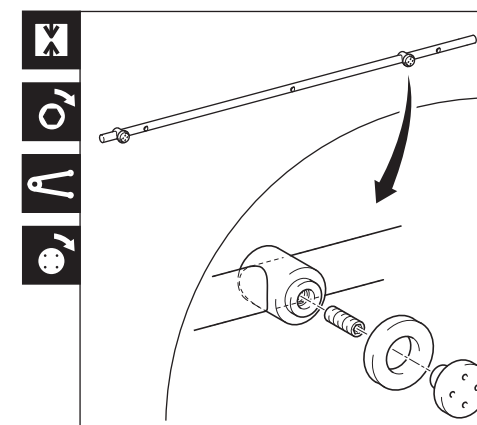

Fig. 11

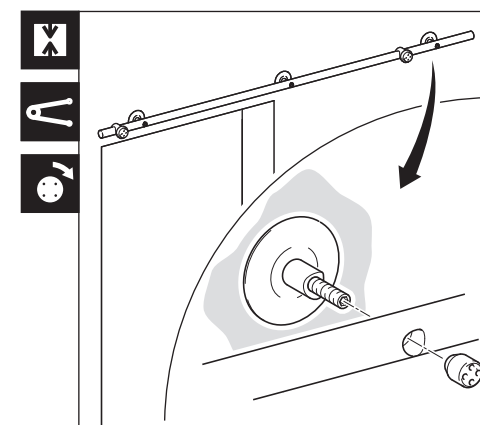

Fig. 12

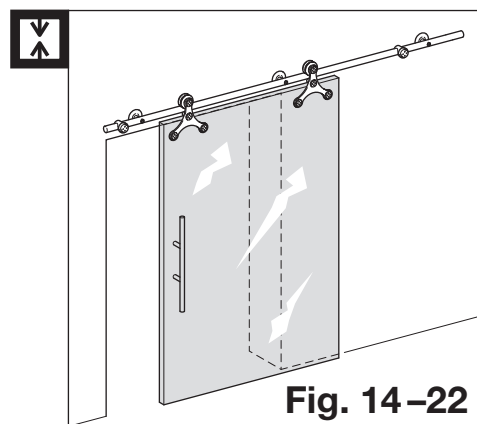

Fig. 13

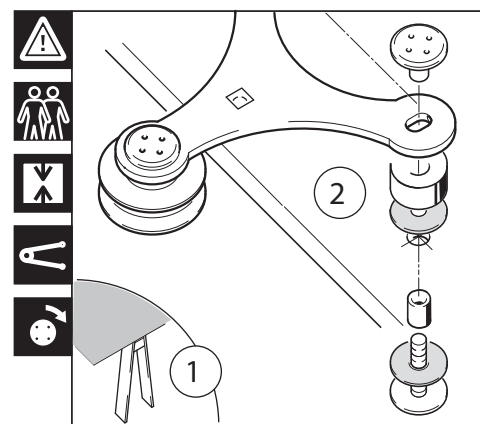

Fig. 14

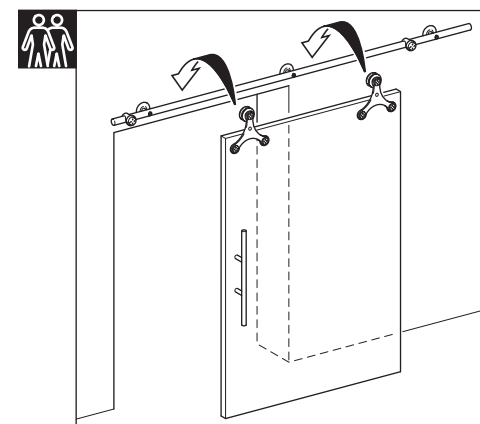

Fig. 15

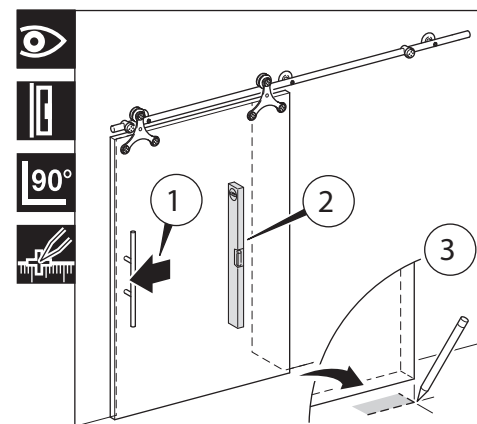

Fig. 16

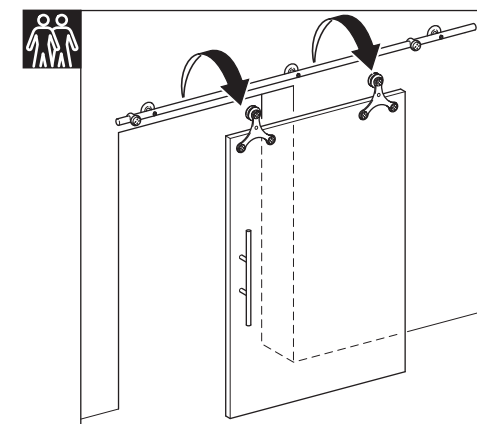

Fig. 17

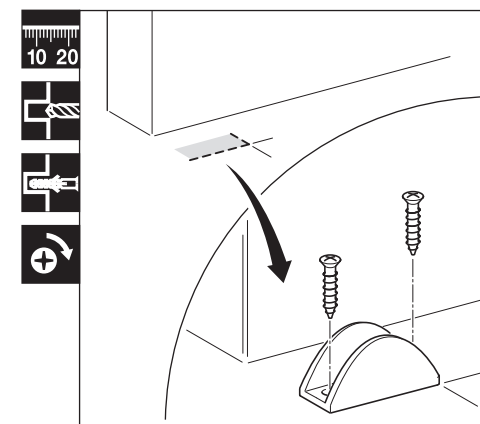

Fig. 18

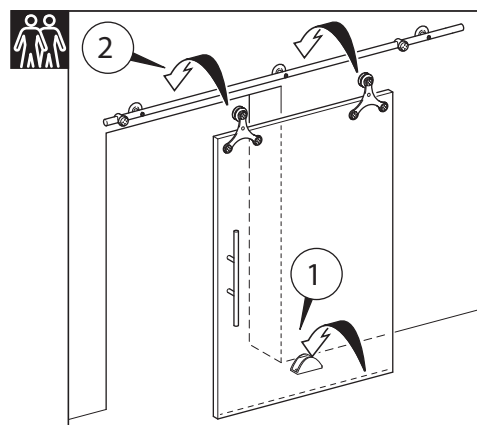

Fig. 19

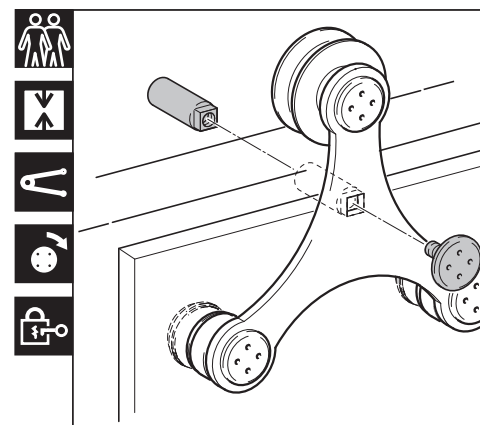

Fig. 20

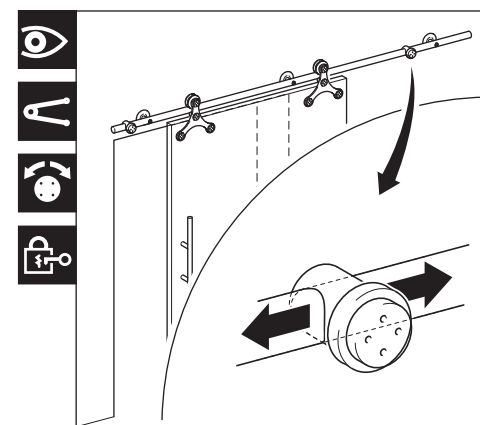

Fig. 21

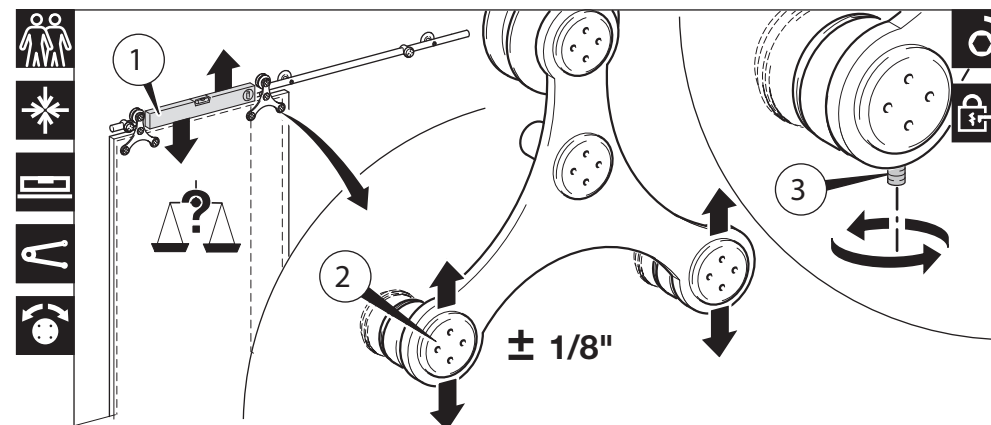

Fig. 22

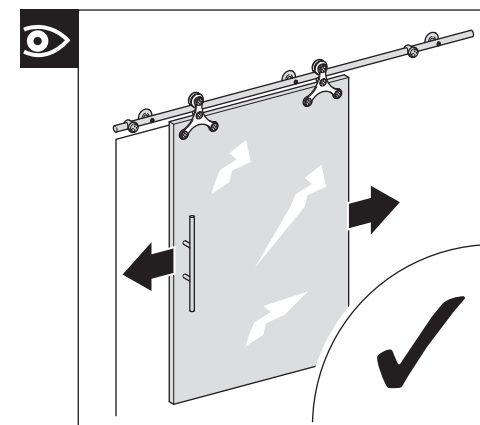
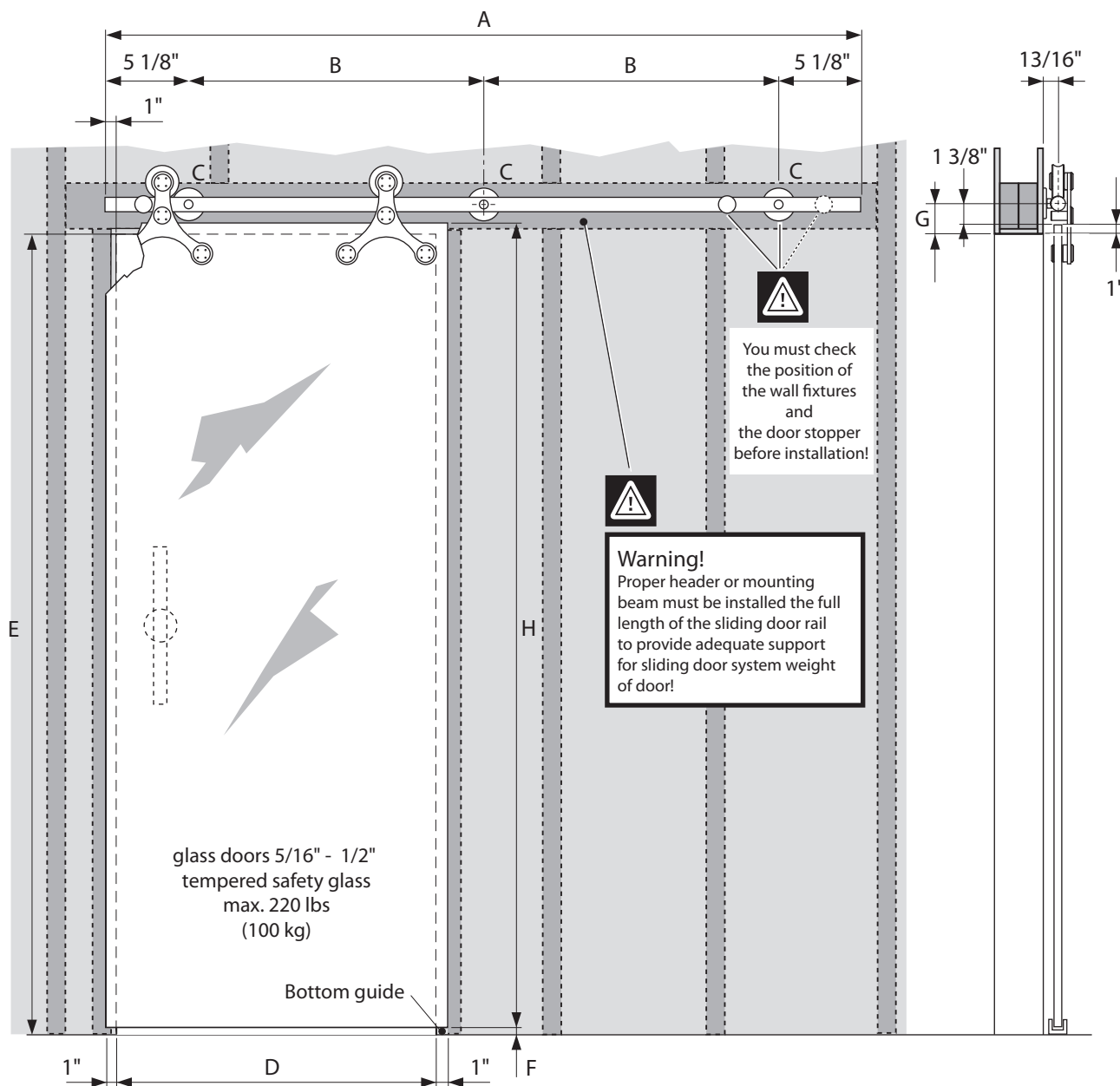

Fig. 23

Planning guide

Sliding door fittings Tritec

for glass doors (5/16" - 1/2" thickness)



Complete-sets

Set Tritec Art. No.	A inch	B inch	C Each	D inch	E max. inch	F inch	G inch	H max. inch (H=E - F + 1")
USU64-1800EF	70 7/8"	30 5/16"	3	29 1/2" - 35 7/16"	98 7/16"	1/4" - 3/8"	2 3/8"	99 1/8"
USU64-2100EF	82 11/16"	24 1/8"	4	35 13/16" - 39 3/8"	98 7/16"	1/4" - 3/8"	2 3/8"	99 1/8"
USU64-2300EF	90 9/16"	26 3/4"	4	39 3/4" - 44 1/16"	98 7/16"	1/4" - 3/8"	2 3/8"	99 1/8"
USU64-2540EF	100"	29 15/16"	4	44 1/2" - 49 3/16"	98 7/16"	1/4" - 3/8"	2 3/8"	99 1/8"

Sliding door fittings Tritec

for glas doors (5/16"- 1/2" thickness) - 1 glas door

inches			Manufacturing dimensions (special model)						kg	Each		
A	B	C	D	D1	E max. 98 7/16"	F 1/4" - 3/8"	G	H max. 99 1/8" (H=E-F+Y)	Load-bearing capacity of the guide rail J	L	M	N
							(2 3/8")			1	2	2

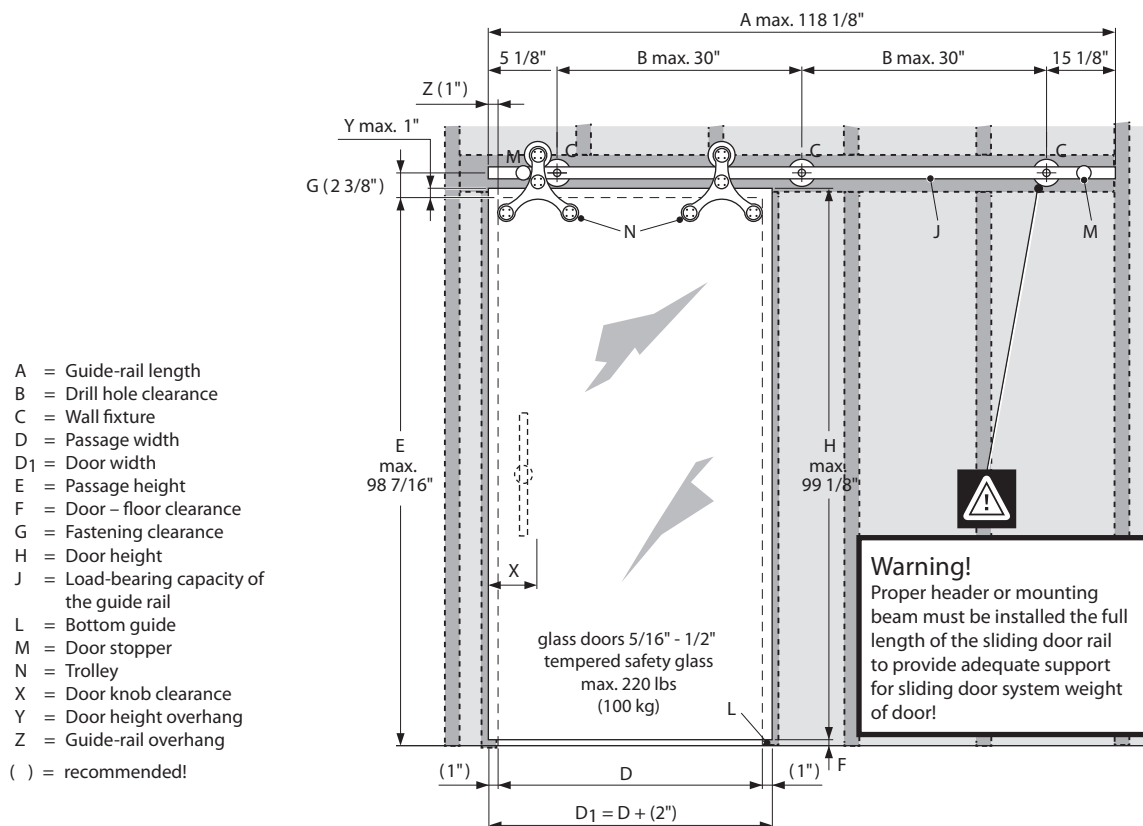

Calculation for guide-rail length A

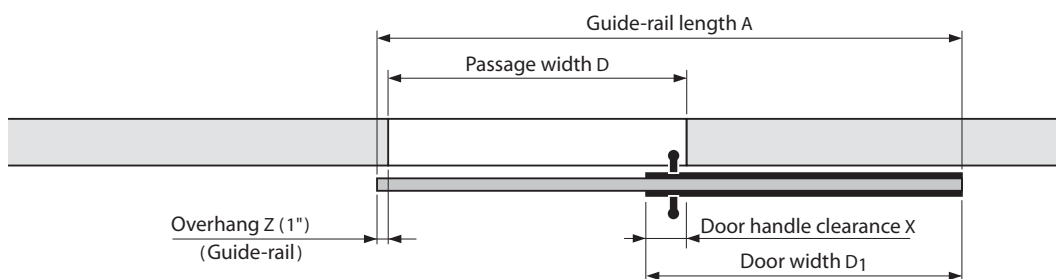

Make door handle clearance so that fingers do not get pinched when the door is manipulated! See page 5.

Sliding door fittings Tritec

for glas doors (5/16"- 1/2" thickness) - 2 glas doors

Manufacturing dimensions (special model)															
inches			Each	inches						H	kg	Each			
A	B1	B2	C	D	D1	D2	E max. 98 7/16"	F 1/4" - 3/8"	G	(H=E-F+Y) max. 99 1/8"	Load-bearing capacity of the guide rail J	K	L	M	N
									(2 3/8")			1	2	4	4

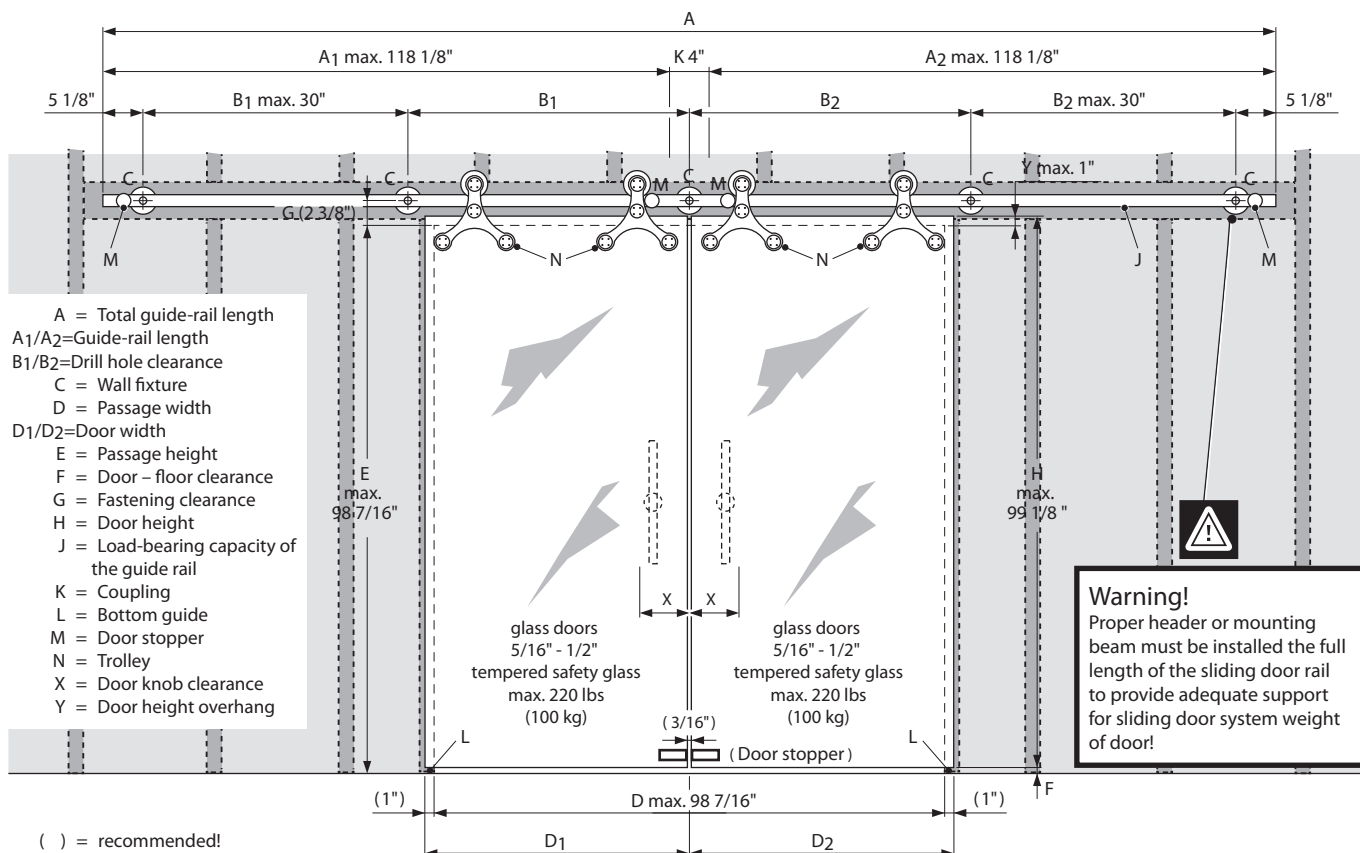

Calculation for total guide-rail length A

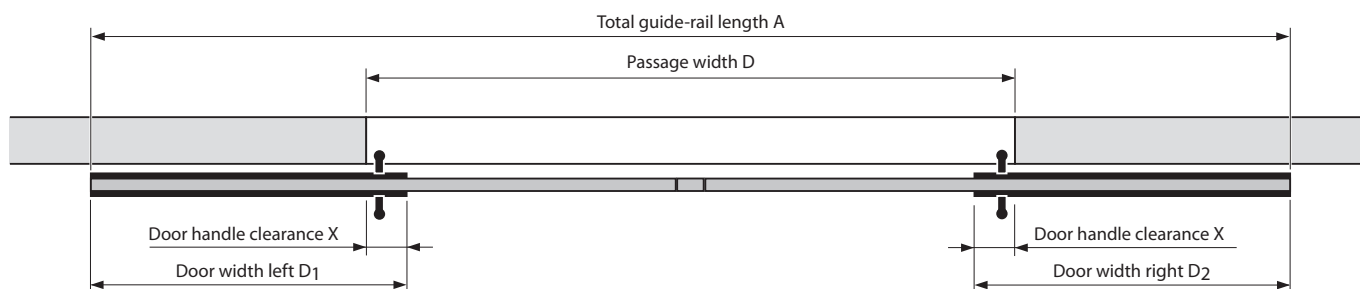

Door width D1 - Door handle clearance X + Passage width D + Door width D2 - Door handle clearance X = Total guide-rail length A



Make door handle clearance so that fingers do not get pinched when the door is manipulated! See page 5.

Sliding door fittings Tritec

for glas doors (5/16"- 1/2" thickness) - Wall fixture

Standard installation

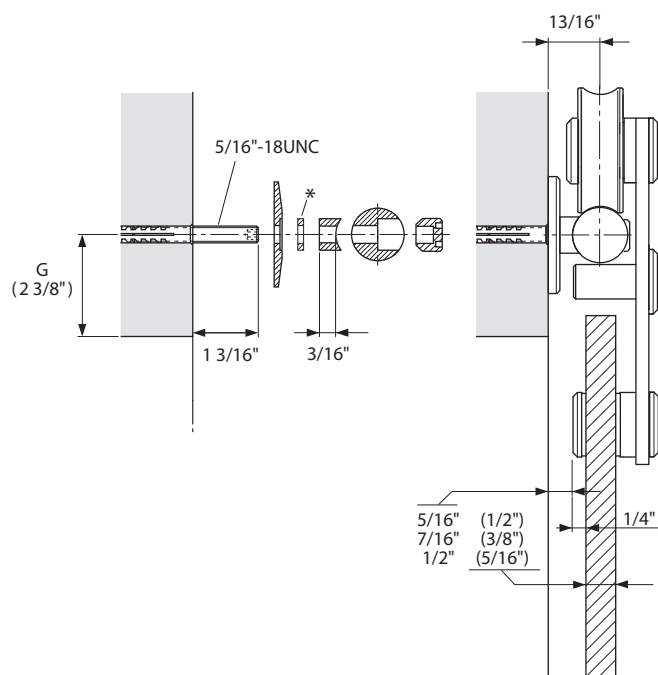

* Compensation disks 1/16", 3/16" and 3/8"
To compensate for wall unevenness,
order separately.
(Only 1 piece per wall fixture!)

	Art.-No.	inches
	USO216-2EF	1/16"
	USO216-5EF	3/16"
	USO216-10EF	3/8"

Installation with baseboards and trim

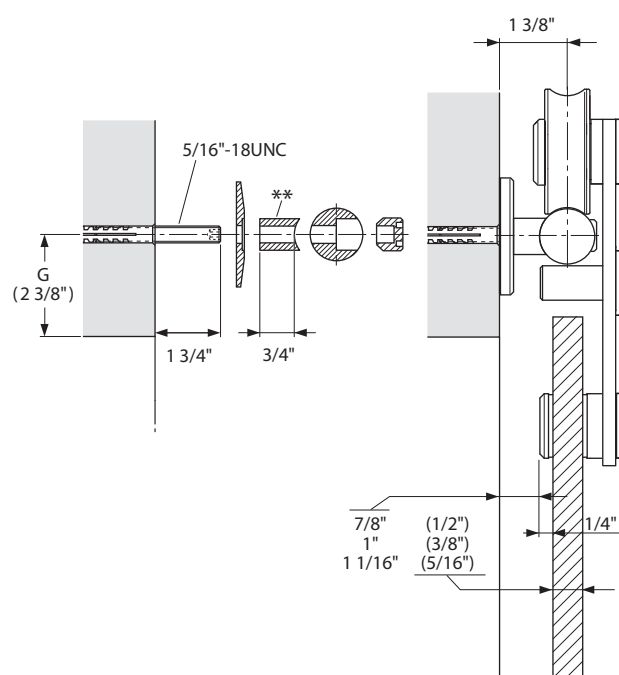

** Spacers order separately.

	Art.-No.	inches
	USO226-33EF	3/4"

Sliding door fittings Tritec

for glass doors (5/16"- 1/2" thickness)

Preparation of glass door

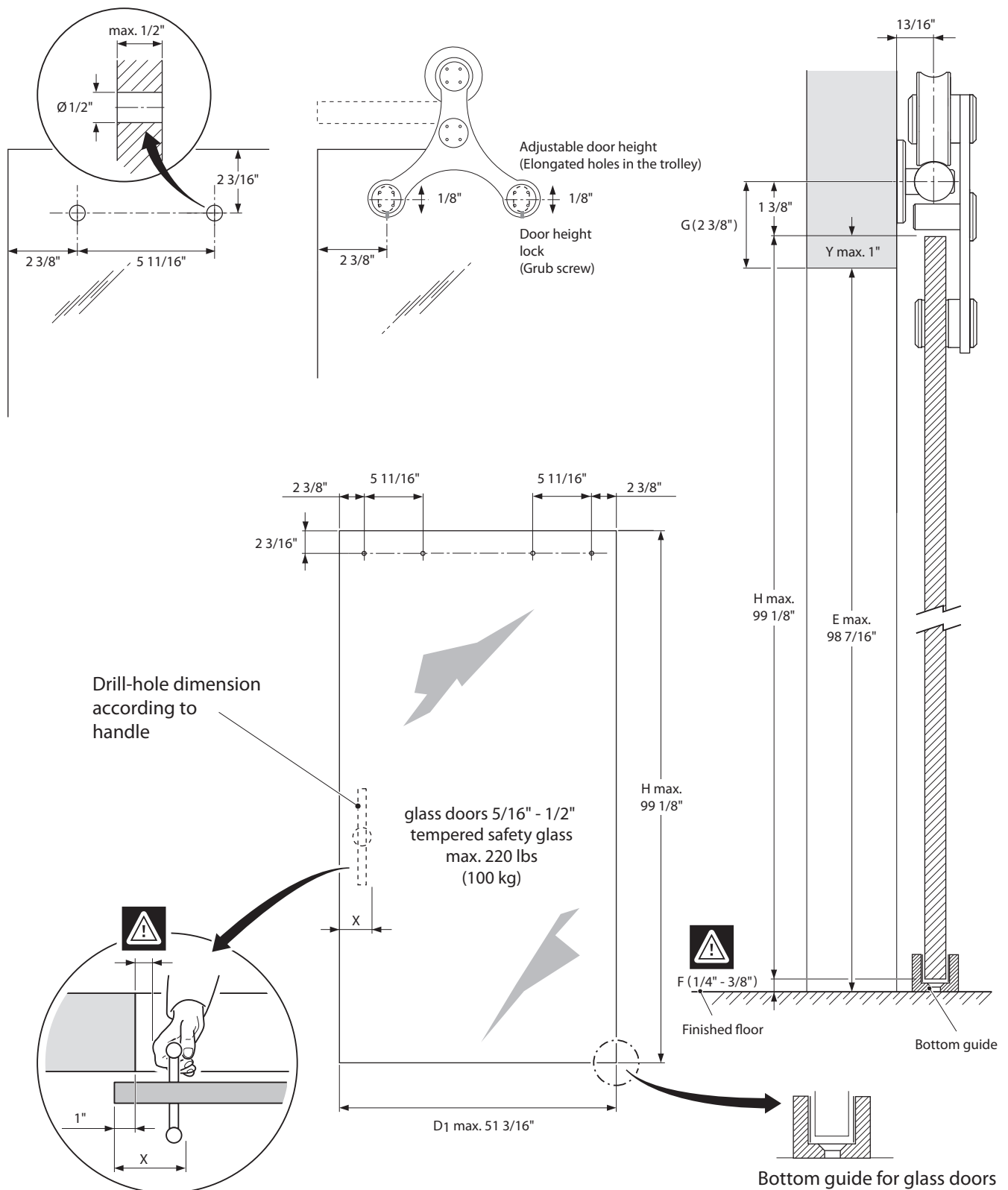

Make door handle clearance so that fingers do not get pinched when the door is manipulated!

Sliding door fittings Tritec

for glas doors (5/16" - 1/2" thickness)

Required system parts

Please refer to the catalogue for article no's and models!

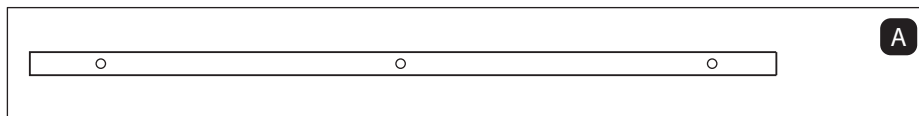

A

Guide rail Ø 1" inch

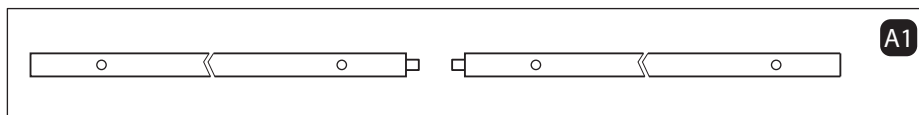

A1

Guide rail Ø 1" inch
for guide rail couplings

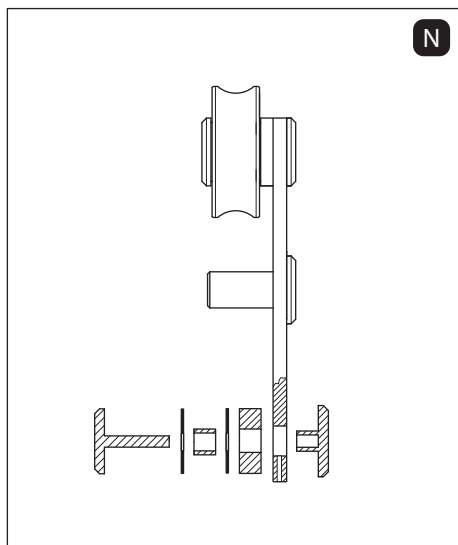

N

Trolley complete
including glass protection set

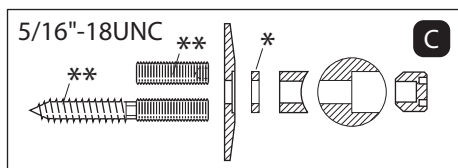

C

Wall fixtures complete

**Without screws and dowels, at construction site

*Compensation disks 1/16", 3/16" and 3/8" order separately

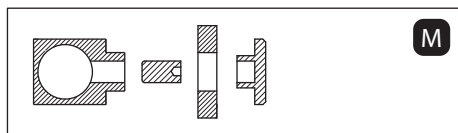

M

Door stoppers complete, stainless steel

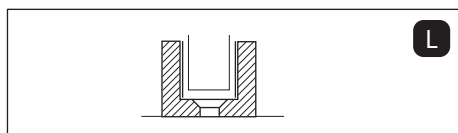

L

Bottom guide, stainless steel, for glass door 5/16" - 1/2"
(Without screws and dowels, at construction site)

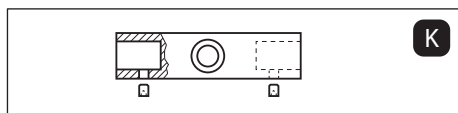

K

Guide rail coupling Ø 1" inch

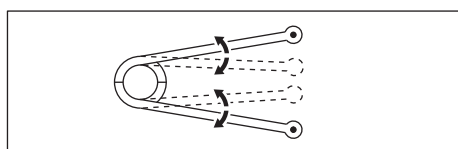

Special tool