

FOLDING RING PULL (SPRING LOADED)



980641, 980642



980642



980641

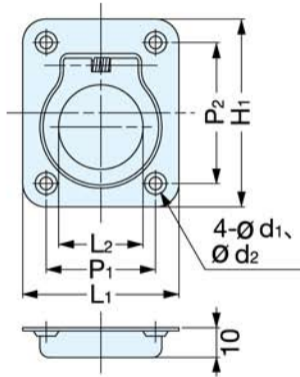

- The pull is recessed into the mounting plate keeping it flush with the mounting surface.
- Low profile design.
- Spring loaded-snaps flat to stay out of the way when not in use.
- Ideal for vibration or shock applications.

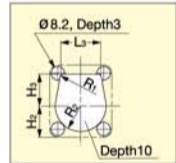

Material	Finish
304 Stainless Steel	Polished

Item No.	L_1	L_2	L_3	H_1	H_2	H_3	R_1	$\emptyset R_2$	P_1	P_2	d_1	d_2	Weight(g)	Box (pcs)	Carton (pcs)
980641	38	18	24.5	44	19	19.5	14.2	31	28 (1-7/64")	34 (1-11/32")	3.6	6.2	21	10	500
980642	50	27	25	60	25	25	19.5	41	35 (1-3/8")	45 (1-25/32")	4	7	36		200